

View showing the structure of the photovoltaic panels sitting on the walkway.

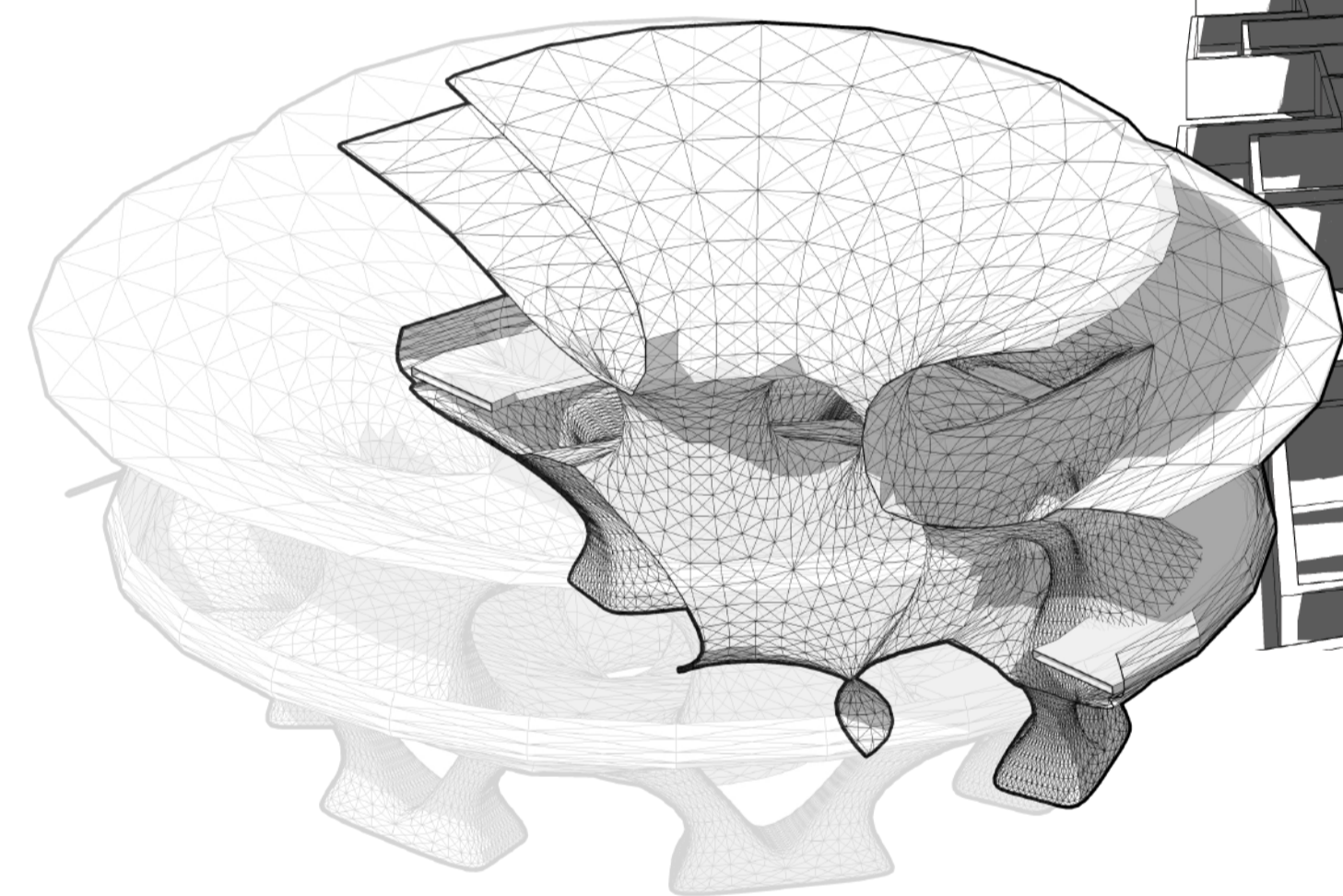

Cutaway of main pavilion structure

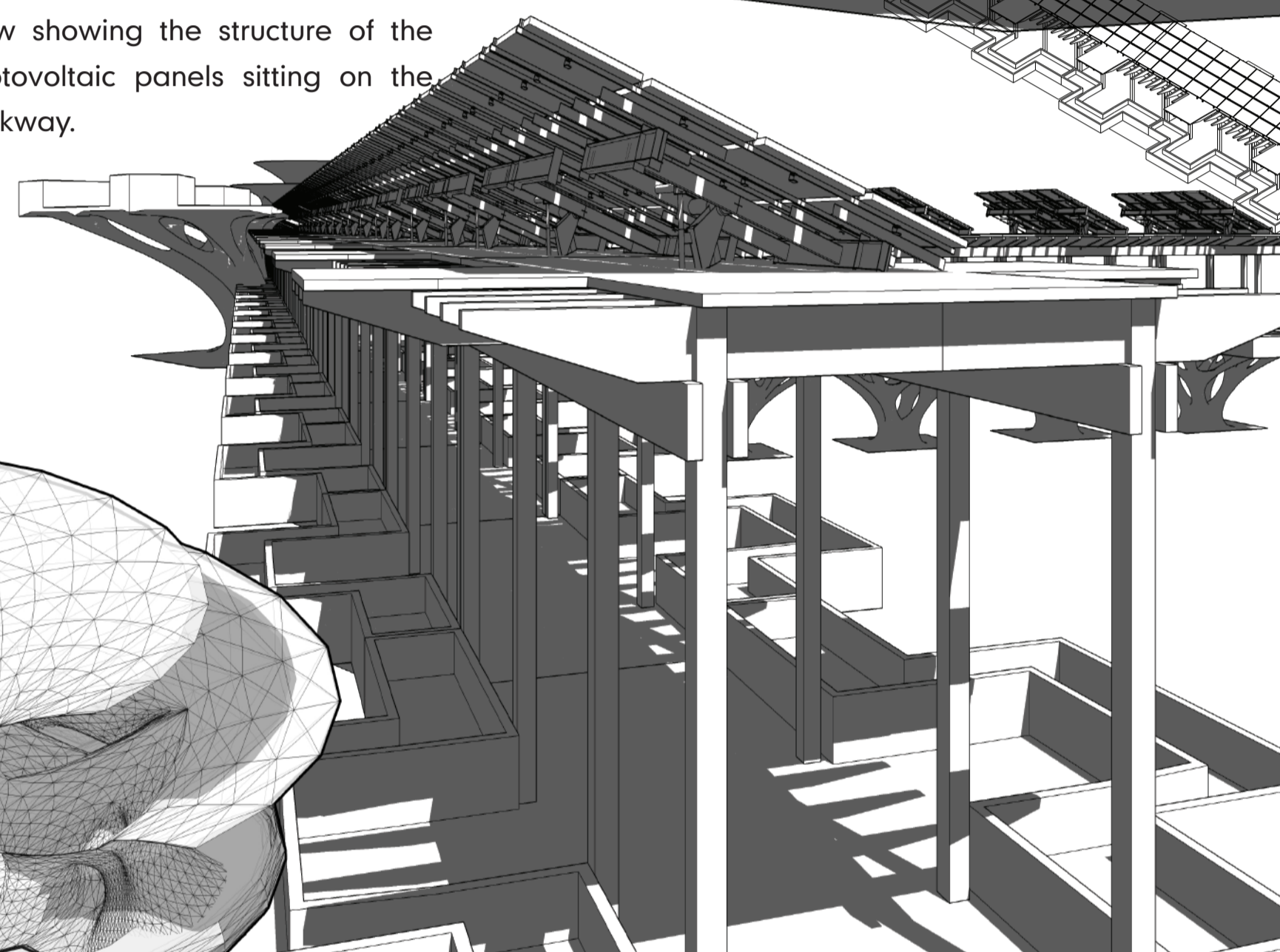
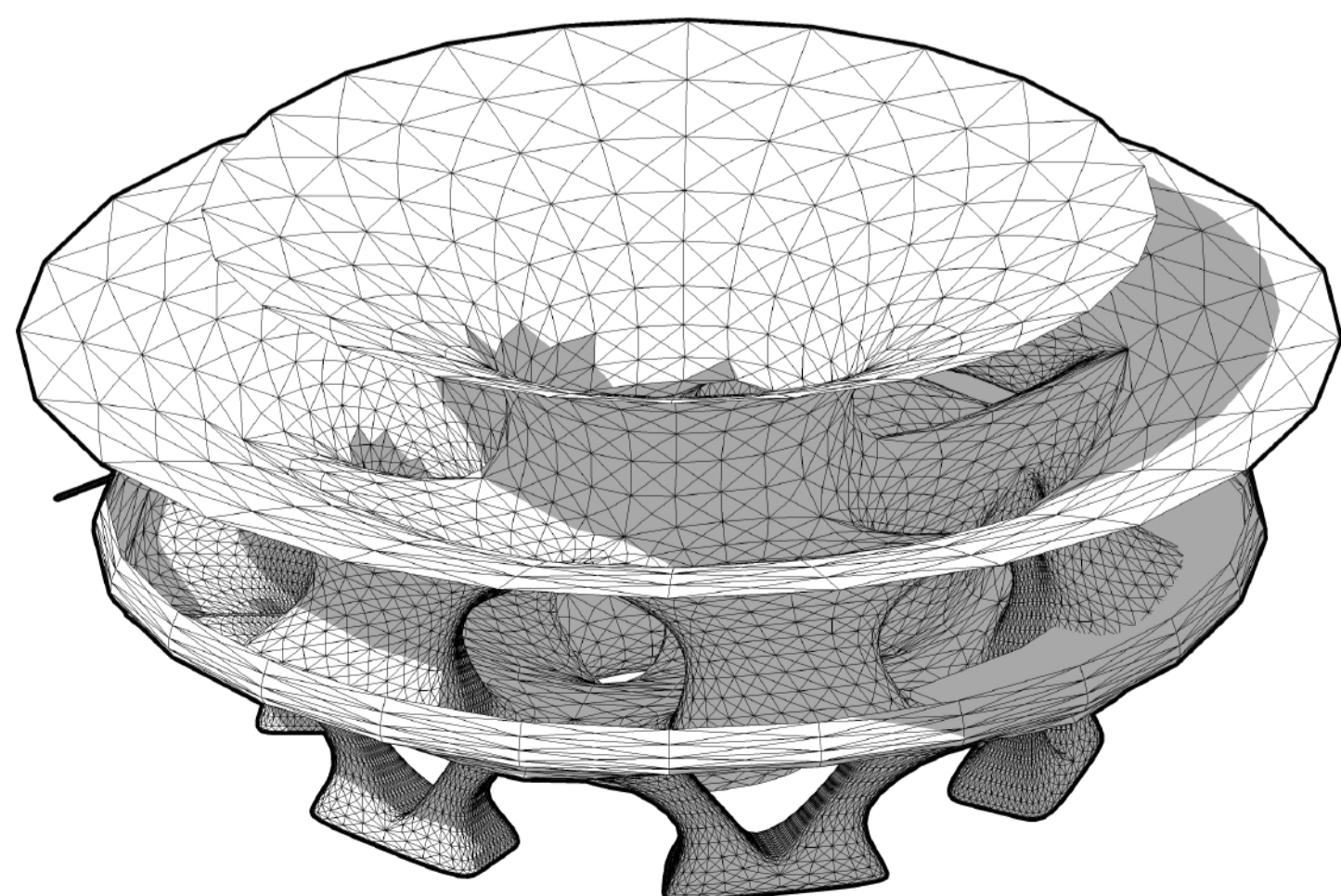

Main pavilion structure

The design also contains two viewing platforms which run alongside the walkway – these are larger 3D printed structures and the main walkway runs through them.

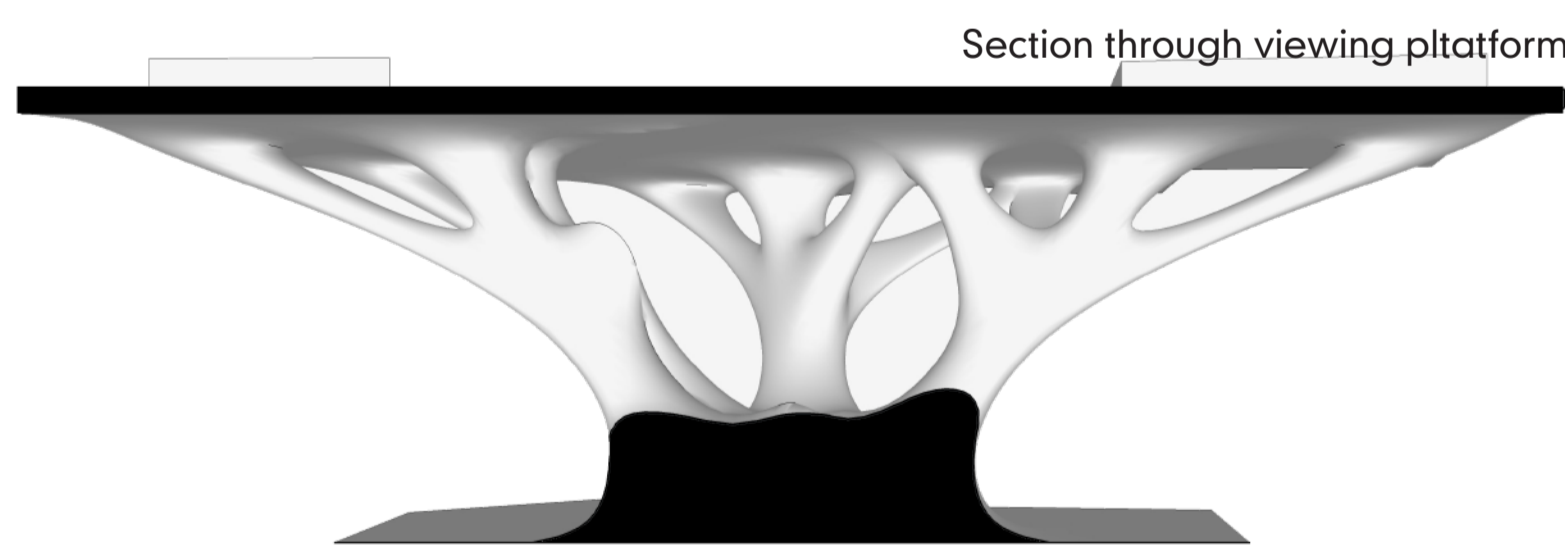

Section through viewing platform.

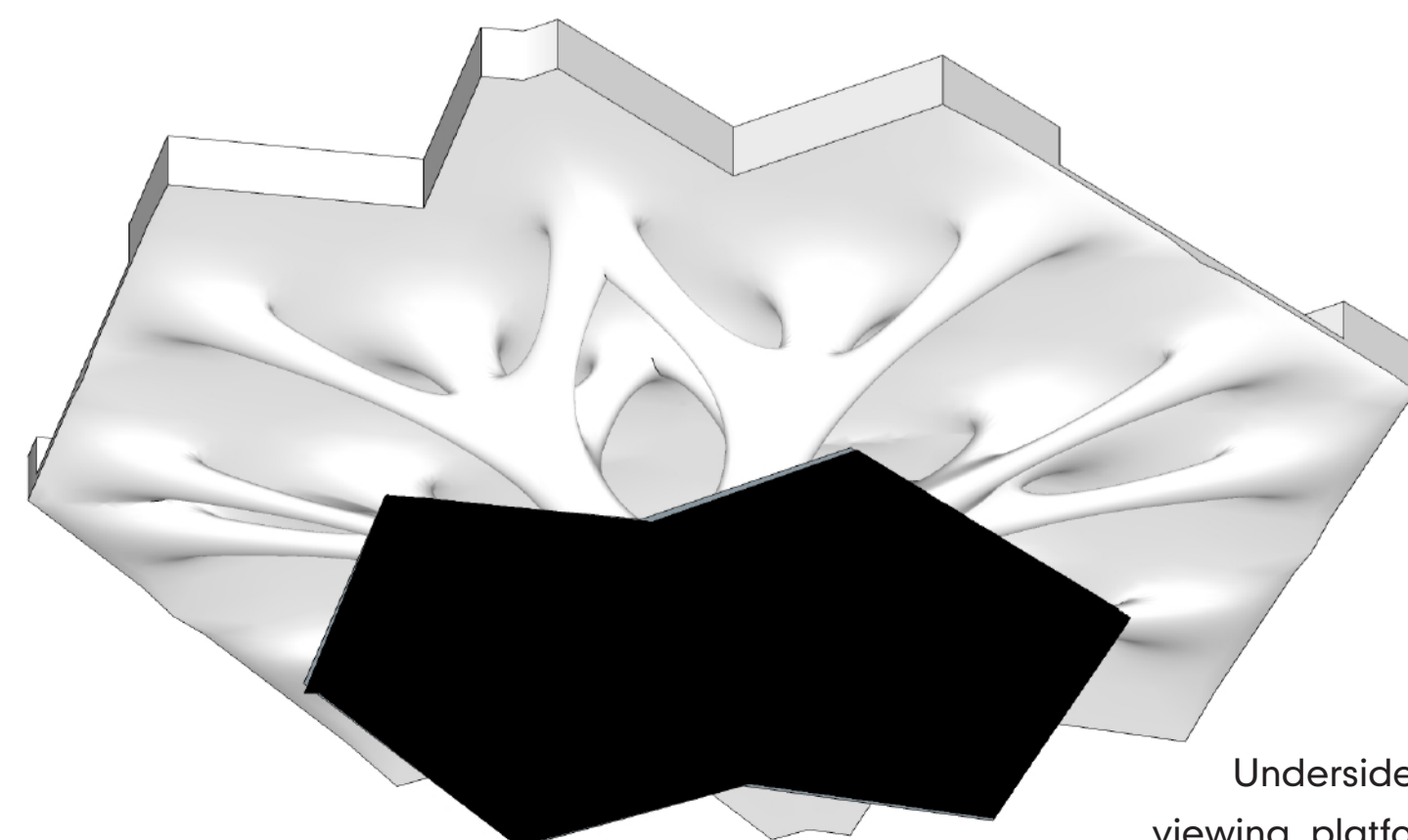

Underside of viewing platform

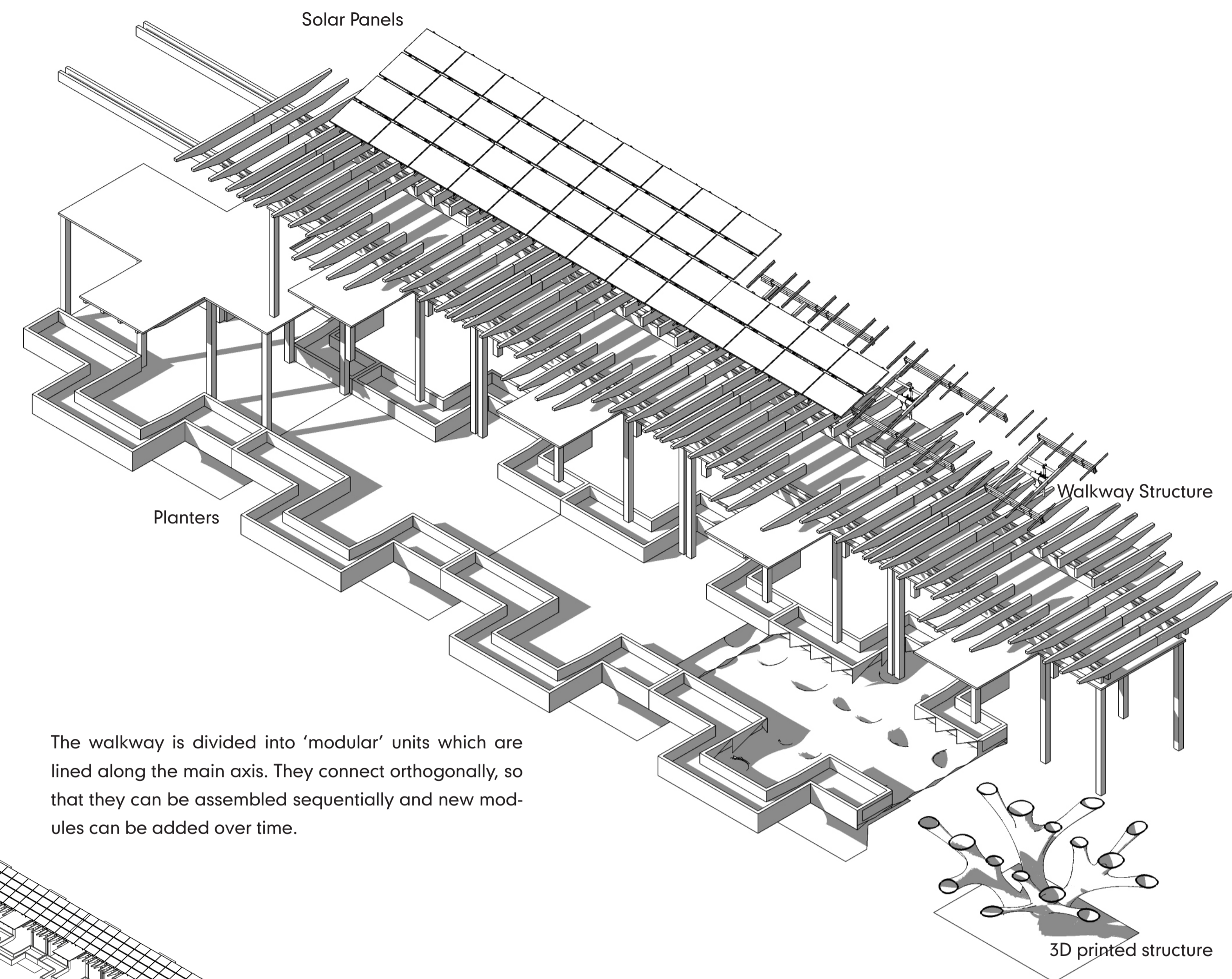

The walkway is divided into 'modular' units which are lined along the main axis. They connect orthogonally, so that they can be assembled sequentially and new modules can be added over time.

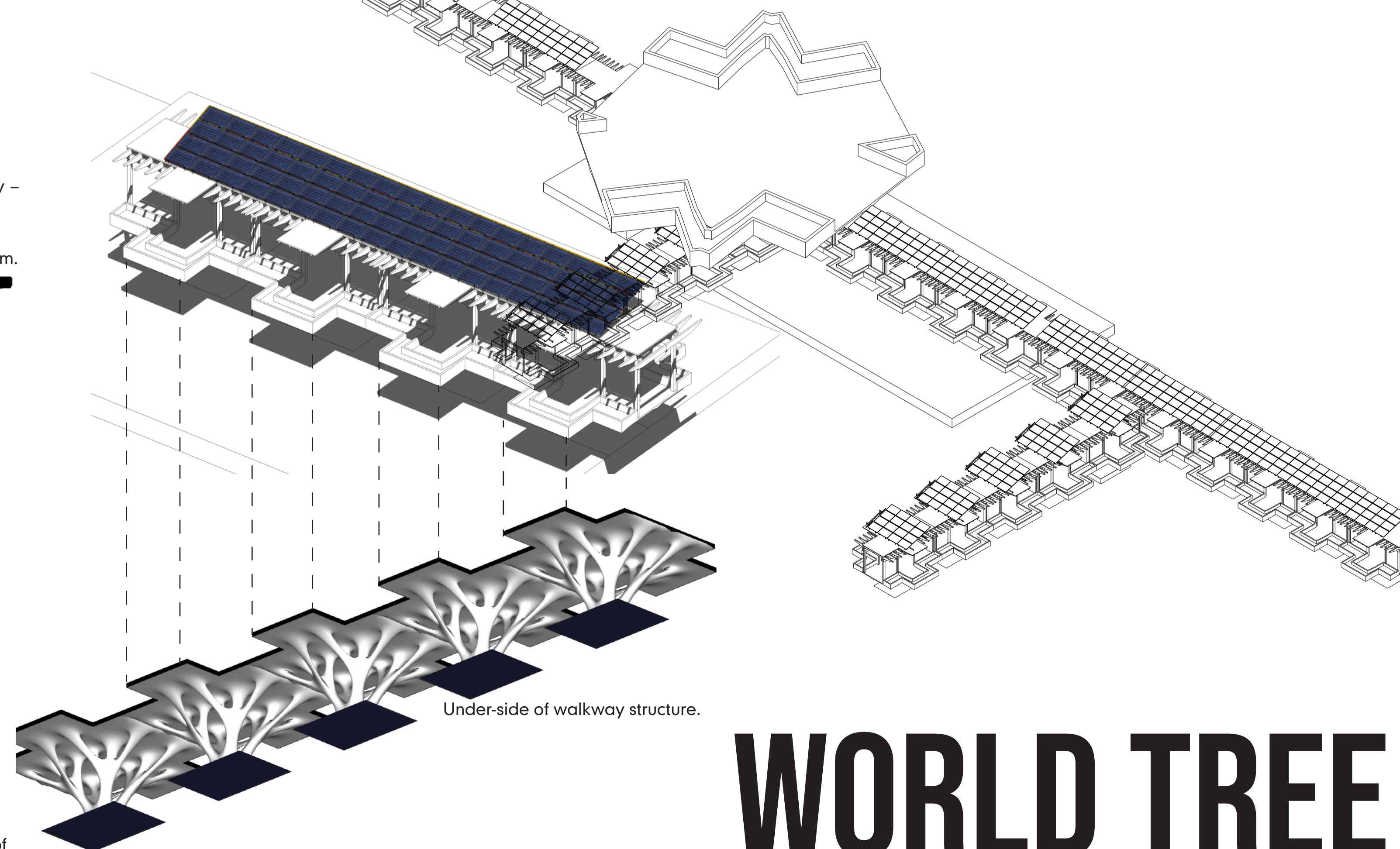

Under-side of walkway structure.

WORLD TREE