

- 1 RAISED STEEL PLATFORM
- 2 CONCRETE FOUNDATION
- 3 SOLAR GLASS DOME
- 4 BATHROOM UNIT
- 5 BIKE RACK ENTRY
- 6 DOME SHADING SYSTEM
- 7 PRIVAT DECK
- 8 PRIVATE HOT SPRING

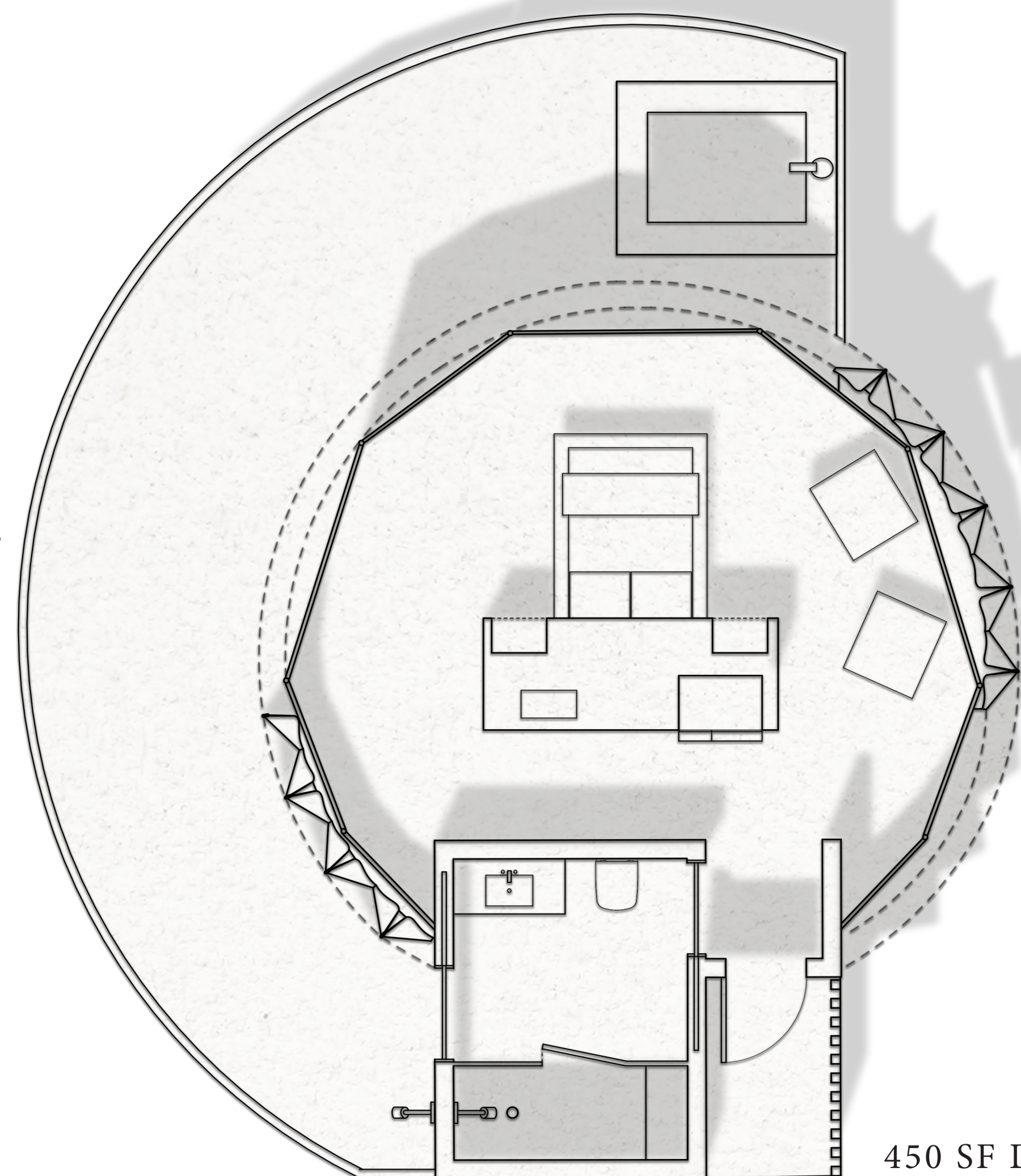

450 SF DOME PLAN

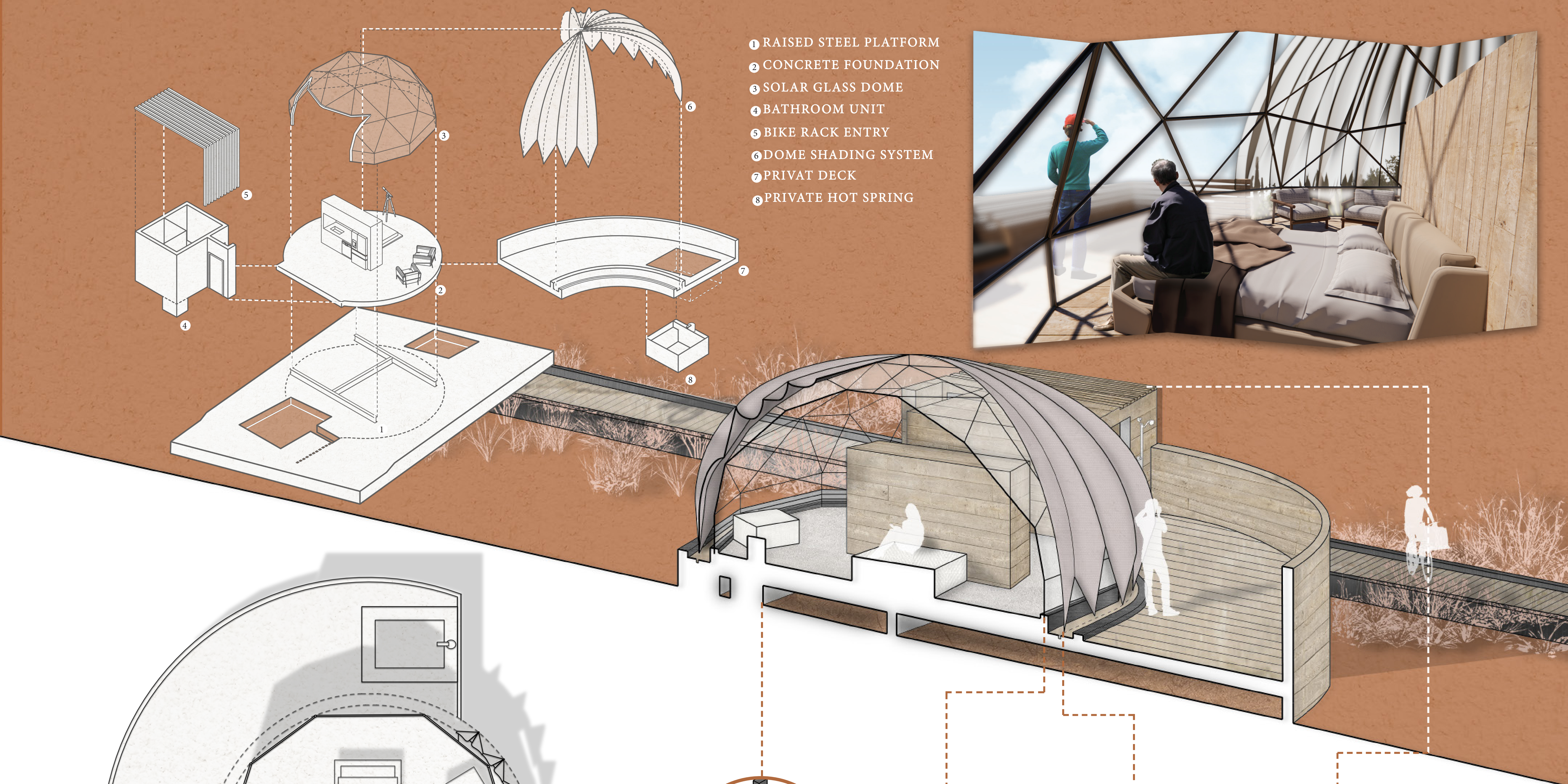
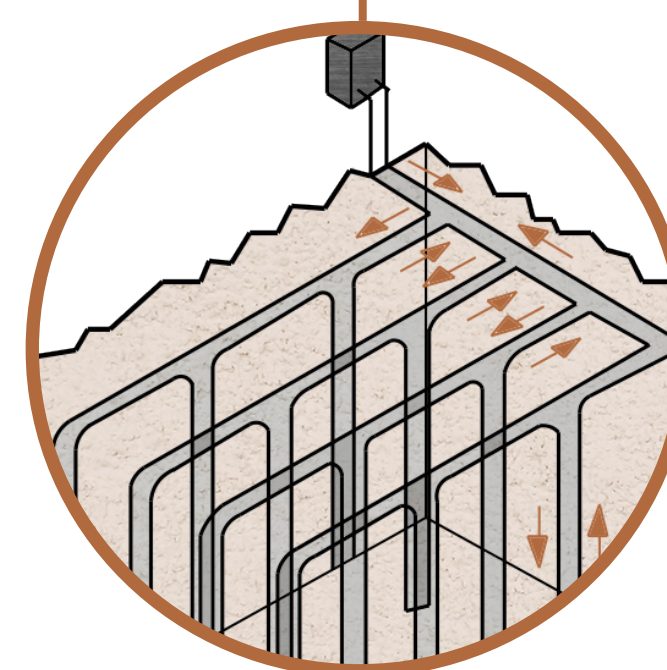

GEO THERMAL HEAT PUMP SYSTEM

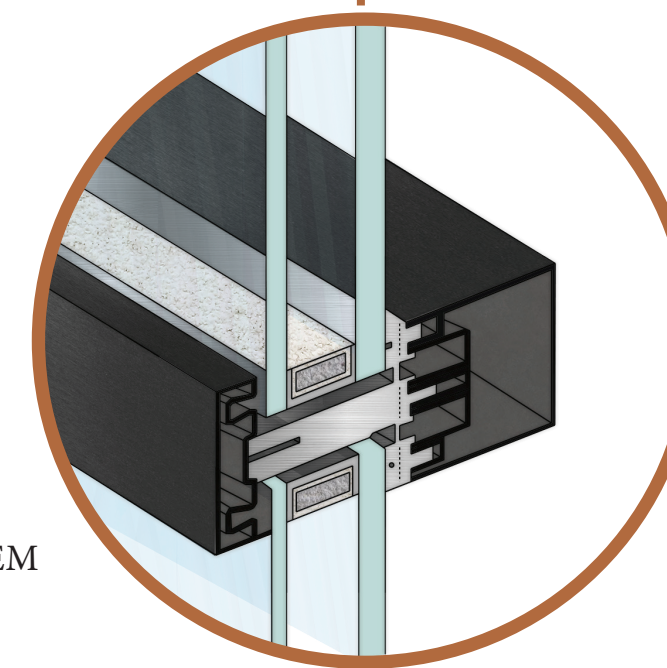

INSULATED SOLAR GLASS DETAIL

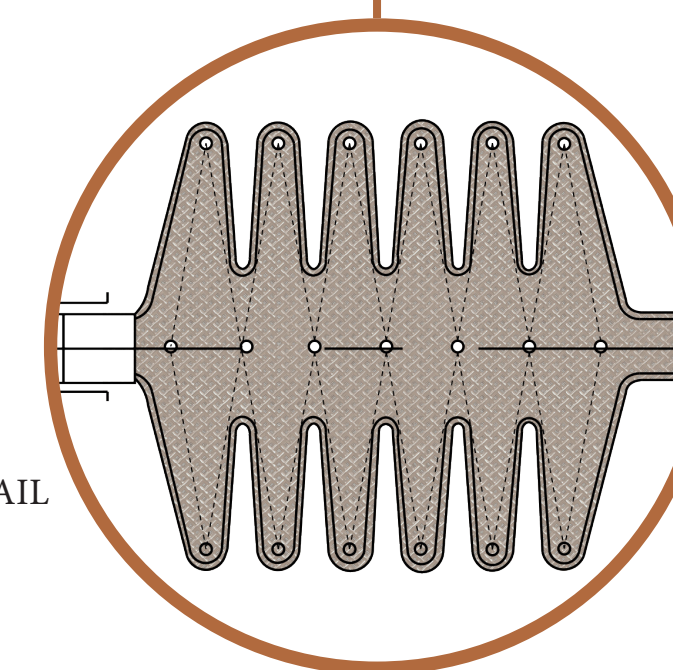

SOLAR SHADE SYSTEM DETAIL

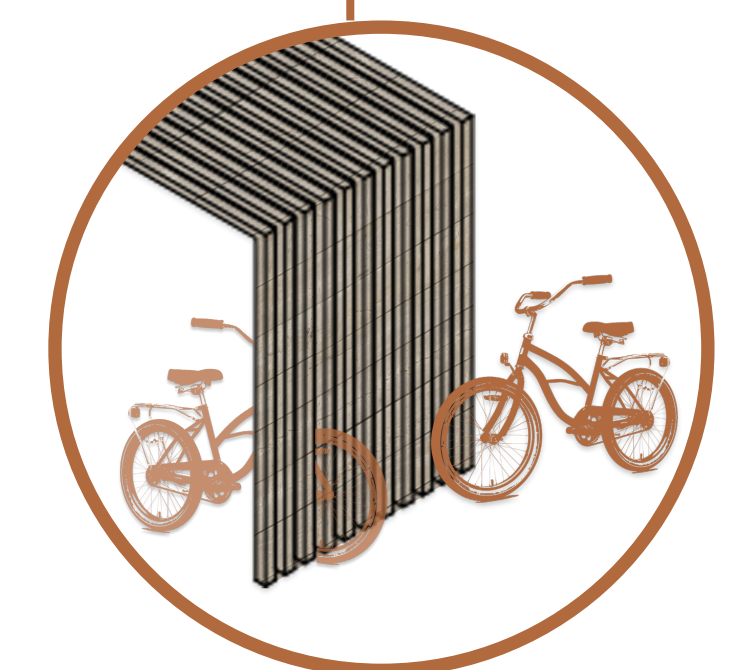

ENTRYWAY BIKE RACK