

IN-BETWEEN

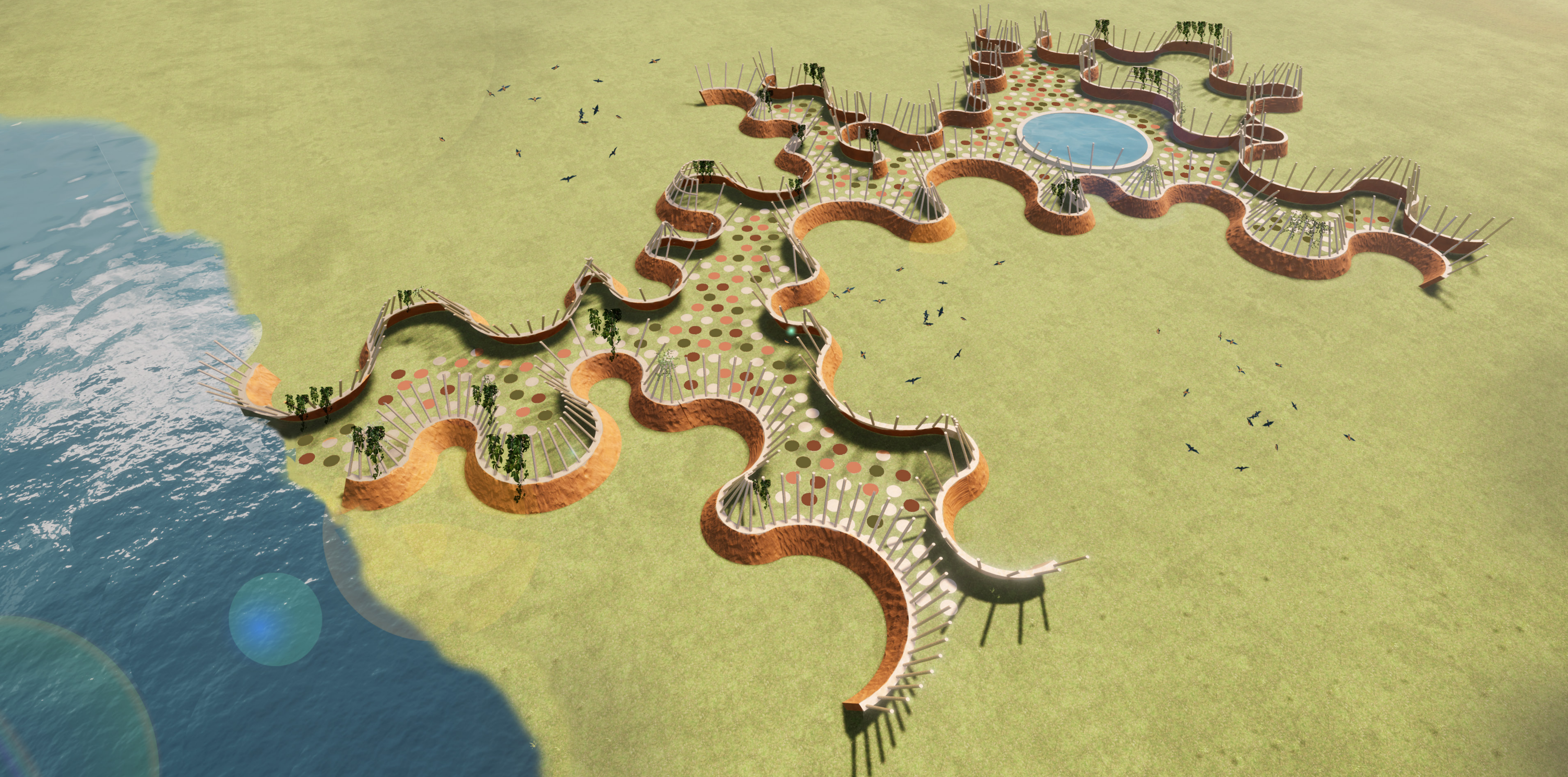

The project looks at the intervention between the natural and artificial world by connecting the public with the environment at Fly Ranch and with different technology that allows the project to give back to the site. It achieves four systems: energy, water, food and shelter to create a space that can be used year-round by the public in many ways. The geometry of the installation presents a composition of walls and paths that invite users to walk along and reflect on the desert and isolation that surrounds them. The calm but complex geometry of the design makes it appear that the walls have eroded over time revealing the metal pipes on top that contain thin-film semi-transparent photovoltaic panels to collect solar energy. Additionally, there are site paving panels that use piezoelectric sensors to harness the kinetic energy as people walk through the path. Inside the pathway, there are also water harvesting ponds that collect and filter water to be reused to grow food within parts of the project too. The use of the technology and materials makes a reference to the history and future of Fly Ranch.

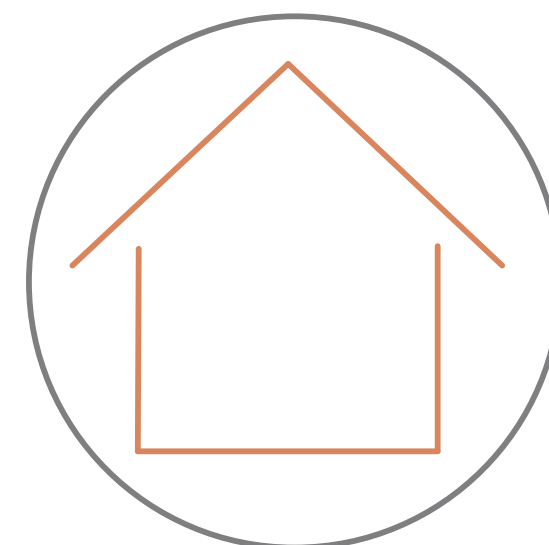

Shelter



Food



Rainwater Harvesting

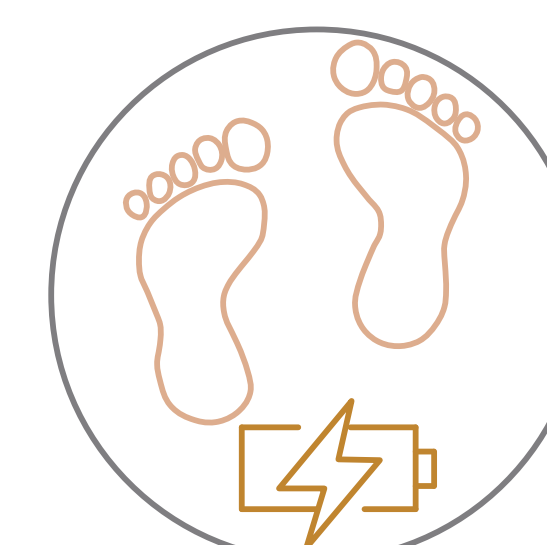

Footstep Power

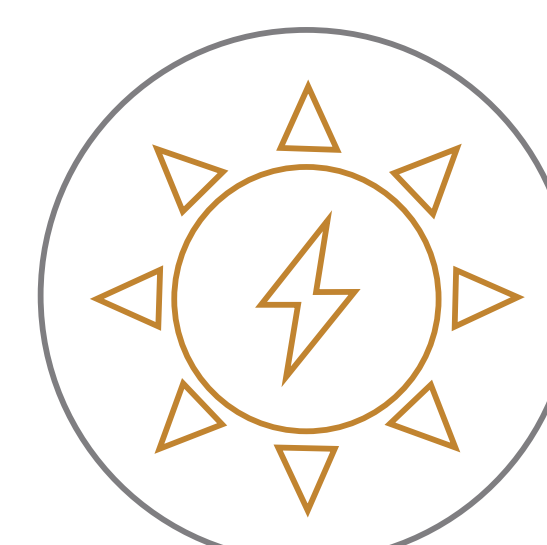

Solar Power