

ELEMENTS

Interventions

Actions

small scale situations

large scale situations

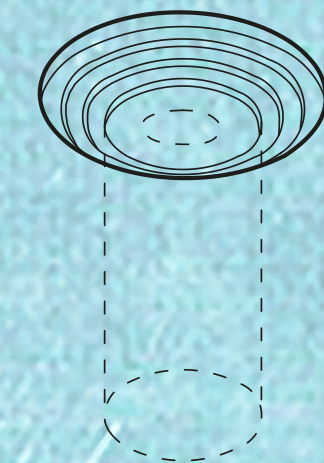
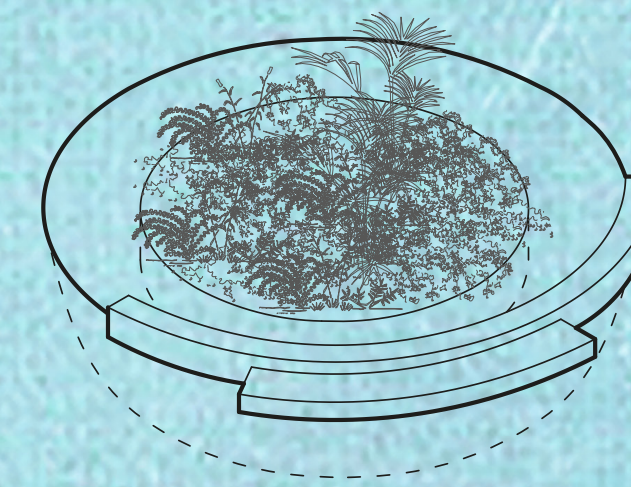
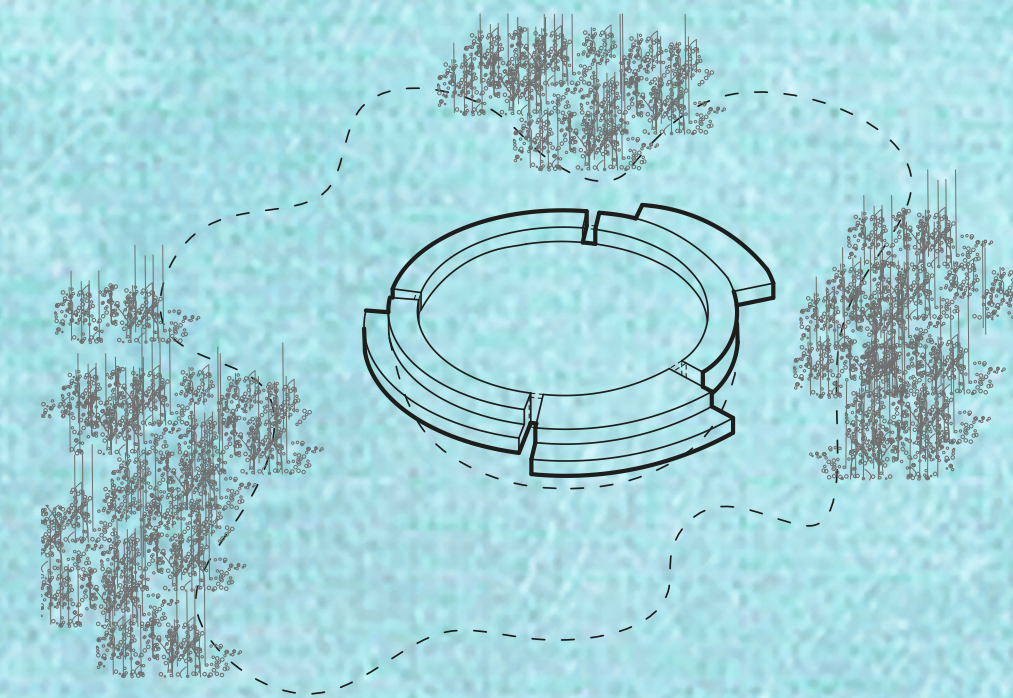
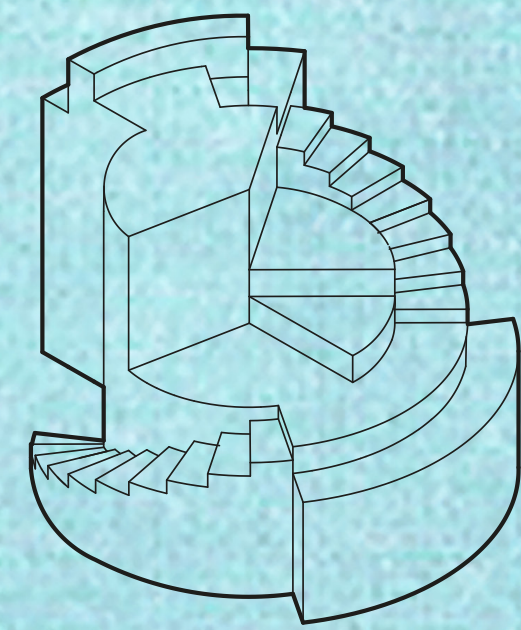
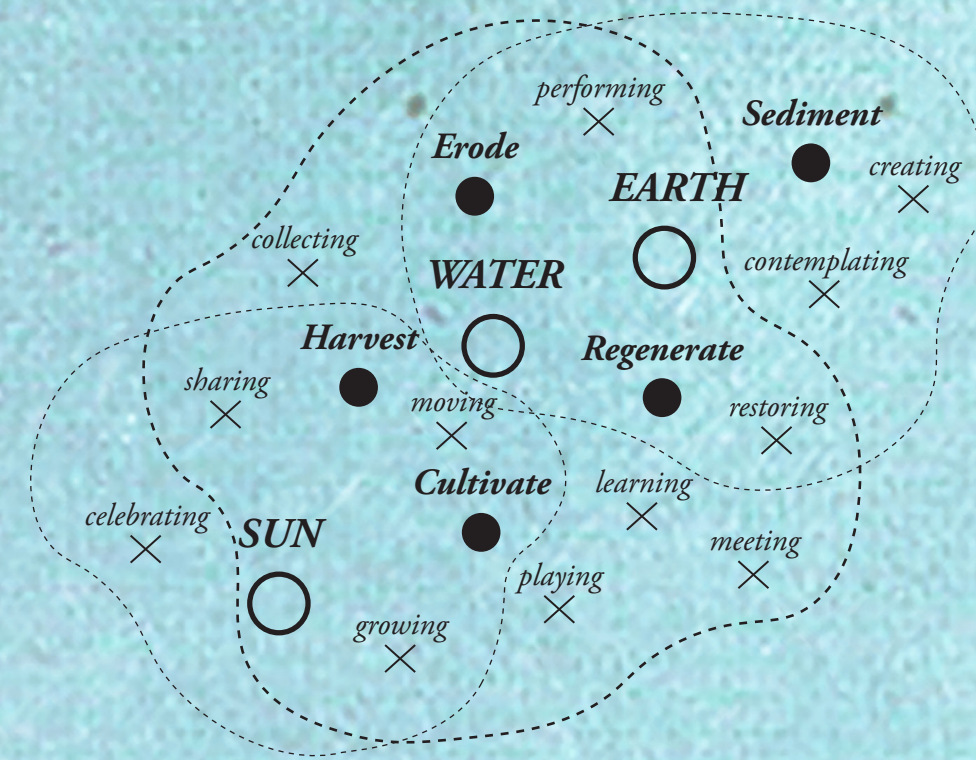

Situations

Spontaneous situations—celebrating, sharing, collecting, creating, contemplating, learning, meeting, playing, restoring and many other living experiences—result from the relationship between food, water and zero waste support systems and from the interaction between interventions and natural elements. These situations allow for a harmonious sense of being with nature, coexisting with non-human agents, and celebrating life.

Sediment

View towers are sculpted over a period of time out of excavated earth—from ponds and wells—providing varying viewpoints throughout the site.

Regenerate

Ponds are excavated to collect rainwater. Throughout the dry season water is channeled out of the ponds to instigate plant and animal life around them.

Cultivate

Circular islands (chinampas) float for cultivation. The floating base of these islands is made from wood waste from the Burning Man festival and earth residues.

Harvest

Filtered water is harvested in wells as a source of drinking water for the human community.

Healing the Land

The interventions — Sediment, Harvest, Cultivate, Regenerate — are organized in a rhythmic pattern around the existing lakes as Land Art. Following an acupuncture strategy, the interventions act on specific points and penetrate the surface layer to heal the land using natural elements and bringing back ancestral knowledge.

