



AUTHENTICITY OF PLACE

All senses are tickled by the complex landscape at fly ranch. The site lets you experience wide, open areas of sun heated and dry sand that are contrasted with multiple reservoirs and steams. Wildlife noises from animals like; wolves, frogs, mosquitoes and birds make you feel a deep connection to nature. Making your way through the site you will witness a variety of plant communities with different characters. Barren sagebrush communities with a distinct smell, dry meadows and thriving wetland vegetation share the space at fly ranch. Most of the vegetation does not have a height that reaches above human eyes, only a few trees and higher bushes can be found on the site. At first glance the vegetation may seem mostly green, but when having a closer look a variety of flower carrying plants can be found.

The history of Fly Ranch reaches far back in time. The place has mainly been a cattle ranch, old fences and abandoned farmhouses are witnessing this. Despite traces of human use of the landscape, nature gives the impression of being wild and uncontrolled. The norden paitude people are the original users of the land and they are still living close to the area. They have a deep relationship to nature and a spiritual connection to the landscape. This is respected by a design that both adds new value to the place by providing new color and shape, and at the same time embraces nature and history of the site.

The loop honors all aspects of the unique landscape at fly ranch by being well integrated with the surrounding and by gathering the qualitative experiences of

the site at one place. The service station is located by the middle reservoir where water meets land. It interacts with the site by reaching out in the water and by letting the sacred bath be surrounded by the existing vegetation. The bushes that today edge the road along the reservoir are continuing through the courtyard, the building is embracing nature and the other way around. Meandering out from the loop, ornamental plantations of flowers symbolises the life flowing through the service station. By using native species from the whole area and concentrating those treasures to one spot, the authentic beauty, the diversity and the spirit of Fly Ranch are honored. The flowers and the trees surrounding the building will give the loop a sense of being an oasis in the barren desert.

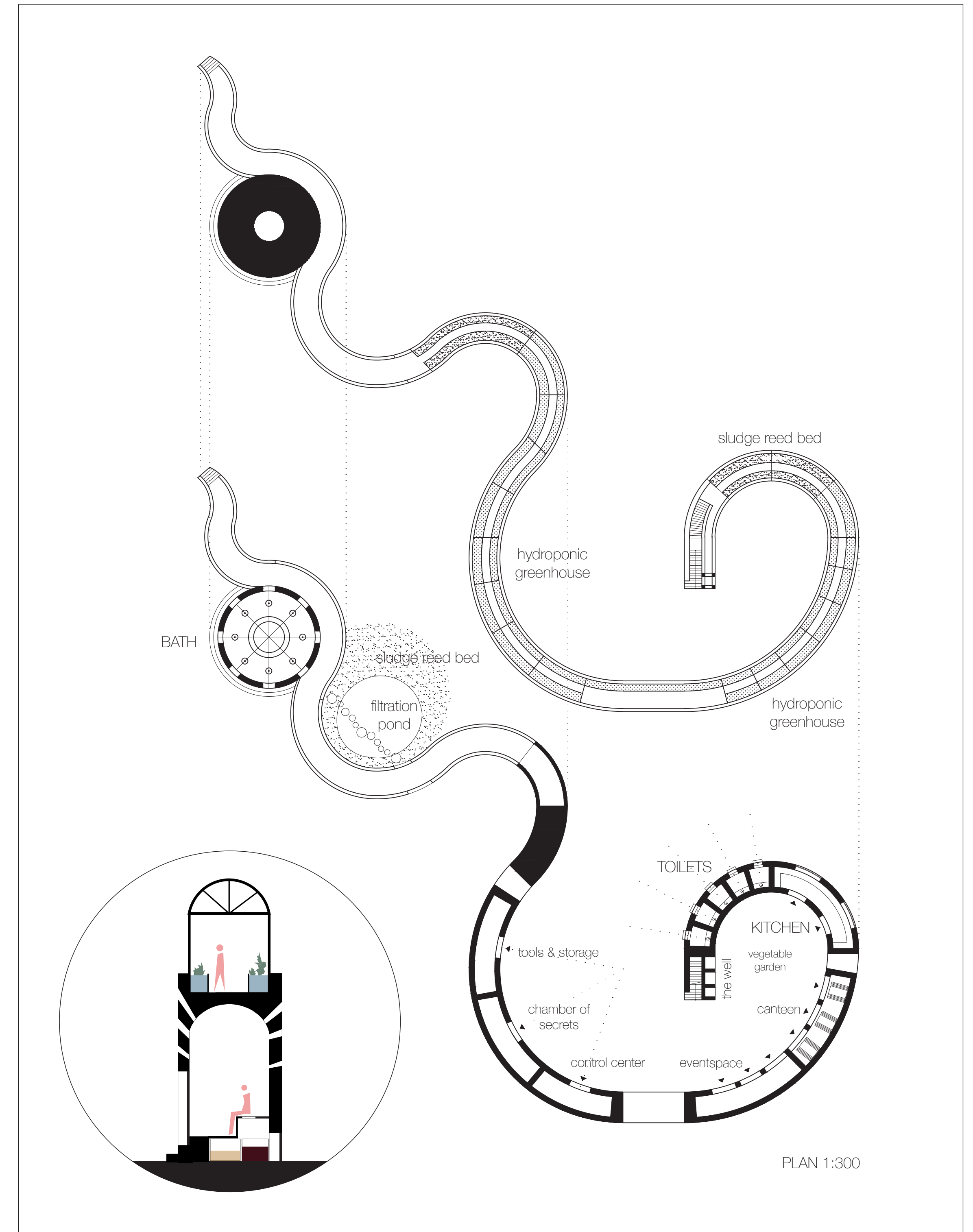

TESTING THE FLOWS

When prototyping the concept, we test a number of parts of the system and their relationships. A dehydration toilet made of clay, sand and straw, separating and storing pee and poo. A small version of the water flow system, including a hydroponic garden, sludge bed, filtration pond and recirculation through water stairs. Everything powered by the sun, which also runs a few sensors and automated valves. And the most important part; increasing biodiversity by growing plants and studying what predicted and emergent forms of life may flourish.

VISION 2050

The practice of preserving and introducing life in the area has been well established, dead land has been brought back to life.

We work in collaboration with a multitude of efforts engaged in rewilding of the planet's lost ecosystems. The Loop gathers and provides skills and knowledge among others working to integrate human needs in circulation with the ecosystems. Feasible practices are shared with burners, off-grid villages, refugee camps and the WHO.

On the local level, The Loop recirculates the pee, poo, compost and greywater from enormous bi-annual gatherings in the surrounding desert. Nutrients from hundreds of thousands of people are turned into a wondrous flourishing landscape, stretching as far as the eye can see.