

BAUBOTANIK - BOTANICALLY INSPIRED BIODESIGN

COINED BY GERMAN ARCHITECT FERDINAND LUDWIG, BAUBOTANIK WAS INSPIRED BY THE ANCIENT ART OF TREE SHAPING. KNOWN AS INOSCUATION OR APPROACH GRAFTING, THIS PROCESS OCCURS WHEN BRANCHES IN CLOSE PROXIMITY FUSE TOGETHER. OVER TIME, AS THE LIMBS GROW, THEY EXERT INCREASING PRESSURE ON EACH OTHER, SIMILAR TO THE FRICTION BETWEEN TWO PALMS RUBBED TOGETHER. THIS CAUSES THE OUTER BARK TO SLOUGH OFF, EXPOSING THE INNER TISSUE AND ALLOWING THE VASCULATURE OF BOTH TREES TO INTERMINGLE.

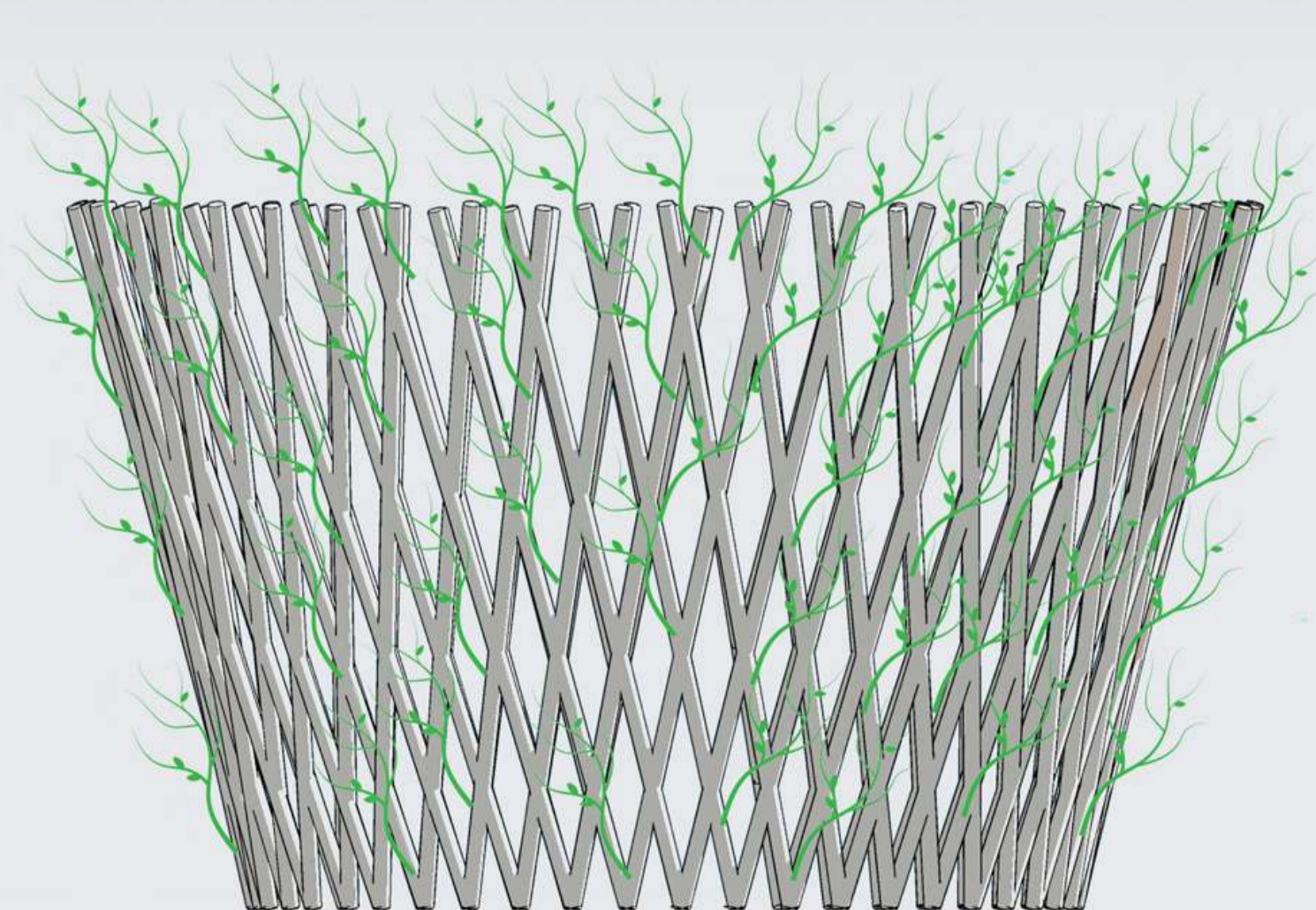

INITIAL STAGE

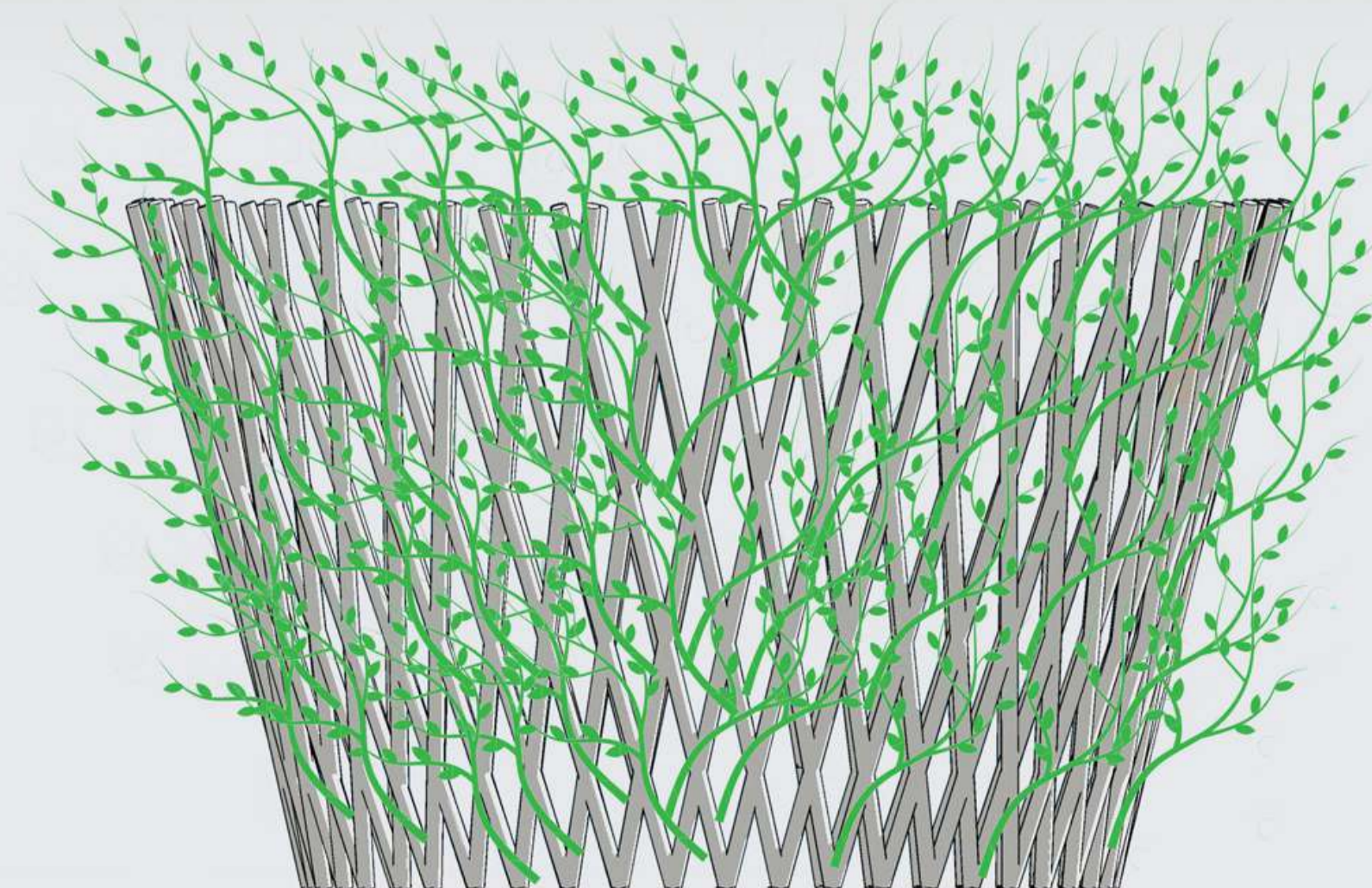

FINAL STAGE

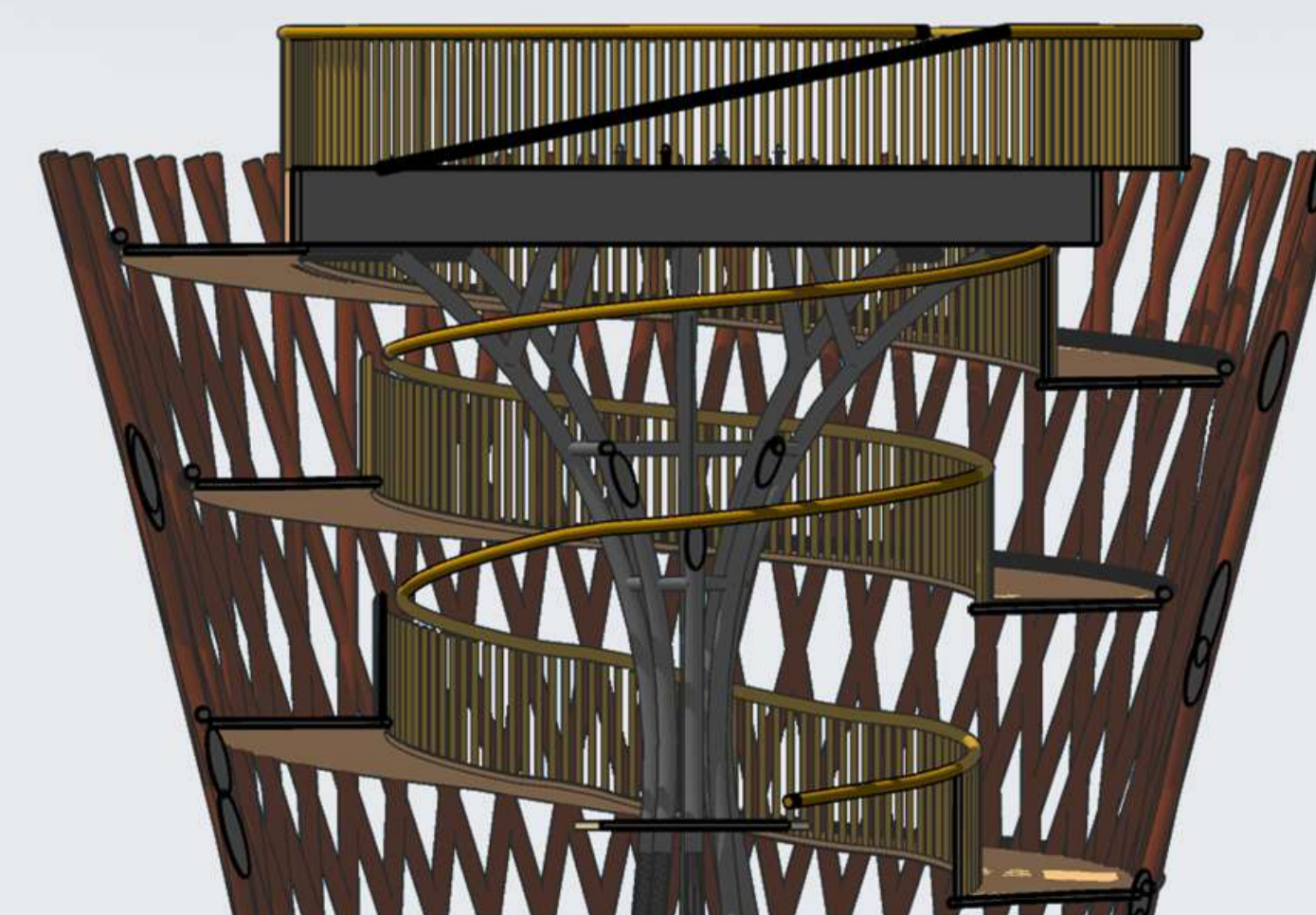

SECTION OF THE MODULE

OVER TIME, AS THE TREES AGE, THEIR FUSED JOINTS CONTINUE TO STRENGTHEN, PROVIDING FURTHER LOAD BEARING SUPPORT.

IN THIS PROPOSAL, WILLOW TREE HAS BEEN USED FOR BAUBOTANIK AS IT IS AN INDIGENOUS SPECIES WHICH HAS ALSO BEEN EXPERIMENTED IN BAUBOTANIK.

EACH SAPLING IS PLACED AT A 0.4 METER DISTANCE.

