

Marou Totem Landscape

LAGI 2025 | land art for a changing climate

03. CODESIGN WITH COMMUNITIES

The tree-like structures, which we are calling “totems” are assembled to create canopy-like assemblies that also provide protected spaces below, to be used by Marou village residents and visitors for various activities that support the Marou community, human and nonhuman.

From our research we propose some options for added programs, knowing that this would be developed by the community and the needs of the village. The system is modular so it allows for expansion as needed taking into account the human and more-than-human communities that are also present in the area.

Any community that is displaced, flower or bushes, would be studies to see how the proposal can help augment the ecosystems that it displaces. We propose a co-design not only with the human communities, but also with the flora and fauna of the village.

CODESIGN WITH LOCAL VEGETATION



local Fijian flowers and vegetation

CODESIGN WITH MORE-THAN-HUMAN LIFE



Orange Fruit Dove Parrot Finch Fiji_goshawk Fijian monkey-faced bat



The design is aligned with the 2030 Agenda for Sustainable Development, adopted by all United Nations. With the SDG's we recognize that human flourishing is rooted in the prosperity of all forms of life. Tackling climate change is the priority with the design of *Marou Totem Landscape*.

PROTECTED CANOPY PROGRAMS:

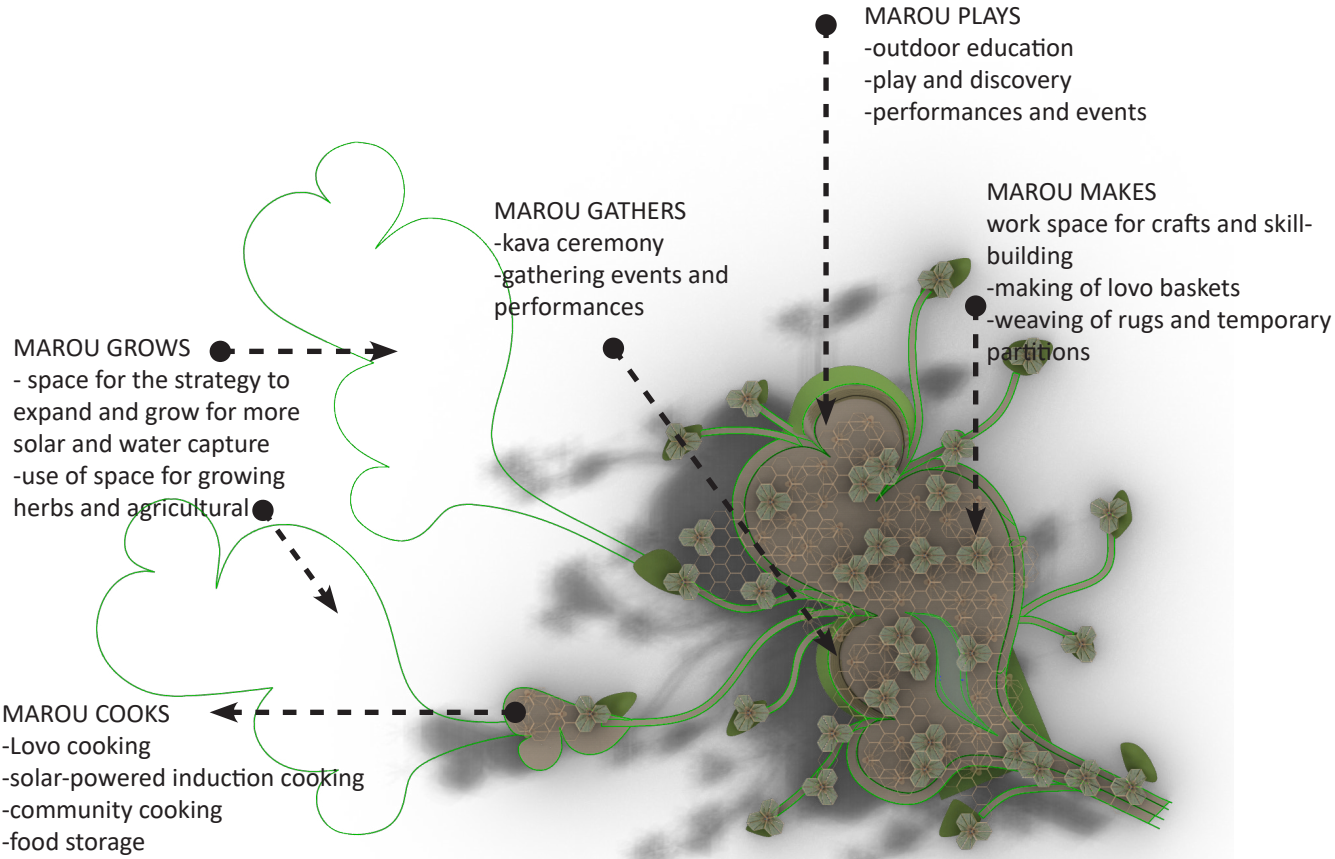

MAROU MAKES

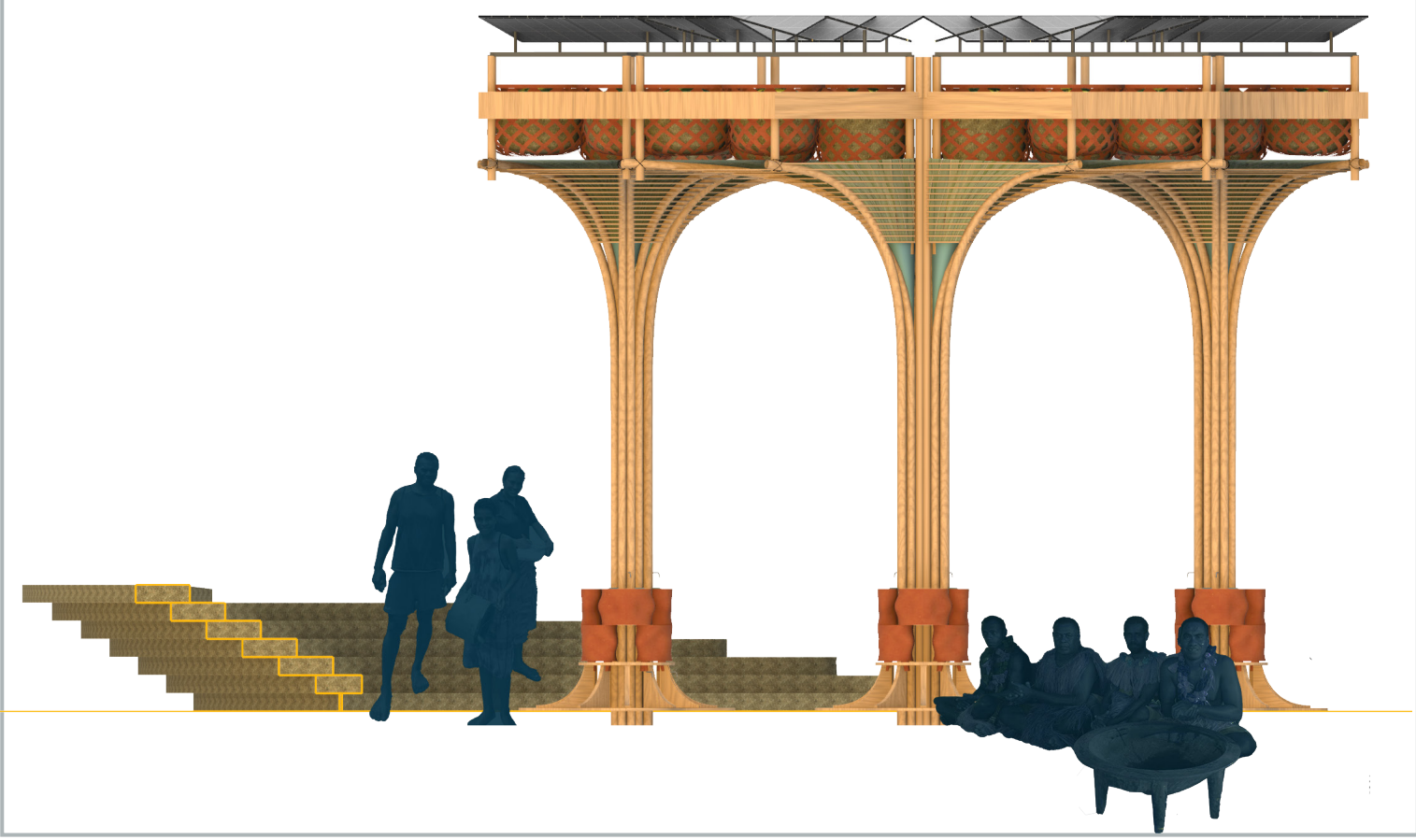

MAROU GATHERS

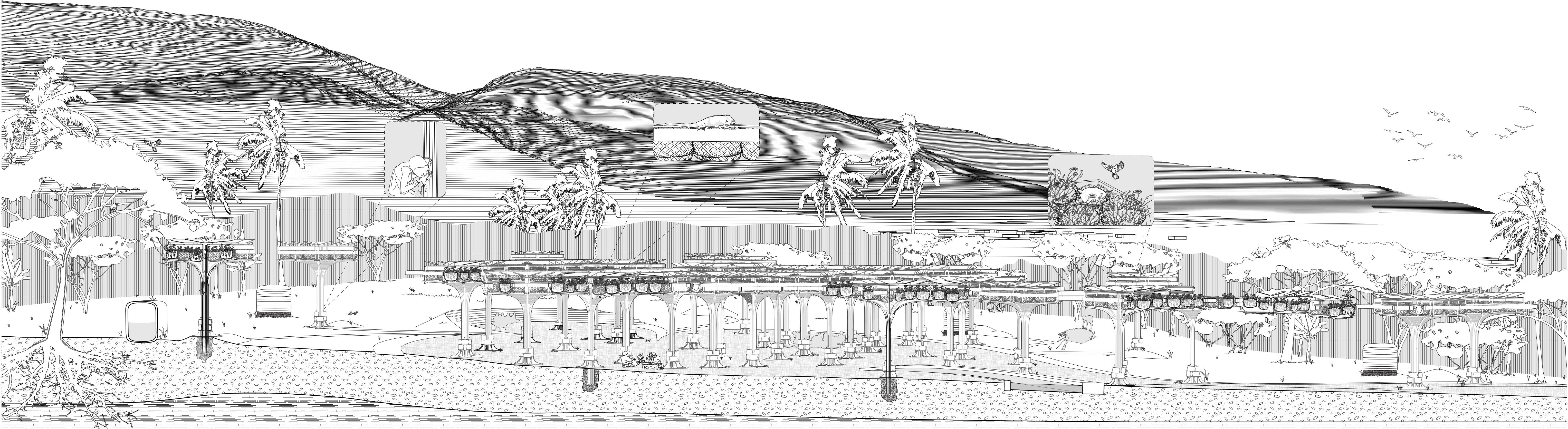
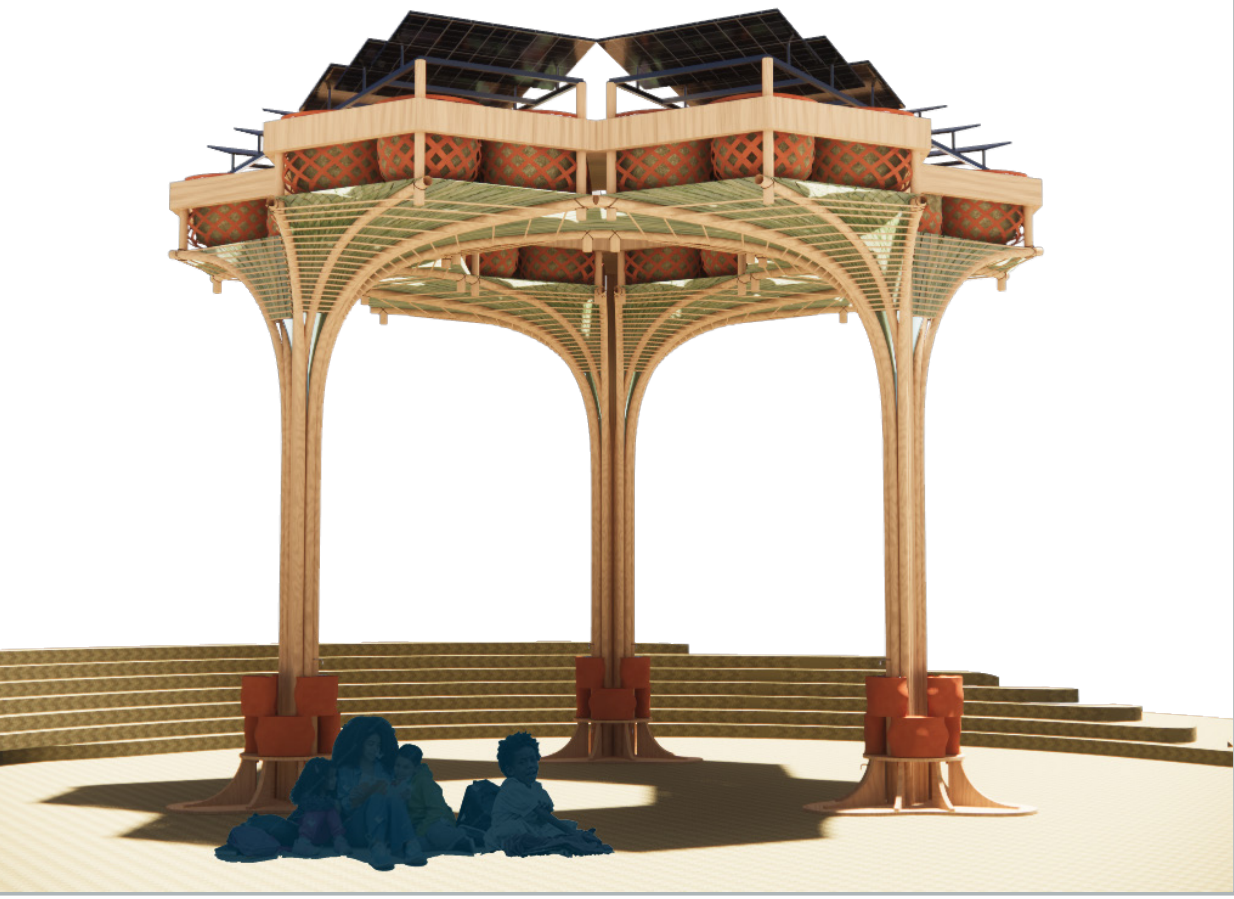

symbiotic section through the proposal, showing the interconnected systems and communities