

SOLAR VOLCANOES

Honouring the past, powering the present, inspiring the future

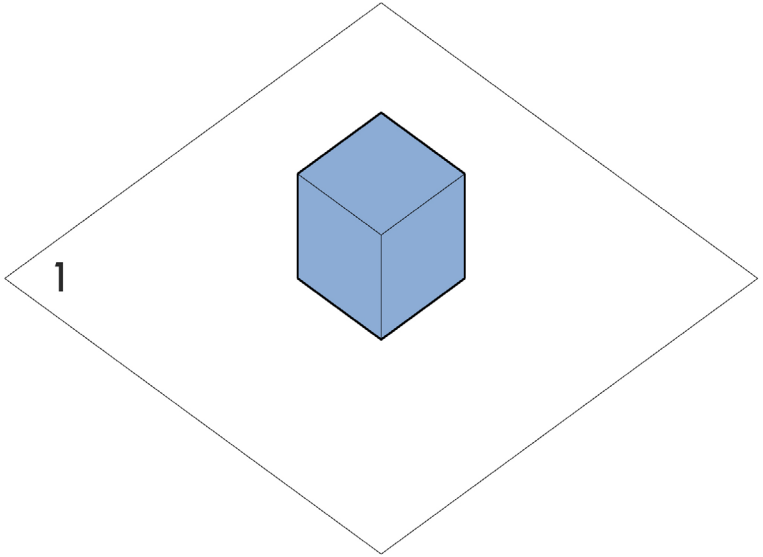

DESIGN CONCEPT



Selecting Box as a basic shape

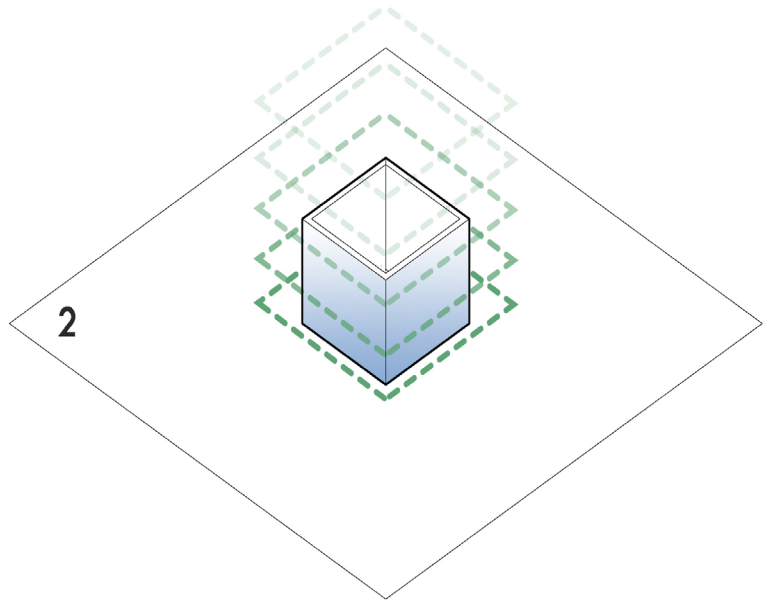

Using the surface of the shape as a layer to collect solar energy.

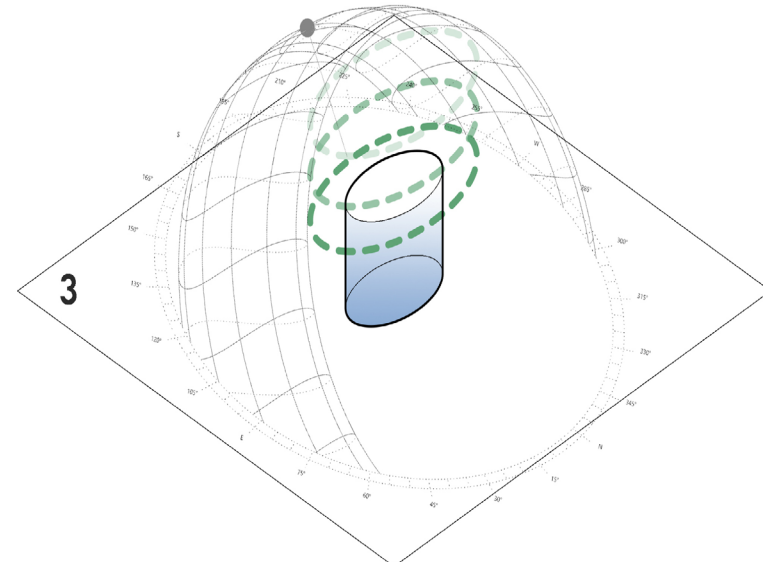

Choosing an ellipse as the shape that offers the largest sun-facing area relative to the ground area it occupies.

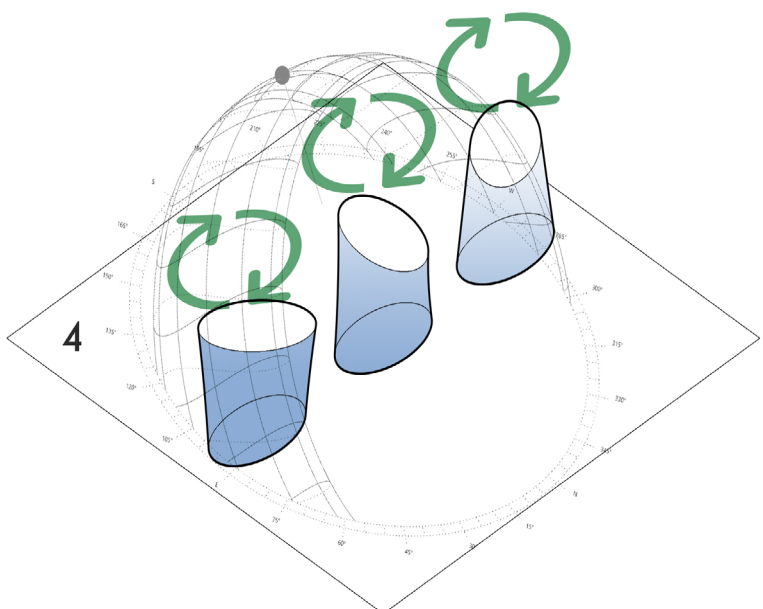

Using SMA materials as arms that change shape to modify the structure at the top and increase the solar collection area.

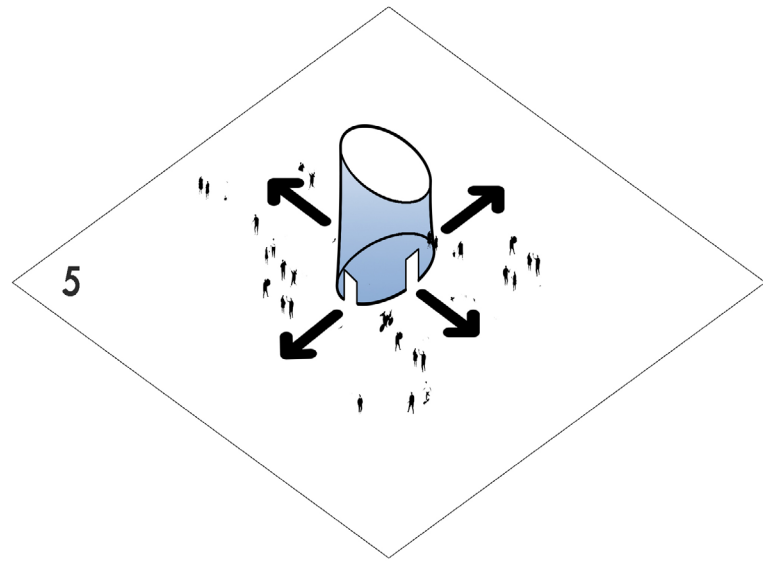

Making space at ground level to enable water flow and allow user access.