



The image presents an architectural module that fuses a modern structure with local natural materials, creating a dialogue between engineering and tradition. The structural base of the module is constructed of stainless steel, providing strength and durability. This structure is clad externally in palm and bamboo, generating an organic texture and a visual connection to Naviti's tropical surroundings. Access to the module is defined by rustic stone walls and a natural wood roof, harmoniously integrating with the surrounding pathways. Gentle ramps connect the walkways to the entrance, facilitating accessibility. Through the doors, dim or semi-dark light is perceived, suggesting an interior designed for the cultivation of plants that thrive in partial shade. This module exemplifies the project philosophy by combining the solidity of a stainless steel structure with the warmth and sustainability of natural materials, reflecting inspiration from natural forms and the cultural relevance of the surroundings.

The schematic section shows a comprehensive and efficient solution for energy and water management, strategically located to optimize space and minimize visual impact. Integrated beneath the structural protection of the staircase, next to its load-bearing wall, is the control and connection system for the energy generated by a group of six solar modules (each with seven 600W panels, generating 4.2 kW per module). From this point, the combined energy from this group is directed to the centralized energy storage system, located in the NIDO, for management and distribution. This system ensures energy supply even in the absence of direct sunlight.

Along the perimeter of the module (representative of the group), a rainwater collection channel, elevated to prevent the collection of surface impurities, guides the water through a natural filtration system of gravel and activated carbon, ensuring initial purification. The treated water is stored in underground stainless steel tanks. The choice of this material, known for its durability, ease of cleaning, and hermetic sealing, preserves the quality of the collected water over the long term.

The underground placement of the tanks represents a smart strategy for utilizing the land, freeing up surface space for other project needs and avoiding visual contamination from ground-level technical elements. This discreet integration underscores a commitment to functionality, sustainability, and the aesthetic harmony of the surroundings.

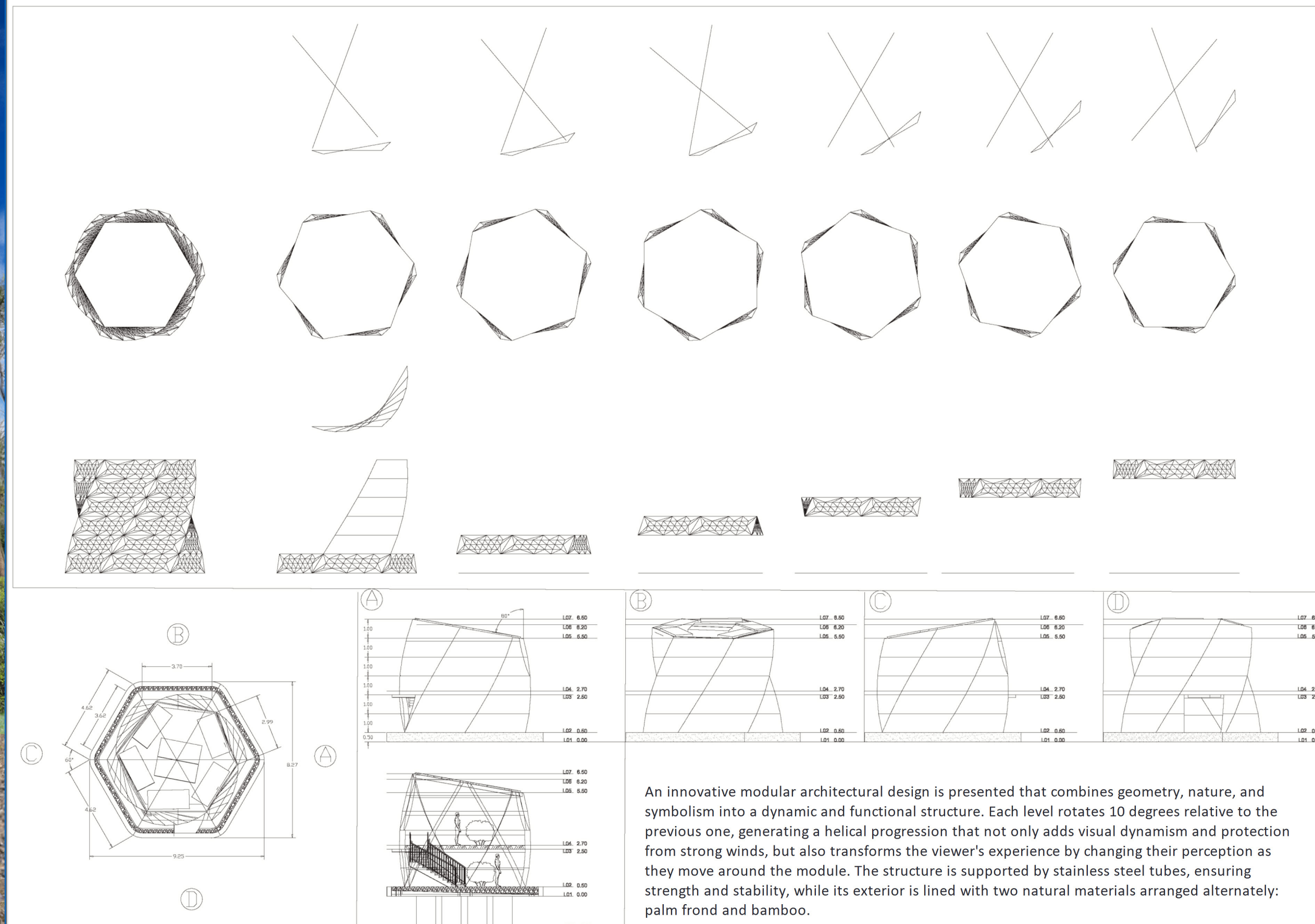
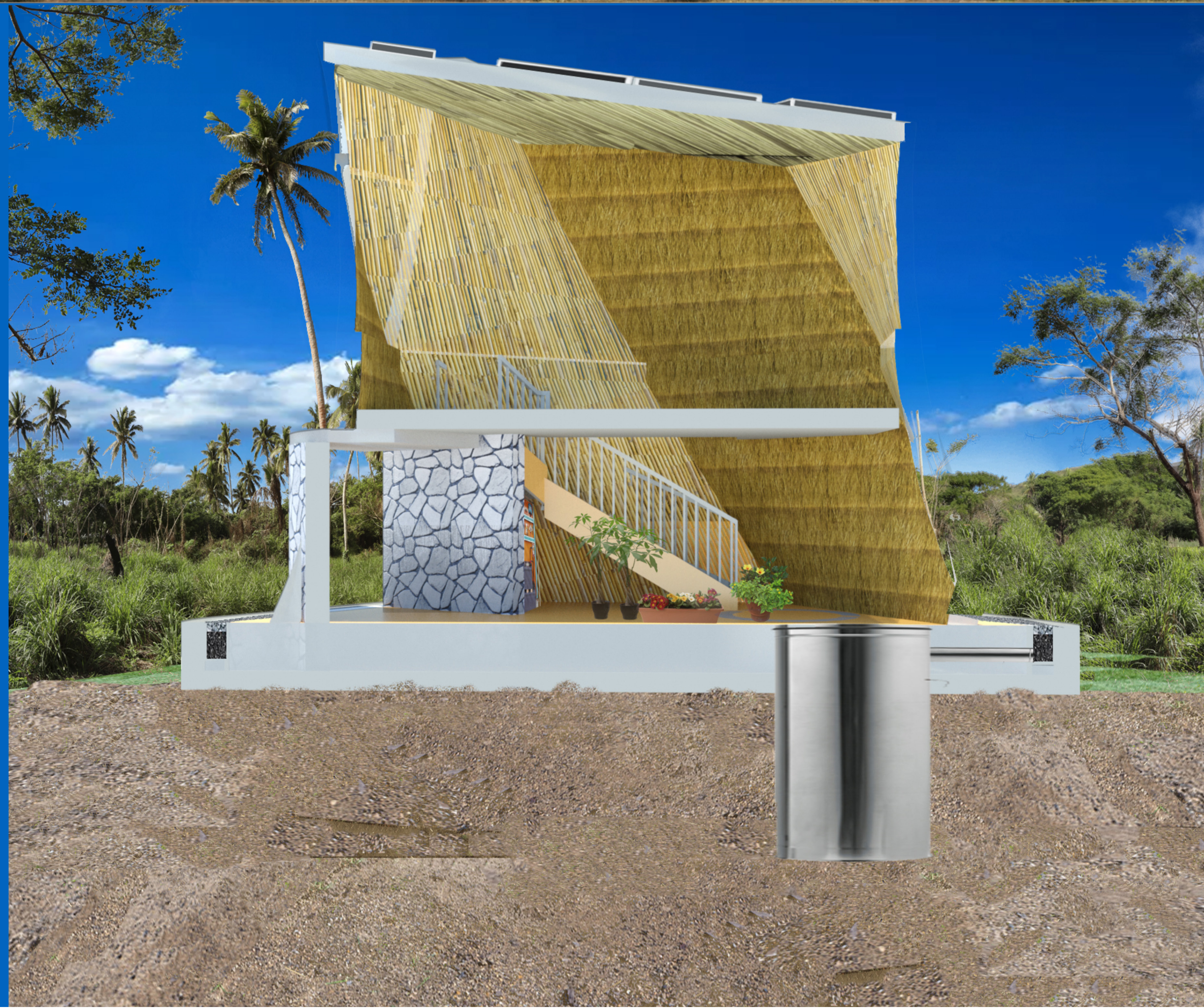

An innovative modular architectural design is presented that combines geometry, nature, and symbolism into a dynamic and functional structure. Each level rotates 10 degrees relative to the previous one, generating a helical progression that not only adds visual dynamism and protection from strong winds, but also transforms the viewer's experience by changing their perception as they move around the module. The structure is supported by stainless steel tubes, ensuring strength and stability, while its exterior is lined with two natural materials arranged alternately: palm frond and bamboo.

This alternating pattern, where one side is covered with palm frond, associated with vitality and renewal, and the next with bamboo, a symbol of flexibility and strength, creates an aesthetic and conceptual interplay that evolves with the rotation of the levels. This use of materials reinforces the connection with nature and adds symbolic meaning, representing the balance between simplicity and resilience, once again demonstrating the very essence of the inhabitants of Maruo Village, in the Yasawa Archipelago and Fiji Islands, as well as the continuous cycle of life. Furthermore, the design includes a straight and a curved stone wall that guide access to the interior and to the upper floor via a wooden staircase, highlighting the duality between the rigidity of everyday life and the fluidity of nature. The roof, constructed from wooden logs, completes this eco-friendly integration, offering an architectural proposal that is not only visually striking but also deeply connected to its surroundings, the worldview, and, most importantly, the very essence of its inhabitants: simplicity and resilience.