

BLOCK A

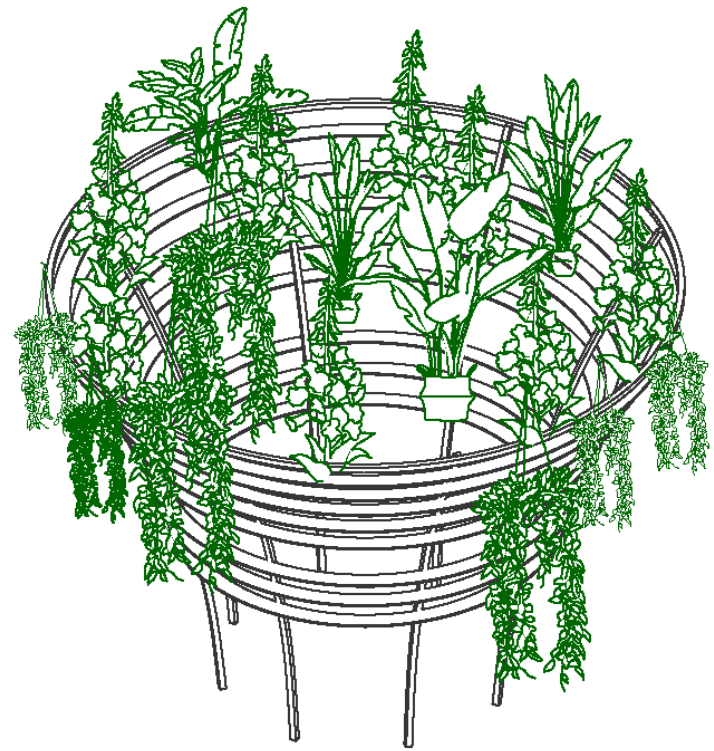
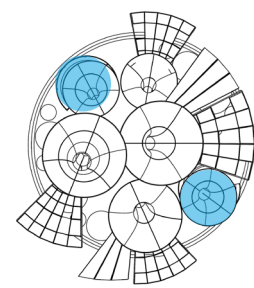

BLOCK A

One of the typologies of blocks within the station area is a steel structure for planting. This circle consists of several rows and on it can be placed tubs with plants.

Different crops of fruits and vegetables as well as herbs are grown there. Every inhabitant can plant their own crops there and eat them. It is also a place where children can be educated.

BLOCK B

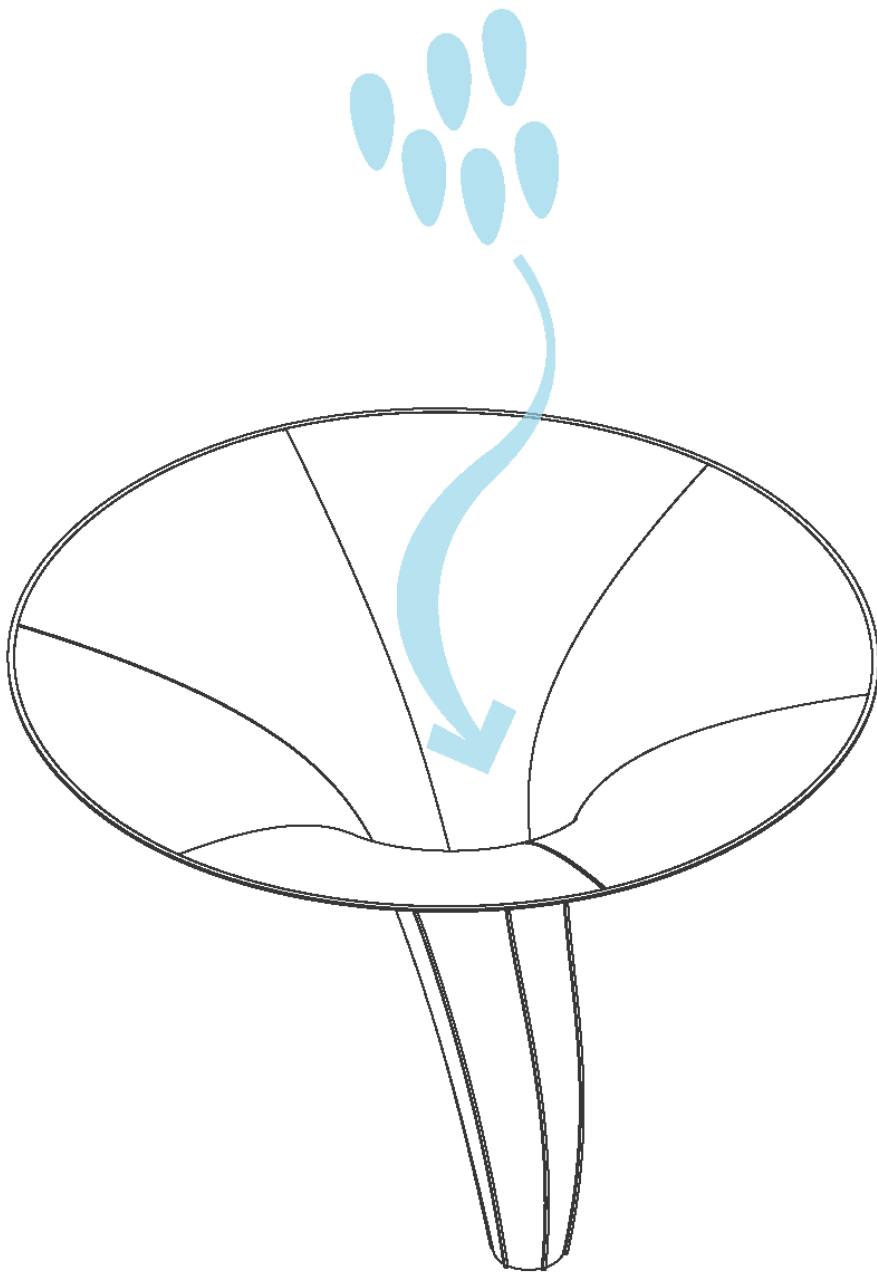
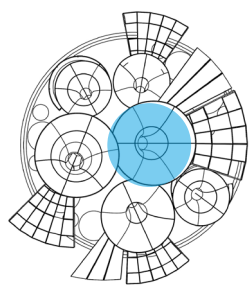

BLOCK B

Special funnels are made to collect and filter rainwater. They have a very wide cross-section at the top to cover the rainfall. They then take the water underground.

Under the water, the tanks store and filter water for the needs of local people. The funnels are assembled from fiberglass plates. They are fastened to a metal frame and attached to the station.

BLOCK C

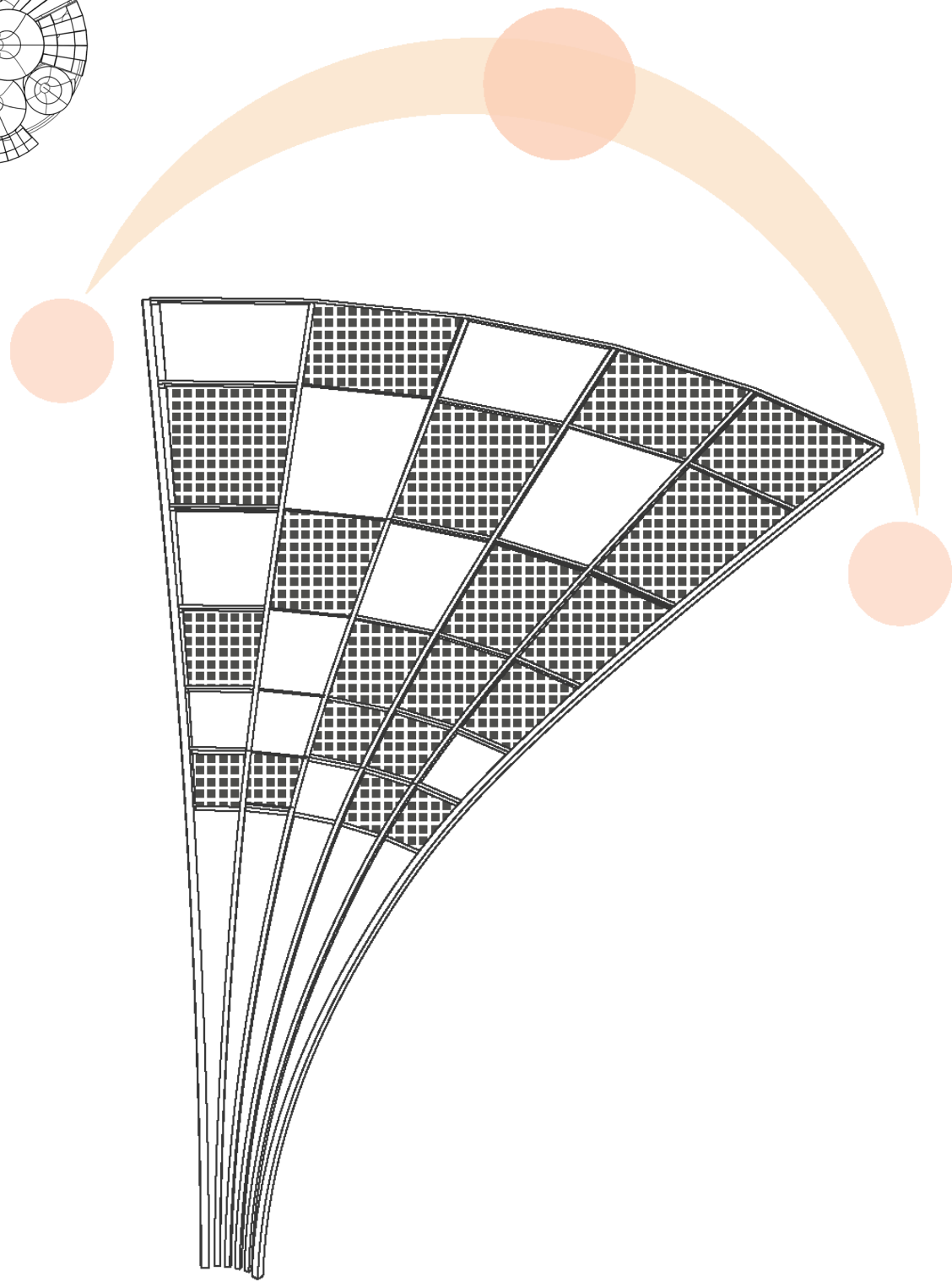
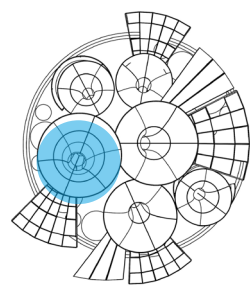

BLOCK C

The village requires a lot of electricity. For this I followed the images of leaves from palm trees and made large metal structures holding solar panels. There are about 5 such structures on the site. They are arranged along the trajectory of the sun.

The solar panels are also made on a metal frame, about 30 solar panels it holds. There are also holes for the sun to get in. There are also lights on the back side of the panel for night time use.

BLOCK D

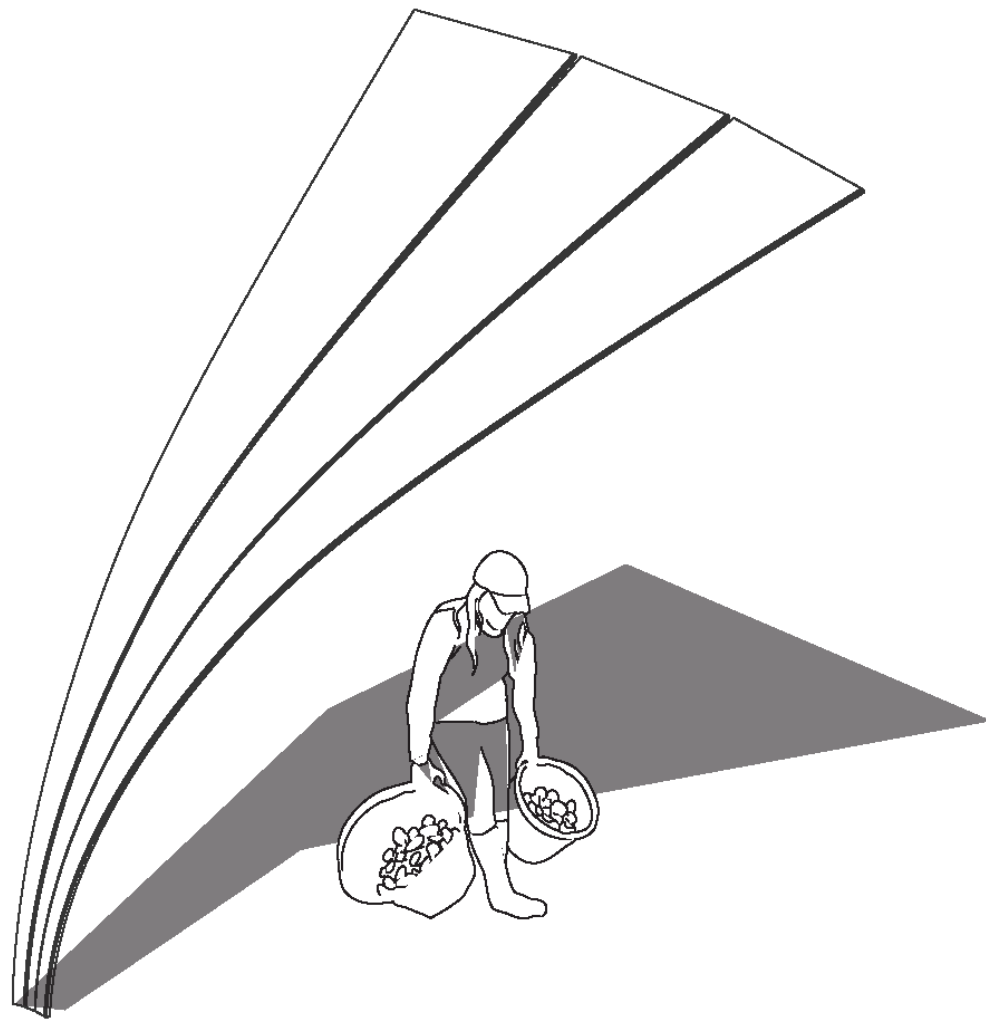
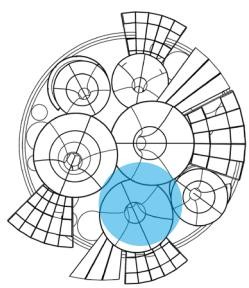

BLOCK D

Imagine, it's hot weather outside. There is nowhere to hide from the sun. For this purpose, my station has some fan-shaped sun shelters. They are like leaves that cover people from natural disasters.

The frame is a metal structure. Several bent rods are fixed inside the station under the ground at one end and the other stick out of the ground to take the load from the fabrics stretched between them. These fabrics allow for the creation of shade.

SECTION

