



Plan view of the site



A place for pause and connection: Gathering space below the lookout

Dance Abstraction

The design concept is inspired by the traditional Fijian meke dance, a cultural practice that embodies celebration, welcome, community, and tradition. By capturing and abstracting the dance movements through long-exposure photographs, we shaped the site's structures, translating the fluid gestures of meke into dynamic spatial forms.

Dance movement	Long Exposure	Abstraction I	Abstraction II	Abstraction III	Final Form

Plant Community

The plant materials are selected to support traditional practices as well as local ecology and ongoing maintenance of the site. These locally sourced species include a mix of native and productive plants chosen for their value in providing timber, food, fibre, medicine, and materials for ceremonial purposes.

- Pacific Kauri (timber)
- Yaka (timber)
- Coconut (fibre, food)
- Breadfruit (food)
- Banana (food)
- Pandanus (used to make Iri)
- Mulberry tree (used to make Tapa cloth)
- Frangipani (used in decorations)
- Kava (used for ceremony, beverage)
- Tamanu (medicine)
- Noni (medicine)



Community use and gathering around a rainwater harvesting structure

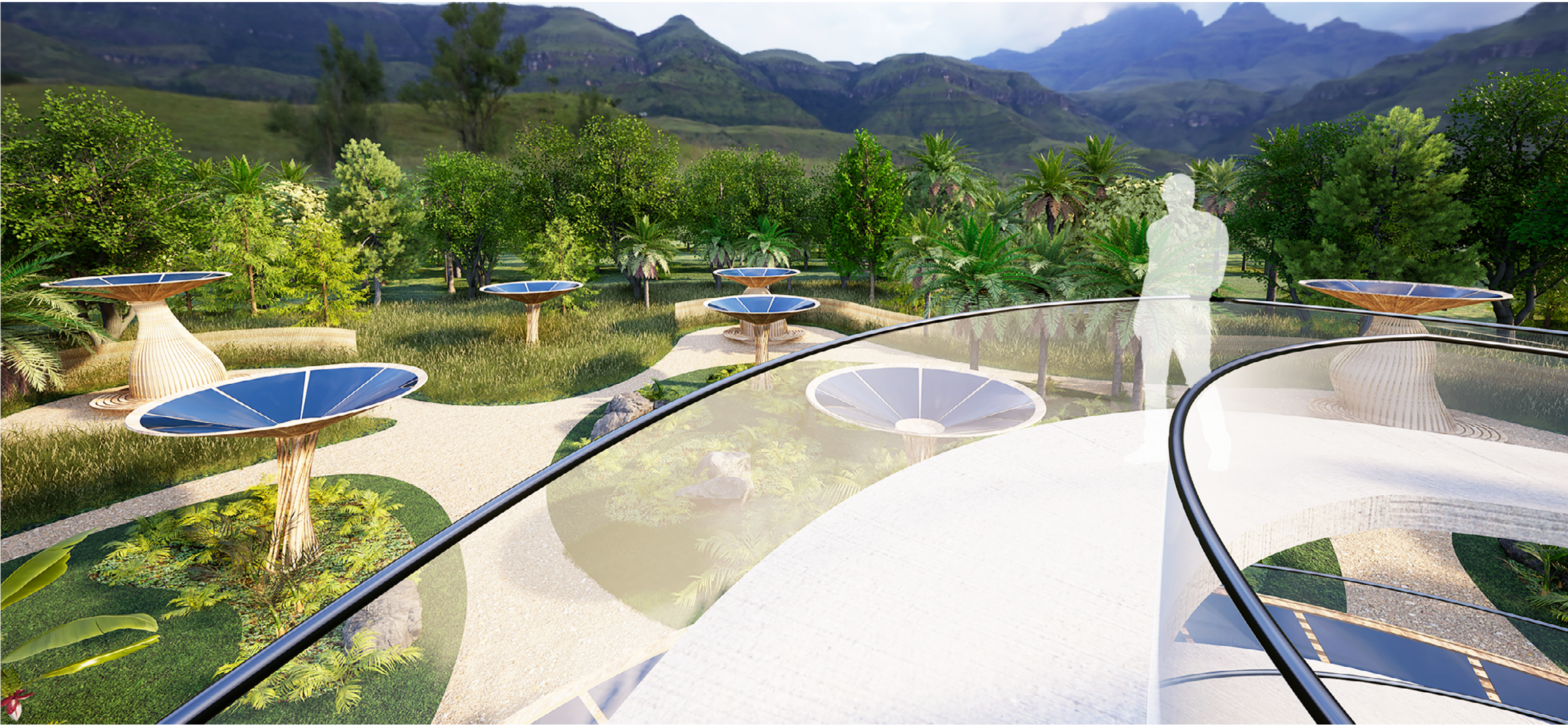

Meke Nexus beneath the feet: View of the site from the top of the lookout