

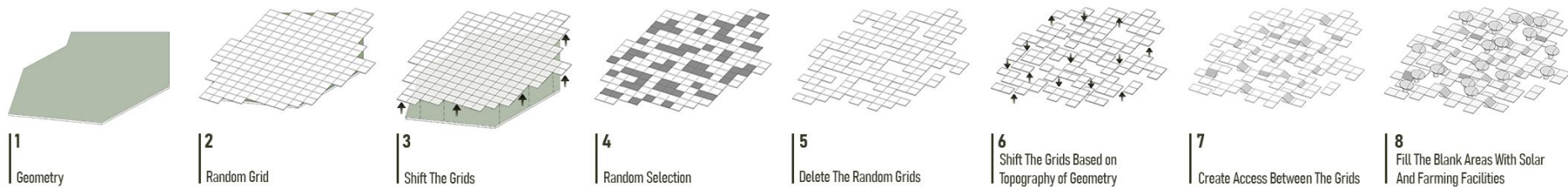

INDEPENDENCE

"Independence" is not just a name we chose for the project. It is an idea.
A way to describe an architectural model that can stand apart from the fixed geometry of its site.
A structure that can shift, rise, or settle to meet the changing needs of its users. Wherever it may be placed.
Throughout the design process, we turned to the simplicity of a "grid" to create a unified modular system.
One that not only allows access to the site, but also forms moments of gathering, for pause or rest.
By randomly removing certain grid segments, we opened up space for what matters most: and a pattern of life that grows with the land rather than claiming it.



THE GOALS AND IDEAS OF DESIGNING

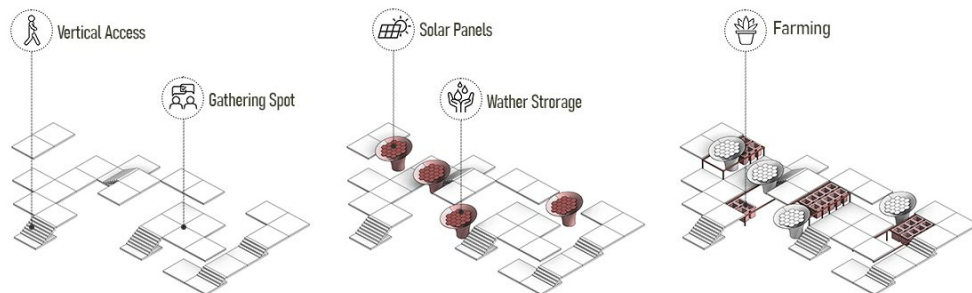

We aimed to organize the project in a way that would remain functional and meaningful across different climates and contexts.

The square grid units and their pixel-like form gave us the flexibility to arrange them in multiple ways, allowing the overall structure to adapt seamlessly to various topographies and site geometries.

As a result this concept can be used in different climates no matter if it is forest mountain or dry desert even near the shore.

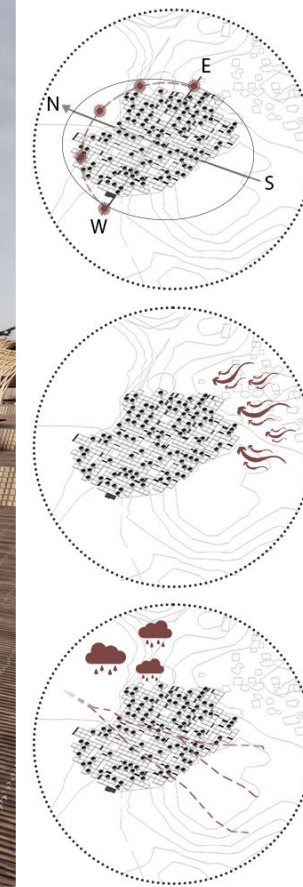
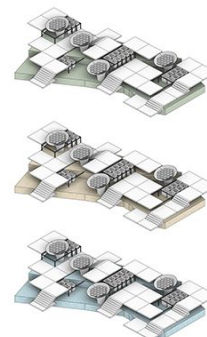

Comfortable living, reliable electricity, safety, and a land that can support everyday needs are not special privileges. They are the rightful inheritance of every person on this beautiful planet we all share.
At the heart of this project stood one essential question.
How can we design a place that generates clean energy while enriching daily life in the village of Marou?
That question led to many more.
What kind of functions truly belong in a space like this?
How do we respond to the layered needs of a local community that is not only rooted in tradition, but also full of potential?
Could this place become more than just an energy hub?
Could it be a place for gathering, celebration, sustainable farming, to pause for a romantic moment, and growing a local economy all rooted in daily life, not separate from it?
These thoughts became our starting point. As we studied the guidelines and listened to the context, we began to form a response. A design that holds meaning, purpose, and care.
But we knew that function alone would not be enough.
We looked for a design approach that could live beyond a single site. A system flexible enough to shift in height or form, yet still remain appropriate and meaningful wherever it may land.
We also thought deeply about the ground itself.
We imagined a structure that does not overpower its environment. One that can rise lightly from the earth, and if ever removed, leave no mark behind.
No damage. No scars. Just the memory of a respectful presence.
Because for us, designing this place meant more than meeting technical goals.
It was about creating something that listens to its setting, values the people who live with it, and stays in harmony with the land it calls home.
At the heart of our design lies a deep respect. For the Earth, as much as for its people.
Respect for the land, for its quiet strength and fragile rhythms, guided every decision we made.
We also honored the harmony of space.
A place that, no matter where it stands in the world, holds something familiar.
When you walk through it, whether alone or among others, something within you shifts.
You move along quiet paths, under structures that collect light and bring it back as life.
You pass by the gardens you have tended with care.
And in that moment, a soft and lasting gratitude begins to rise.
Gratitude for the land, for the time spent there, and for the simple act of being present.
A space where sunlight becomes electricity and shade becomes poetry.
Where technology serves life, and life feels just a little more beautiful than before.

