

THE CONCEPT



SITE PLAN KEY ELEMENTS

1	<b>SOLAR SAIL WITH FIBRE HUB</b> SOLAR PANEL SYSTEM (~20KW OUTPUT) WITH FIBRE PROCESSING AND PRODUCTION SETUP.	2	<b>SOLAR SAIL WITH FOOD PROCESSING HUB</b> SOLAR PANEL SYSTEM (~20KW OUTPUT) WITH FOOD PROCESSING AND PRODUCTION SETUP.	3	<b>SOLAR SAIL WITH WATER HUB</b> SOLAR PANEL SYSTEM (~20KW OUTPUT) WITH WATER FILTRATION AND PUMPS WITH 2x30,000L PORTABLE WATER STORAGE TANKS.	4	<b>SOLAR SAIL CANOPY</b> SOLAR PANEL SYSTEM (~20KW OUTPUT) WITH OPTIONAL OPEN RAISED PLATFORM AS FLEXIBLE COMMUNAL ACTIVITY AREA.
5	<b>SOLAR SAIL WITH ELECTRICAL HUB</b> SOLAR PANEL SYSTEM (~20KW OUTPUT) WITH ELECTRICAL CONTROL UNIT AND 800KW BATTERY BANK.	6	<b>VETIVER GRASS PLANTING LINE</b> NATURE BASED FLOOD MITIGATION AND EROSION PREVENTION SYSTEM. ASSIST WITH SEDIMENT CONTROL AND STORM WATER DECONTAMINATION.	7	<b>COCONUT-BASED STRATA INTERCROPPED HORTICULTURE PLOT (COMMERCIAL PLOT)</b> 24,000M2 COCONUT-BASED INTERCROPPED PLANTING AREA MADE OF 10x10M PLOTS PROVIDING RAW MATERIALS FOR THE PRODUCTION HUB. INITIAL 10x10 PLOT (DEMO PLOT) WILL BE CREATED WITHIN THE PRIMARY SITE AREA.	8	<b>STORM WATER STORAGE AREA</b> 150,000L STORM WATER STORAGE AREA FOR IRRIGATION AND TO SUPPORT FIBRE PROCESSING.



SITE SECTION

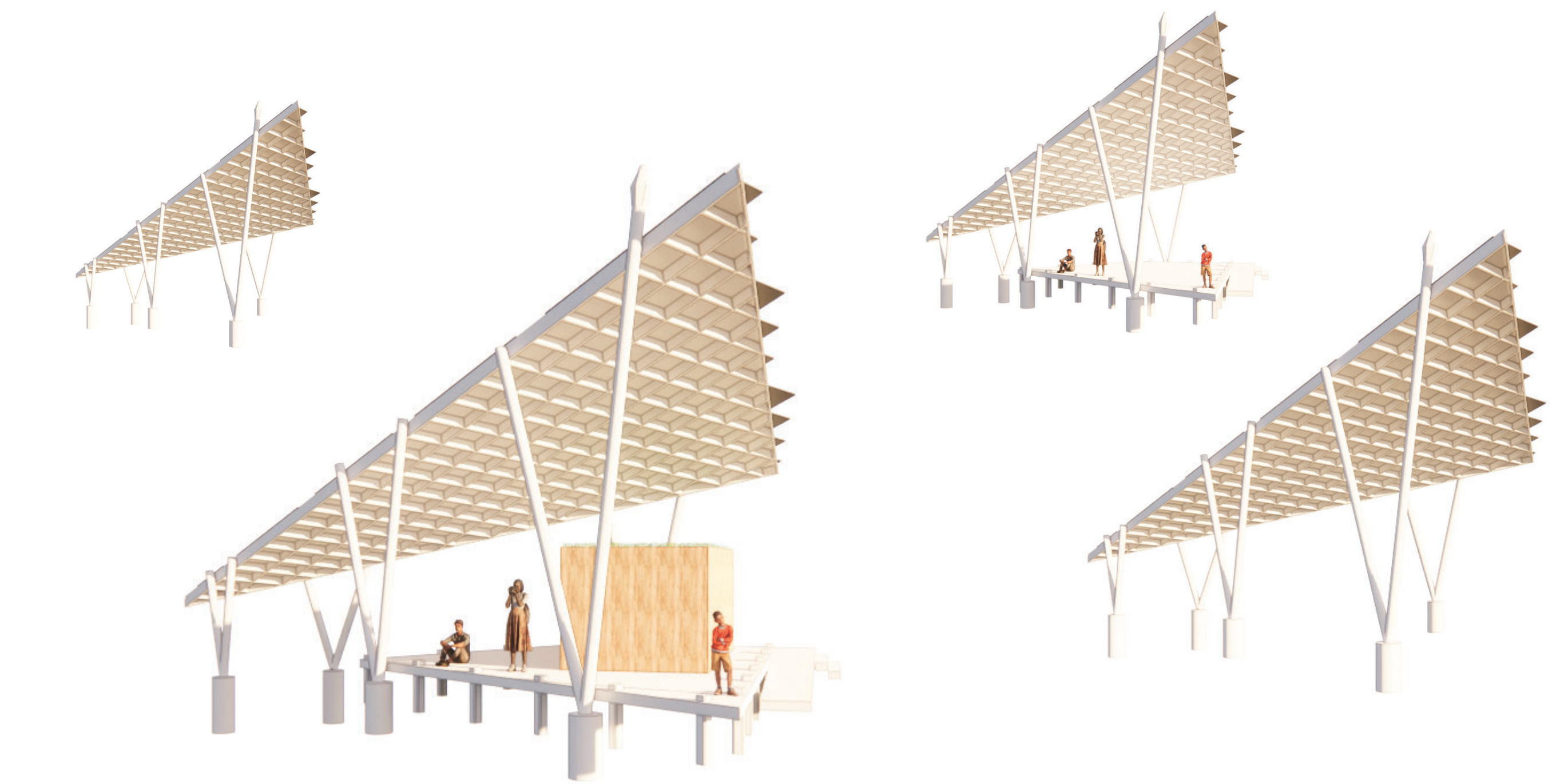

The Drua Fleet Of Energy

OUR DESIGN RESPONDS TO THE LAGI 2025 CHALLENGE THROUGH THE PHYSICAL FORM AND DEEP CULTURAL MEANING OF THE DRUA, FIJI'S ICONIC TRADITIONAL SAILING VESSEL. HISTORICALLY THE LARGEST AND MOST ADVANCED SEA-GOING CANOE IN THE PACIFIC, THE DRUA SYMBOLISES UNITY, INNOVATION, AND RESILIENCE. OUR PROPOSAL REIMAGINES THIS HERITAGE THROUGH A FLEET OF SIX TRIANGULAR LATEEN SOLAR SAILS "NAVIGATING" THE TREETOPS ABOVE MAROU VILLAGE, RESTORING THEIR SILHOUETTE TO THE LANDSCAPE AS FUNCTIONAL ENERGY AND CLEAN WATER GENERATION SYSTEM.

EACH LATEEN SAIL STRUCTURE COMPRISES NATIVE TIMBER AND IS EXTRUDED USING POSTCONSUMER PLASTIC REINFORCED WITH COCONUT COIR, HONOURING FIJIAN MATERIAL TRADITIONS AND CIRCULAR ECONOMY VALUES. THE WOVEN LATTICE EVOKES TRADITIONAL PANDANUS MATS, SUPPORTING PHOTOVOLTAIC PANELS ANGLED FOR OPTIMAL SOLAR EXPOSURE. THE SAILS ARE ELEVATED ABOVE GROUND AND CREATE SHADED PLATFORMS FOR PRODUCTIVE AND COMMUNAL USE. THE SAILS OFFER INTERCONNECTED BENEFITS - ELECTRICITY, CLEAN WATER, FOOD, LEARNING, ENTERPRISE, AND CULTURAL IDENTITY. ALL SIX HARVEST SOLAR ENERGY AND RAINWATER, WITH INTEGRATED SYSTEMS THAT COLLECT, FILTER, AND STORE WATER FOR AGRICULTURE AND VILLAGE NEEDS.

ADJACENT TO EACH SAIL, COCONUT-BASED STRATA INTERCROPPED HORTICULTURE DEMO PLOTS SHOWCASE CLIMATE-RESILIENT FARMING USING COCONUT PITH, RAIN-FED IRRIGATION, AND COMPANION PLANTING. THESE 10x10 METRE PLOTS IMPROVE FOOD SECURITY, SOIL HEALTH, AND BIODIVERSITY WHILE PRODUCING NUTRITIOUS STAPLES AND HIGH-VALUE BOTANICALS. INTEGRATING TRADITIONAL AND MODERN TECHNIQUES REFLECTS THE LINGUISTIC ROOTS OF DRUA—DUA (ONE) AND RUA (TWO)—A UNION OF FORMS MOVING AS ONE.

COMMUNITY EXPERIENCE IS CENTRAL. THE SITE WELCOMES WORKSHOPS, SCHOOL GROUPS, AND VISITOR TOURS, ACTING AS A LEARNING LANDSCAPE AND PUBLIC GATHERING SPACE. THE LATEEN SAILS THEMSELVES BECOME ICONIC LANDMARKS—ROOTED IN THE PAST YET POINTING TOWARD A REGENERATIVE FUTURE UTILISING APPROPRIATE TECHNOLOGY.

AT ITS HEART, THE DRUA SAILS ARE MORE THAN INFRASTRUCTURE—THEY ARE LIVING SYMBOLS OF MOVEMENT, DISCOVERY, AND TRANSFORMATION. MAROU BECOMES A GUARDIAN OF ANCESTRAL INNOVATION AND A BEACON OF REGENERATIVE DESIGN FOR ISLAND COMMUNITIES ACROSS THE PACIFIC AND BEYOND.



SITE AERIAL VIEW