

#### Weave of Natural Fibers Connecting the Petals

At the highest layer, woven palm fronds, coconut fibers, and traditional materials connect the petals, reinforcing breathability, passive cooling, and cultural symbolism. This interlaced canopy serves as a functional and poetic expression of unity, ensuring shade, airflow, and strength.

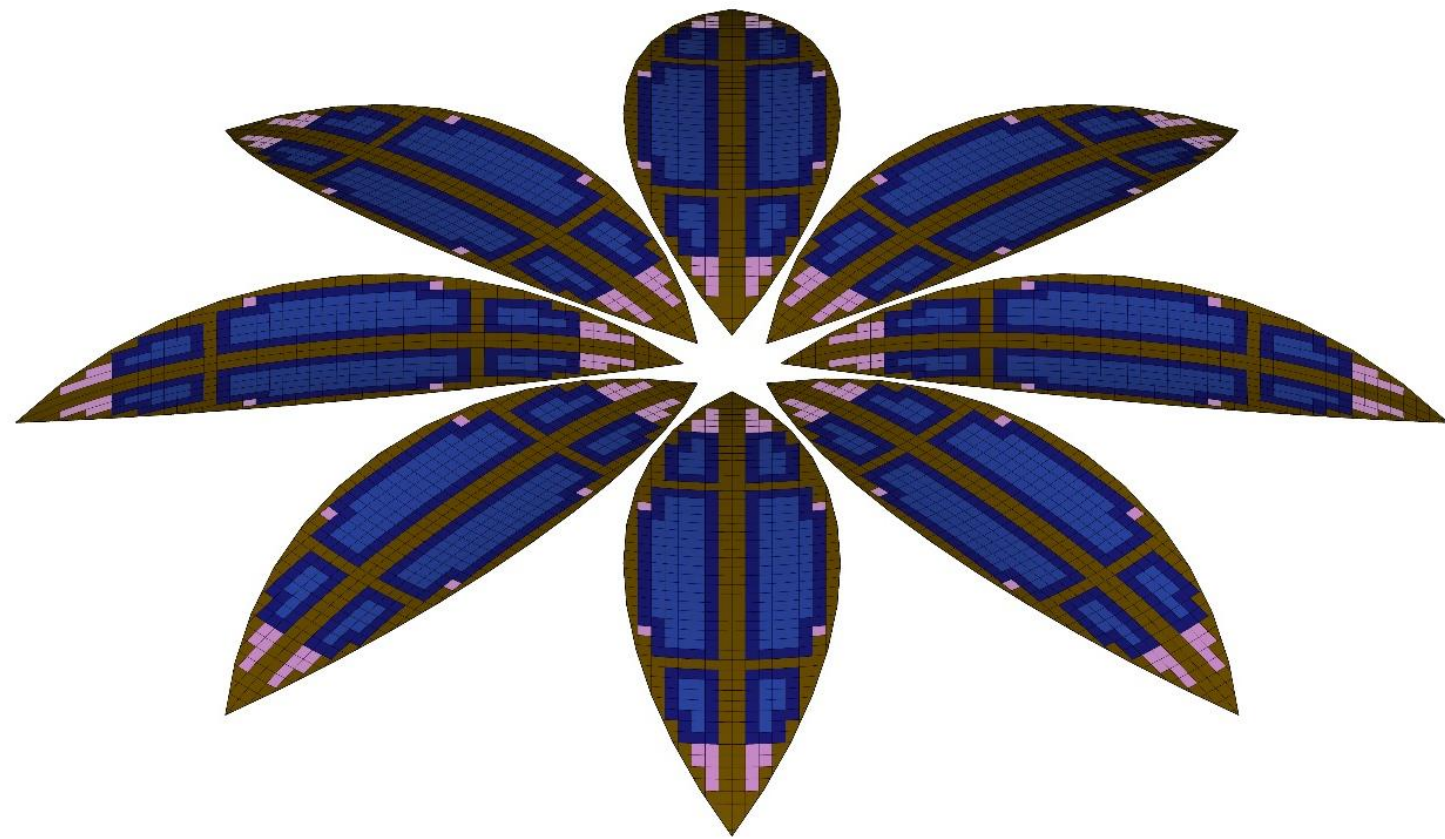

#### Petals with Solar-Integrated Tensile Fabric

Each of the eight petals is formed with tensile fabric embedded with photovoltaic panels, generating 100 MWh annually. The lightweight, high-strength fabric allows for solar integration while ensuring shading and cooling beneath the canopy. The self-sustaining energy system provides power for lighting, water pumping, and essential community functions.

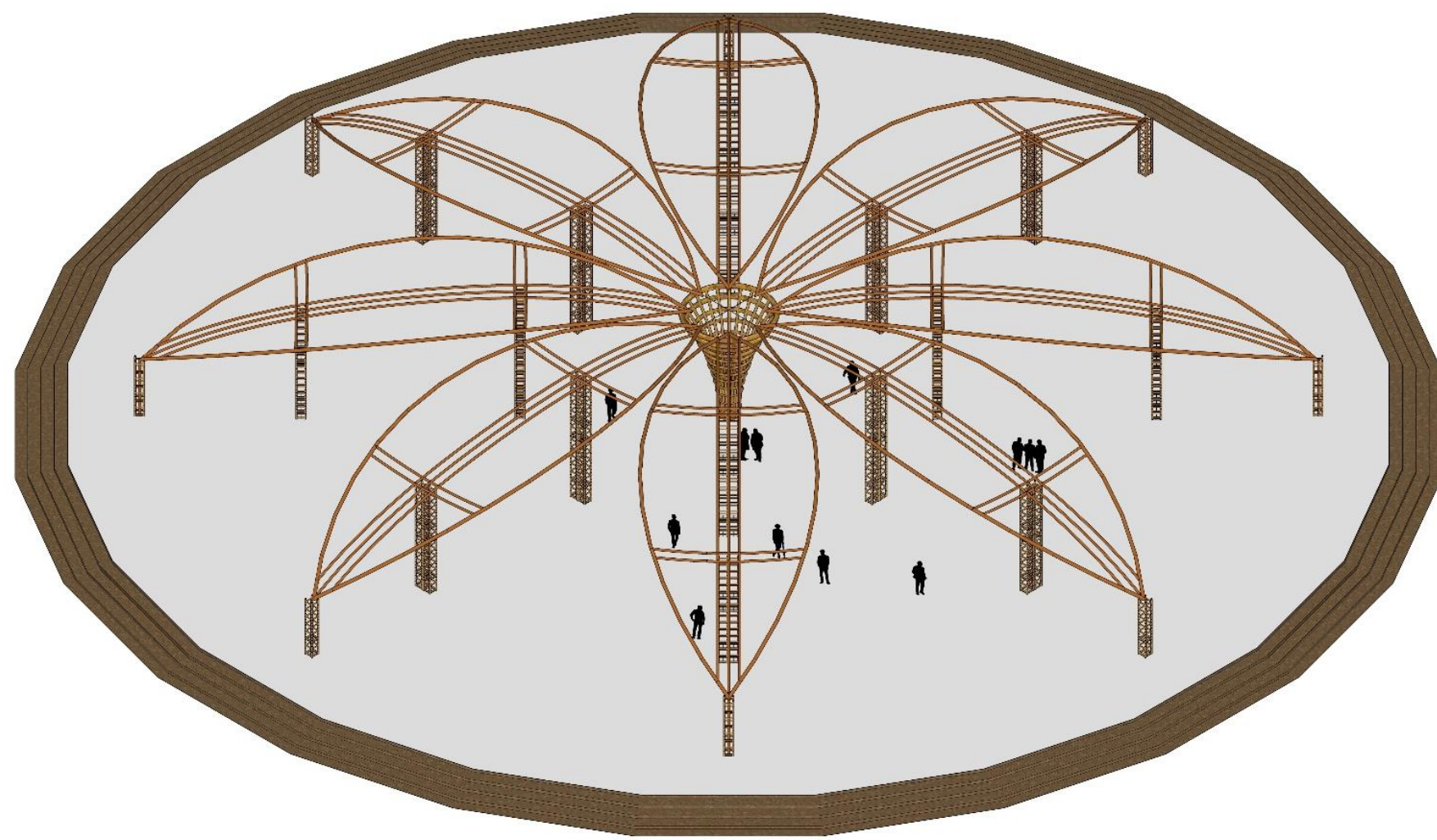

#### Base Bamboo Structure & Joineries

The foundation of A Celestial Weave is a pre-tensioned bamboo framework, chosen for its strength, flexibility, and sustainability. Precision-crafted joineries ensure load distribution and durability, allowing for easy on-site assembly by local artisans using traditional interlocking methods. This natural structure provides stability while blending seamlessly with the landscape.

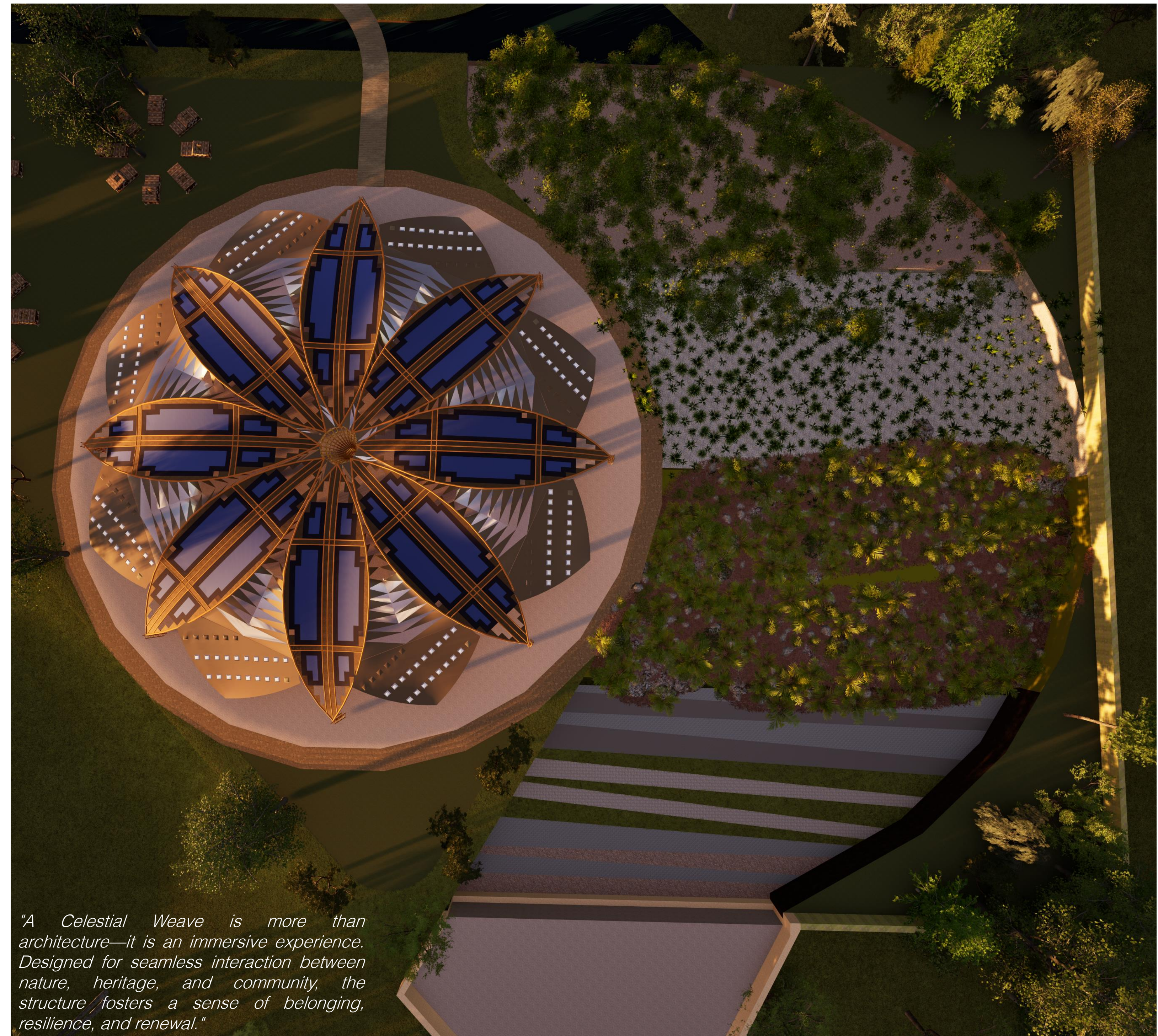

*"A Celestial Weave is more than architecture—it is an immersive experience. Designed for seamless interaction between nature, heritage, and community, the structure fosters a sense of belonging, resilience, and renewal."*

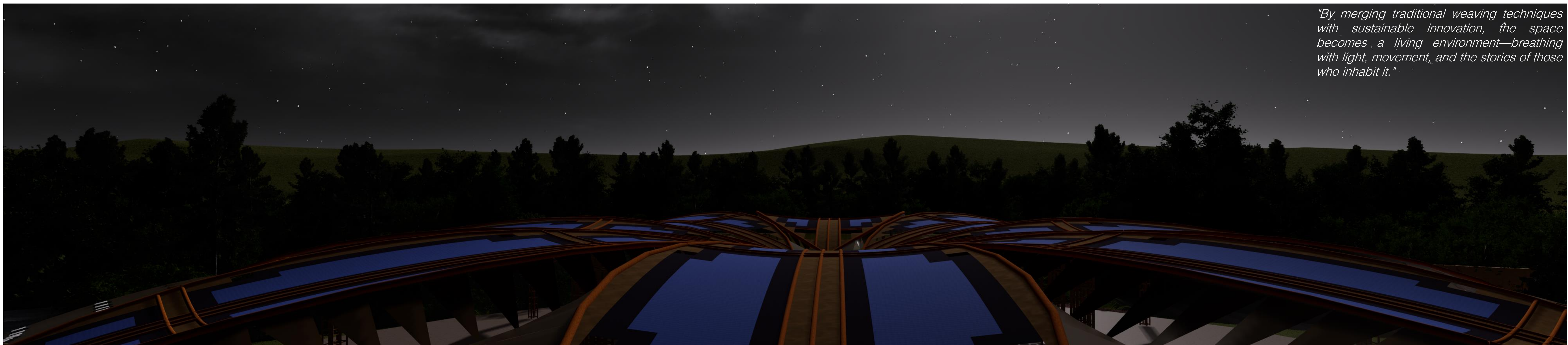

*"By merging traditional weaving techniques with sustainable innovation, the space becomes a living environment—breathing with light, movement, and the stories of those who inhabit it."*