

Research

Traditional Masi inspired community space and gardens



Solar Garden

Garden

Community Space
Timber and steel centre structure can be divided into four spaces by partitions

Deck

Water Channels
Rain water harvesting from channels and solar gardens



Solar Stars

Covered Walkways
Additional solar on walkway roof

Textile Canopy
Woven matting, thatching or Masi inspired painted cloth

Stairs

Painted or Stained Flowers

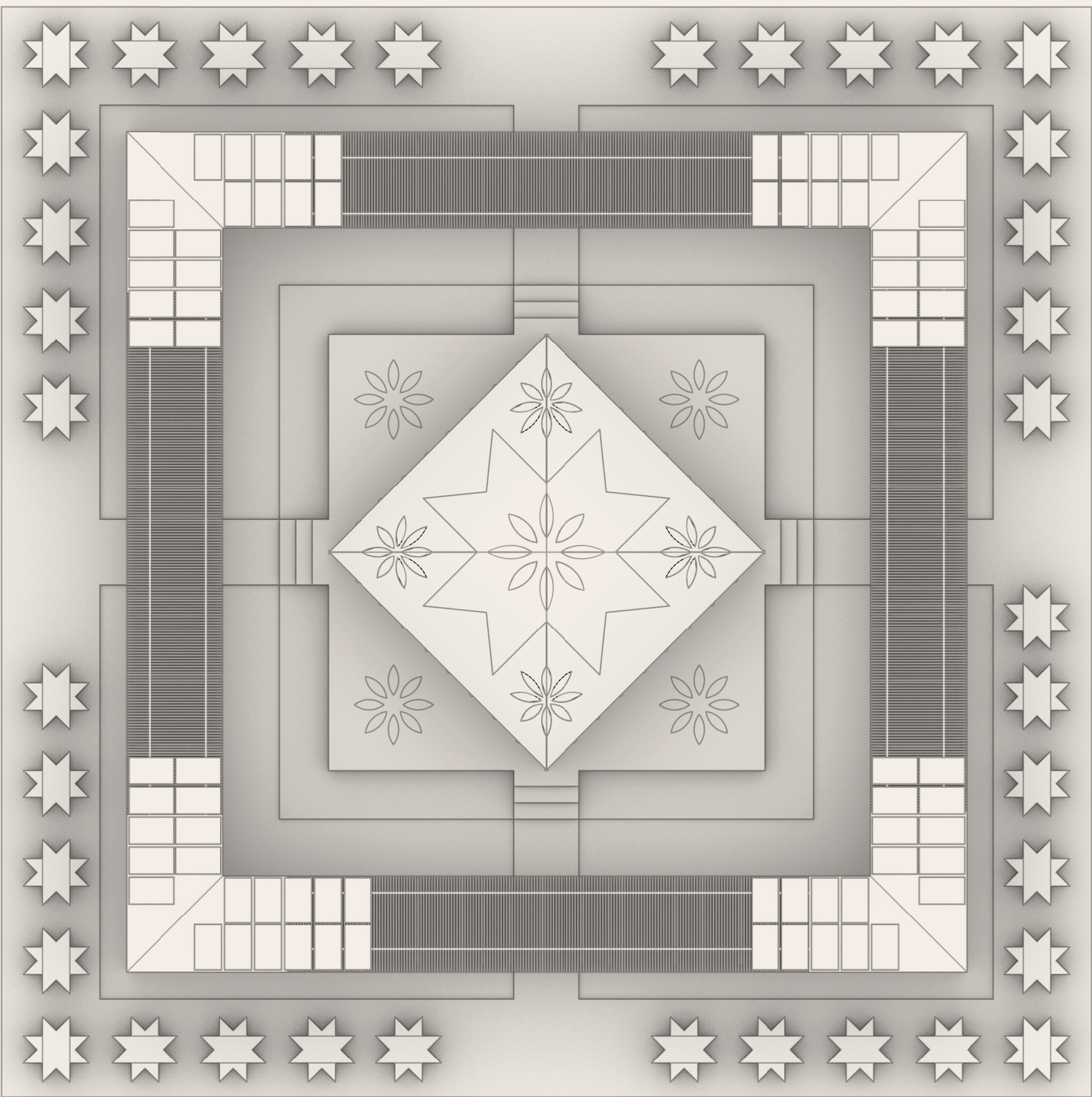
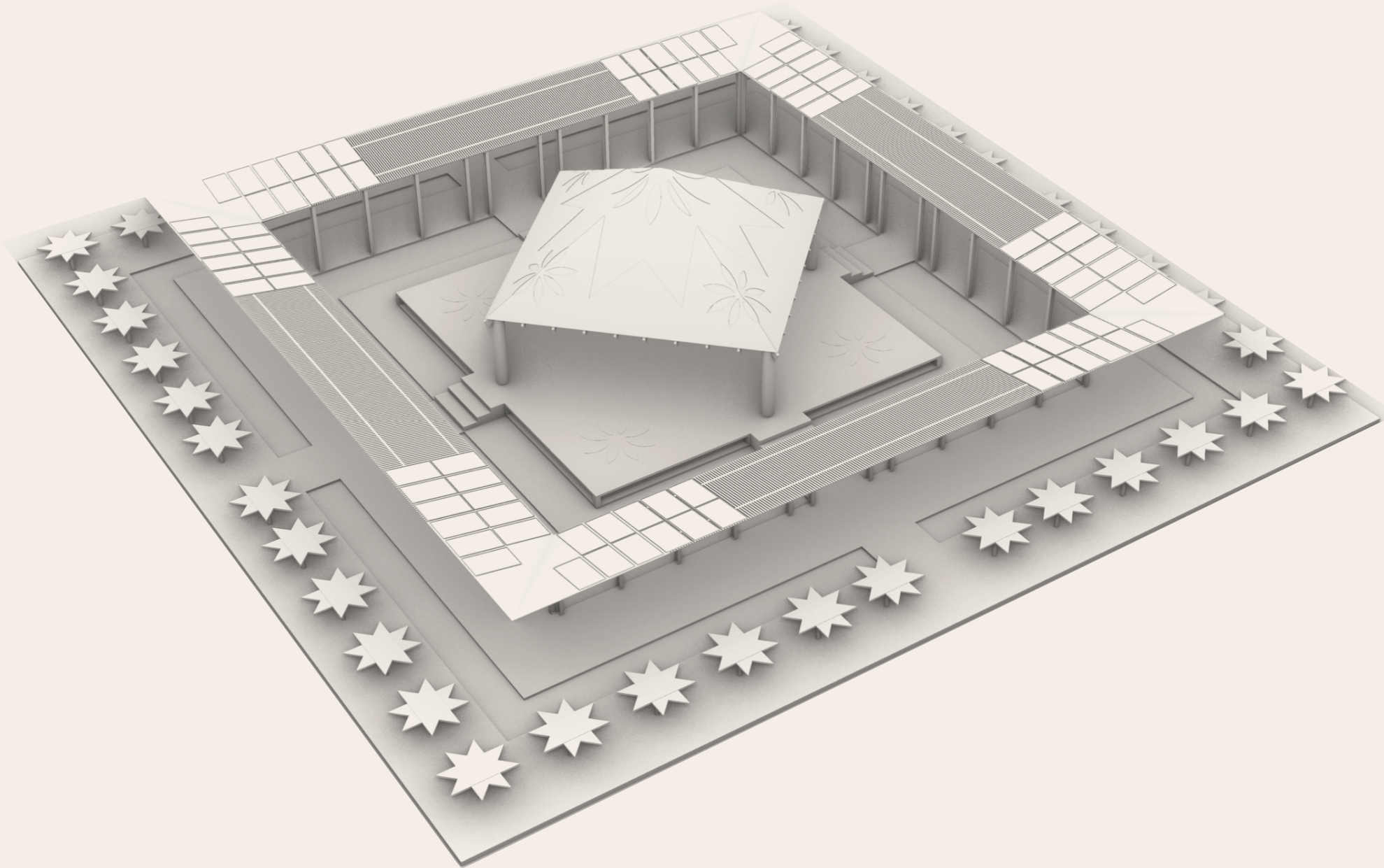

Reference inspiration: risebeyondthereef.org

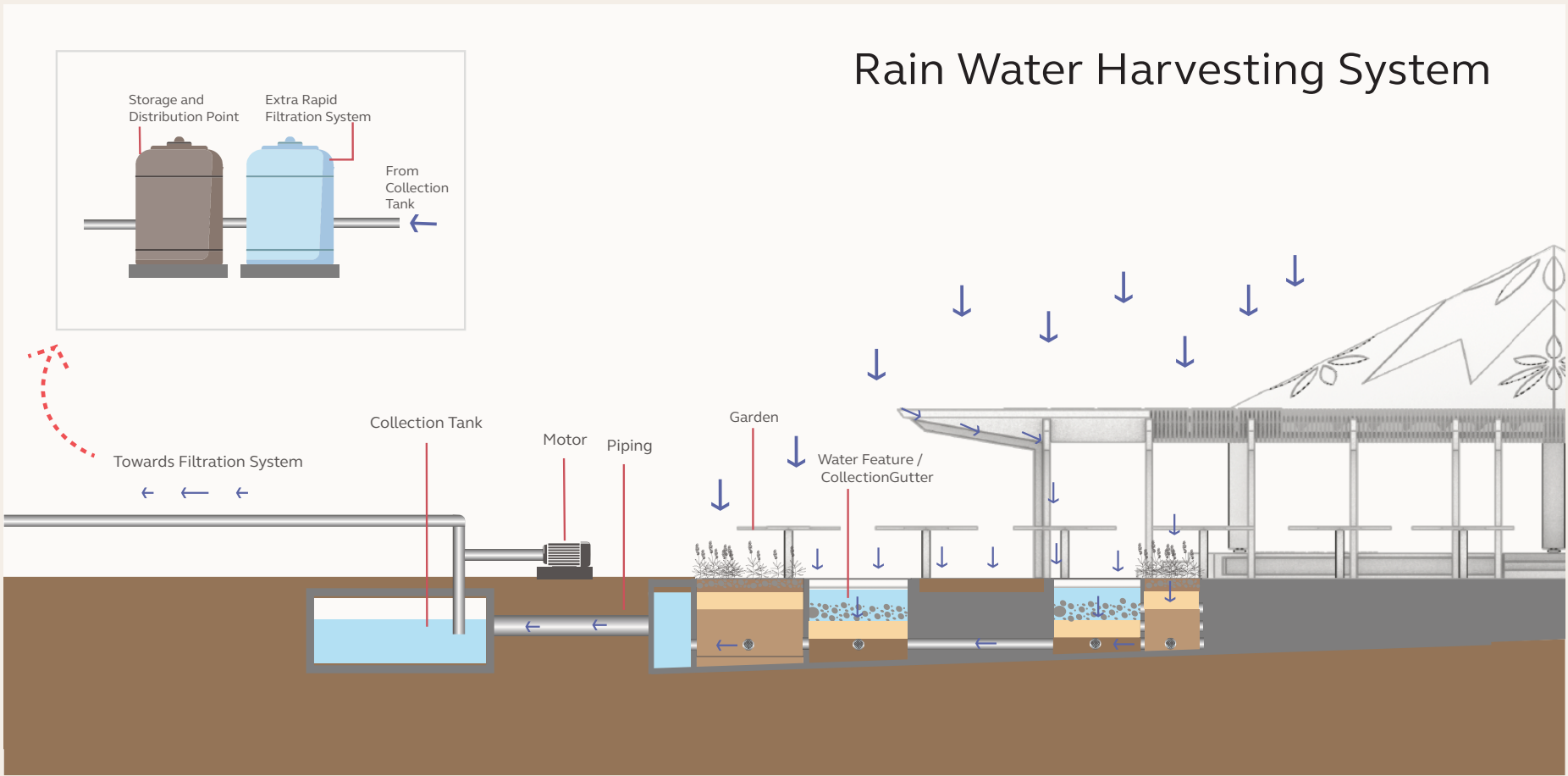

Our concept for the **LAGI 2025 Fiji** project emerged from extensive research into the cultural, environmental, and functional needs of Marou Village on Naviti Island. We studied the structure and symbolism of traditional Masi shape to inform our layout, ensuring the space resonates with Fijian cultural identity.

We also analysed Marou’s unique climate challenges, including rising sea levels and increasing cyclone intensity. This led us to prioritise resilience, low-impact materials, and simple systems that could be maintained locally.

Our research extended to sustainable energy and water solutions, focusing on how solar power and rainwater harvesting could be integrated into a shared community space without disrupting the land. This foundation shaped a design that is both respectful of place and responsive to future needs that we named **Masi Siga Garden**.

