

FUNCTIONALITY AND MATERIALITY

The design proposal emphasizes the use of local materials and encourages active participation from the villagers of Marou Village. This approach aims to foster a sense of ownership and reduce the carbon footprint associated with material transportation.

LOCAL BASED MATERIAL

Utilize local material that is already available on and around the site.

- CLAY RAIN WATER CATCHER
- COCONUT FIBER WATER FILTER
- LIME AND BEACHSAND PLASTER
- BAMBOO ROOF AND WALL STRUCTURE
- COCONUT WOOD INSTALLATION STRUCTURE
- LOCAL STONE INSTALLATION BASE FOUNDATION



WEAVING SKILL

Fijian people are known for their weaving skills. This design proposal integrates this traditional art into the installation features, particularly in the design of the roof and bamboo wall partitions.

TERRACOTTA COOLING SYSTEM

Two of the installation mounting units function as powerhouse units, storing electricity generated from the area. This building is also intended to serve as a storage space for local fishery products. Therefore, it is crucial to maintain a sufficiently cold environment. We propose a natural cooling system using terracotta pots as the wall material.

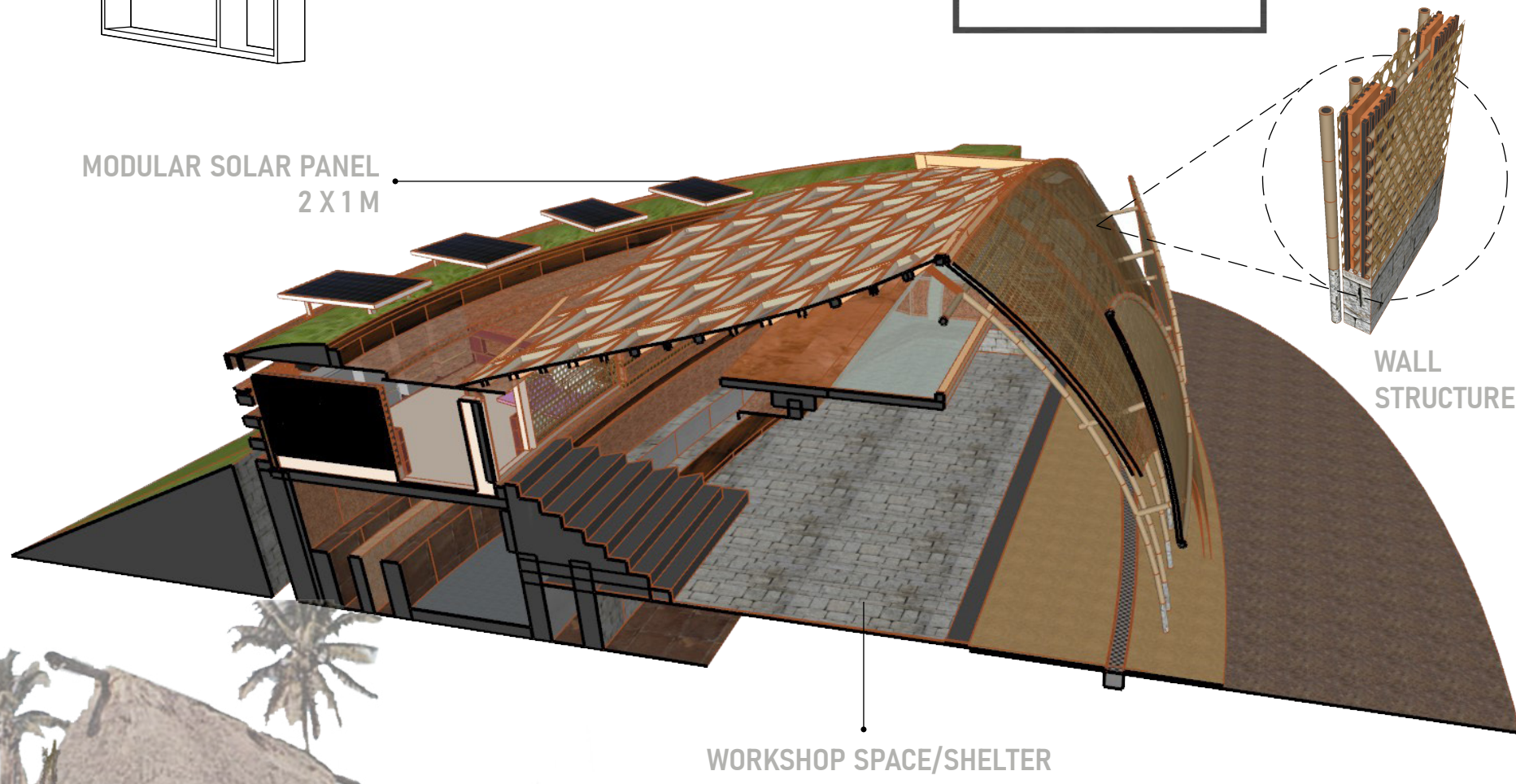
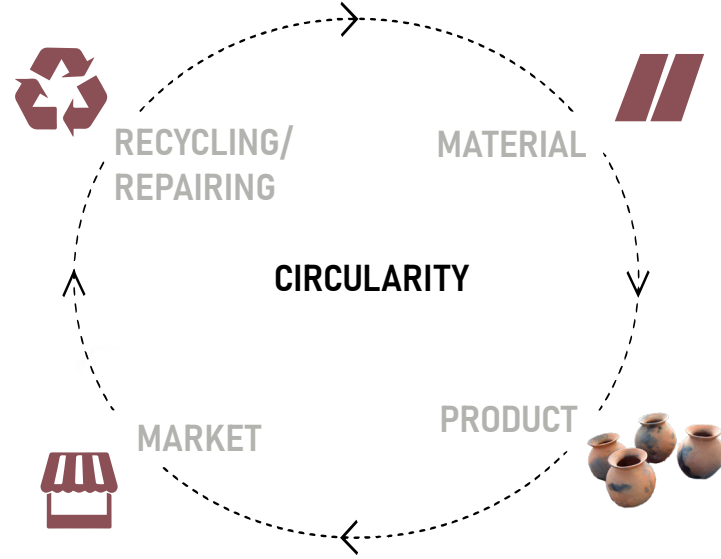
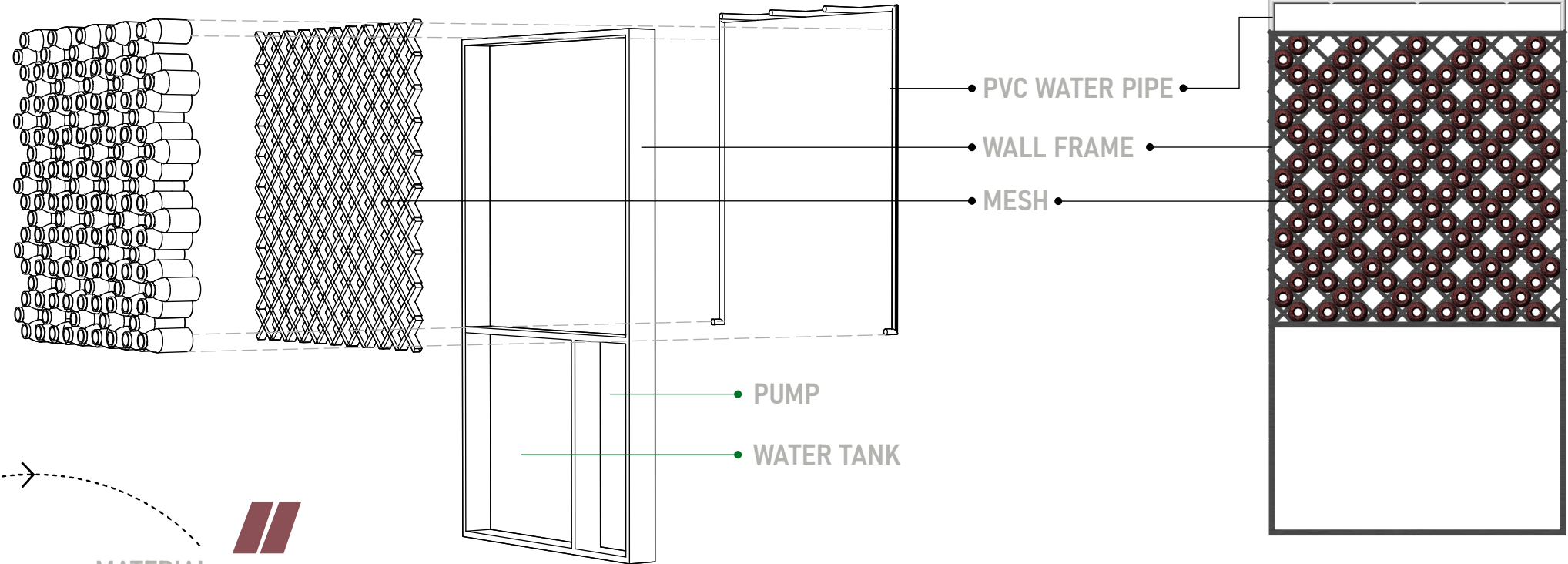
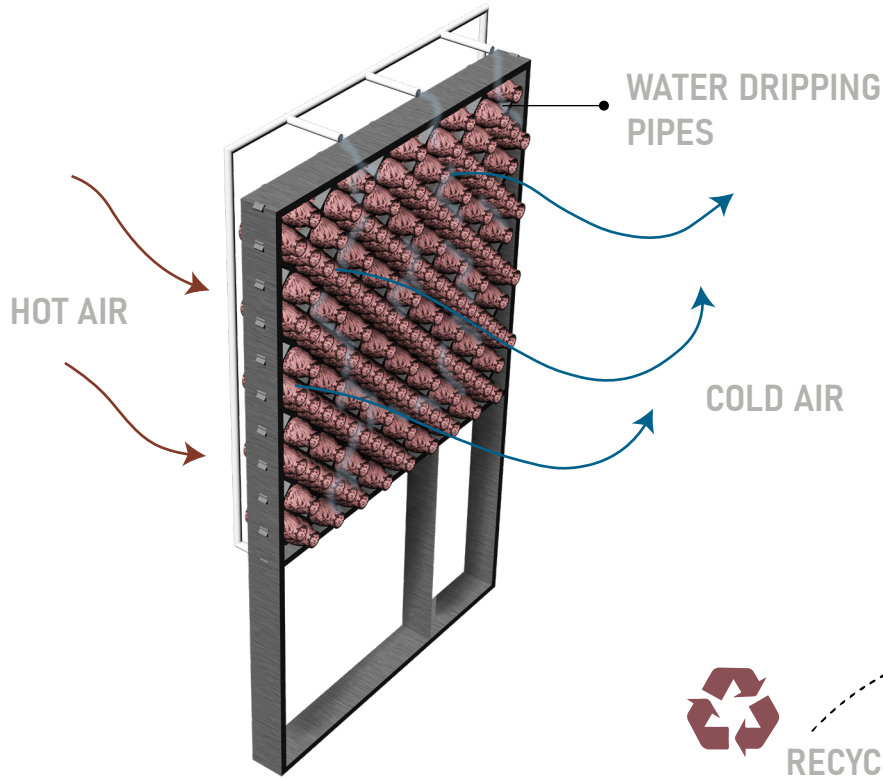

POWER HOUSE SECTION

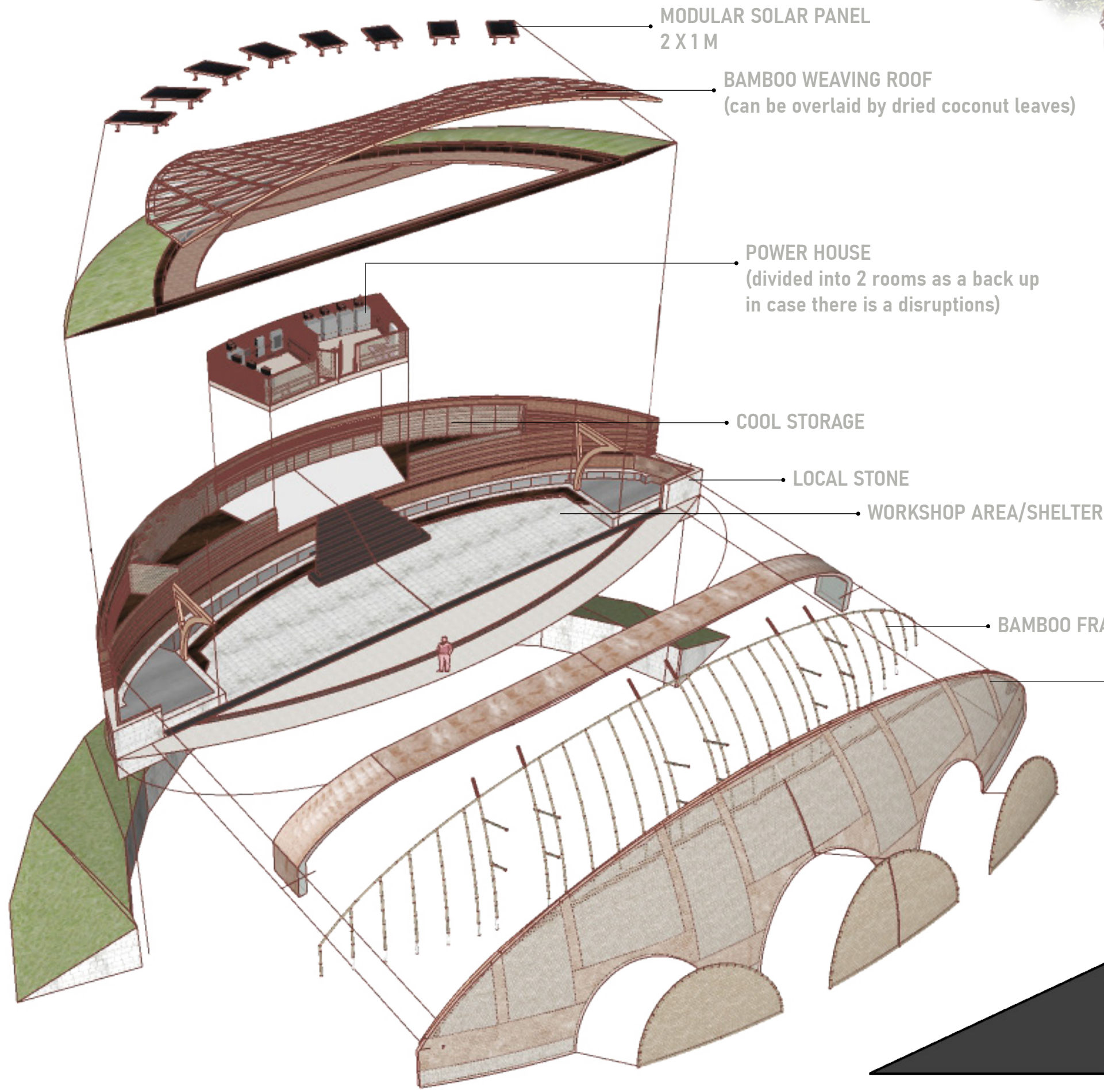

POTTERY SKILL

Pottery skills are integrated into the wall partitions, forming part of the terracotta cooling system. Furthermore, the construction of the wall involves collaboration with the local community, who will assist in preparing and applying the clay and lime mixtures.



POTTERY SKILL

DANCING ART PERFORMANCE

Fiji, particularly Marou Village, is proposed as a tourism destination. The space we are designing is part of a landscape-oriented project that includes an adaptive amphitheatre. This amphitheatre can be used by the local community for performances and, in the event of flooding, can function as a bio-retention area.



FISHING STORAGE

Fish storage is essential in Marou Village, as most of the locals are fishermen. The installation functions not only as a powerhouse but also as a fish storage facility, integrating terracotta cooling technology into a single unit.

POWER HOUSE SECTION

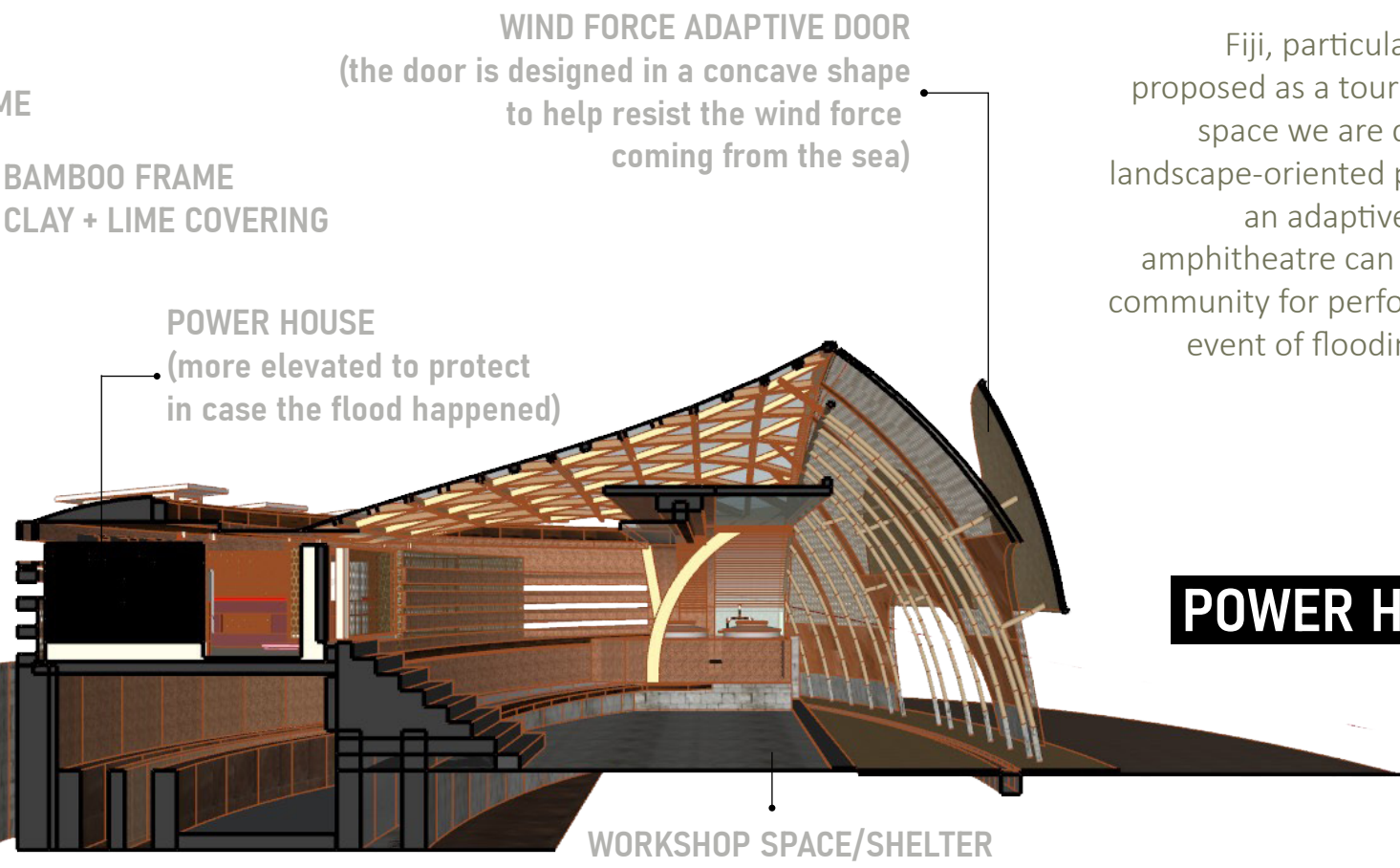

CONCLUSION

Overall, Oasis Farm Kereke is a co-creation that fosters a resilient, inclusive, and vibrant environment, aimed at delivering long-term benefits to the community. It strengthens local capacity in cassava food production, promotes the use of Fijian earth materials, embraces adaptive construction technologies, and preserves traditional art and cultural practices.

