

Source of Life is Sun.  
 Source of Art is Inspiration.  
 Source of Architecture is Space.  
 Source of Tradition is Culture.  
 Source of Complexity is Simplicity.

Heaven to Earth Art Installation taps into sources of solar energy and human knowledge in order to provide a simple and powerful example. Example of urban art that seamlessly merges technological progress and cultural tradition.

New archetype is created - solar power plant and shaded public plaza combined in one harmonic piece. It becomes an instant new landmark where people can freely meet, relax, discuss, learn, enjoy, experience urban life.

Metered rhythms of arches and domes resemble both ancient spiritual places and new industrial marvels. Carefully proportioned roof openings let the sunlight flood the structure. Its intricate patterns inspired by Kufi calligraphy and traditional Arabic writing dissolve it into ever changing delicate play of gentle light and shadows like in a magic forest.

Installation's structural concept is simple: unit module 12 by 12 metres is repeated to cover almost the entire site in order to harvest maximum energy and effectively shade the plaza underneath. Module's domed roof is clad in monocrystalline PV panels to harvest solar energy and transform it into electricity. Two larger courtyards measuring 24 by 24 metres feature advanced concentrated PV arrays with parabolic mirrors for maximum efficiency.

Heaven to Earth Art Installation celebrates timeless qualities of tradition, surprise of artistic expression and the promising sustainability of new technologies. It is part of the human quest for deeper knowledge and better life in harmony with nature.

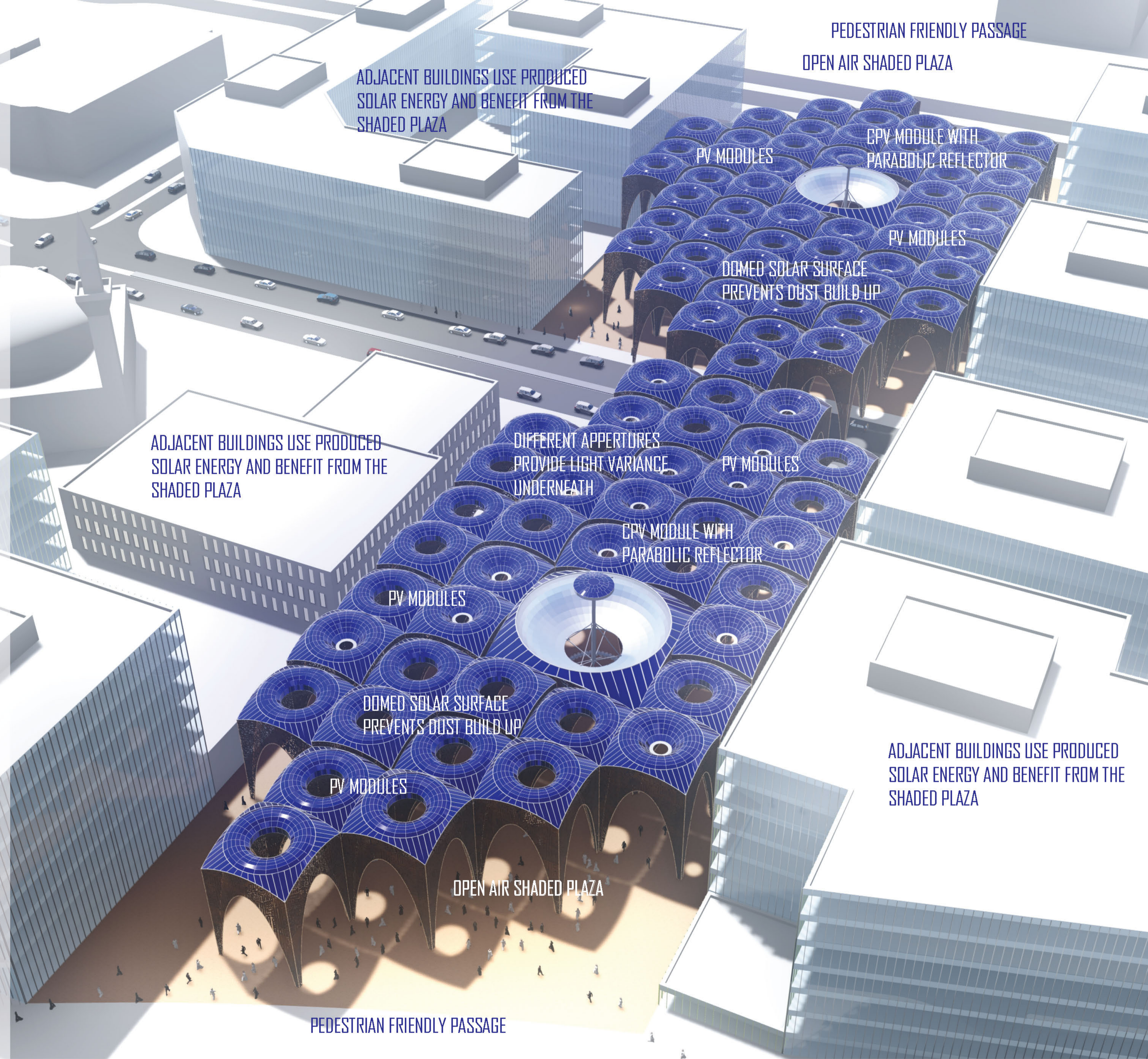

**CAPACITY**

PV MODULES: <b>100</b>	CPV MODULES: <b>2</b>
CAPACITY EACH: <b>24 kW</b>	CAPACITY EACH: <b>50 kW</b>

TOTAL CAPACITY:  
**2.5 MW**

DAILY OUTPUT:  
**15 MWh**

ANNUAL OUTPUT:  
**5.5 GWh**

**COST**  
 CONSTRUCTION BUDGET  
**\$25 M**

COST PER WATT:  
**\$10**

**RETURN**  
 YEARS  
**15-20**

# HEAVEN TO EARTH

## ART INSTALLATION

