

Emirates Pathway

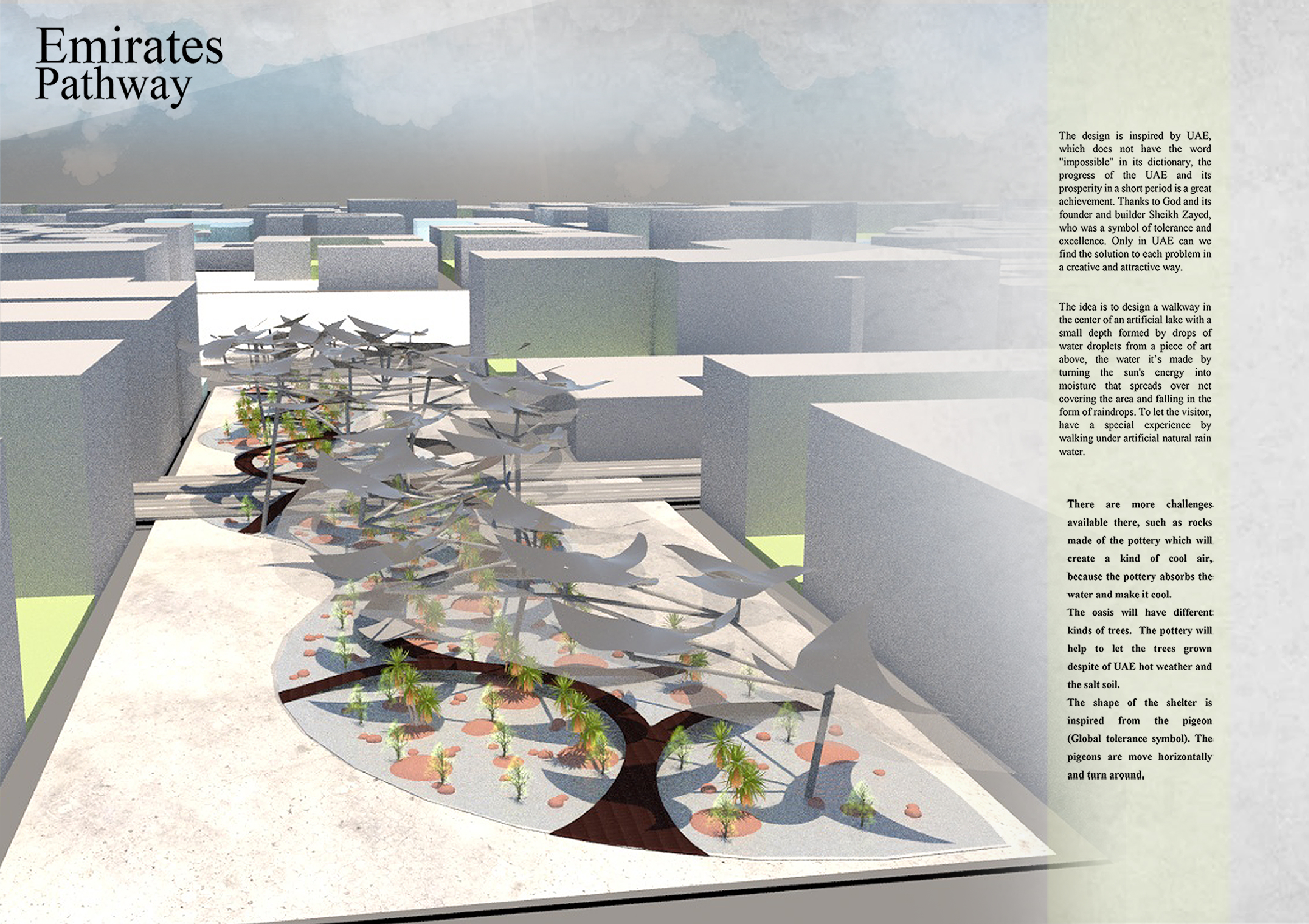

The design is inspired by UAE, which does not have the word "impossible" in its dictionary, the progress of the UAE and its prosperity in a short period is a great achievement. Thanks to God and its founder and builder Sheikh Zayed, who was a symbol of tolerance and excellence. Only in UAE can we find the solution to each problem in a creative and attractive way.

The idea is to design a walkway in the center of an artificial lake with a small depth formed by drops of water droplets from a piece of art above, the water it's made by turning the sun's energy into moisture that spreads over net covering the area and falling in the form of raindrops. To let the visitor, have a special experience by walking under artificial natural rain water.

There are more challenges available there, such as rocks made of the pottery which will create a kind of cool air, because the pottery absorbs the water and make it cool.

The oasis will have different kinds of trees. The pottery will help to let the trees grown despite of UAE hot weather and the salt soil.

The shape of the shelter is inspired from the pigeon (Global tolerance symbol). The pigeons are move horizontally and turn around.