

## ACCESS & LINKAGES

Integration Of The Work Into The Surrounding Environment And Landscape

You can judge the accessibility of a place by its connections to its surroundings, both visual and physical. A successful public space is easy to get to and get through; it is visible both from a distance and up close. The edges of a space are important as well. (Source: Project for Public Space)

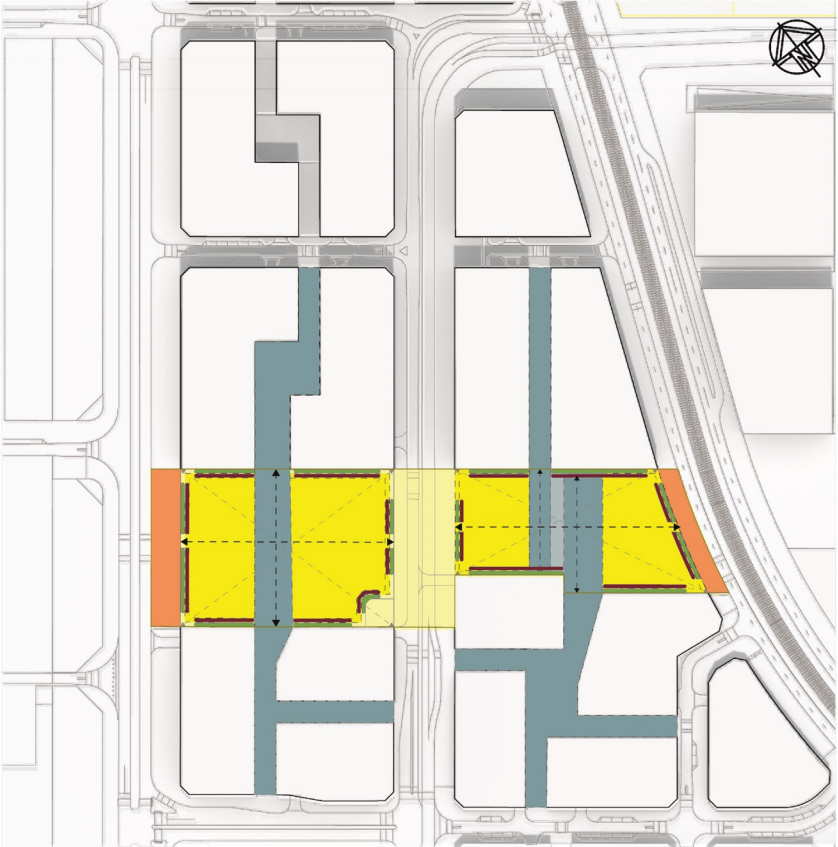
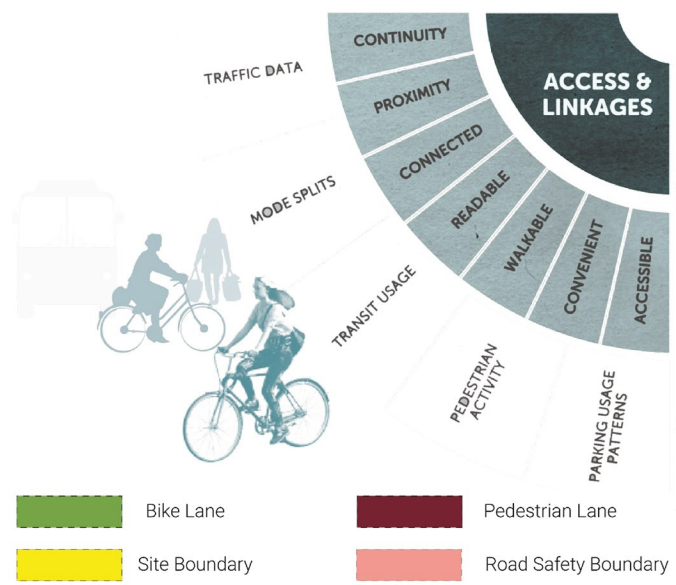

## ACCESS & LINKAGES

Integration Of The Work Into The Surrounding Environment And Landscape

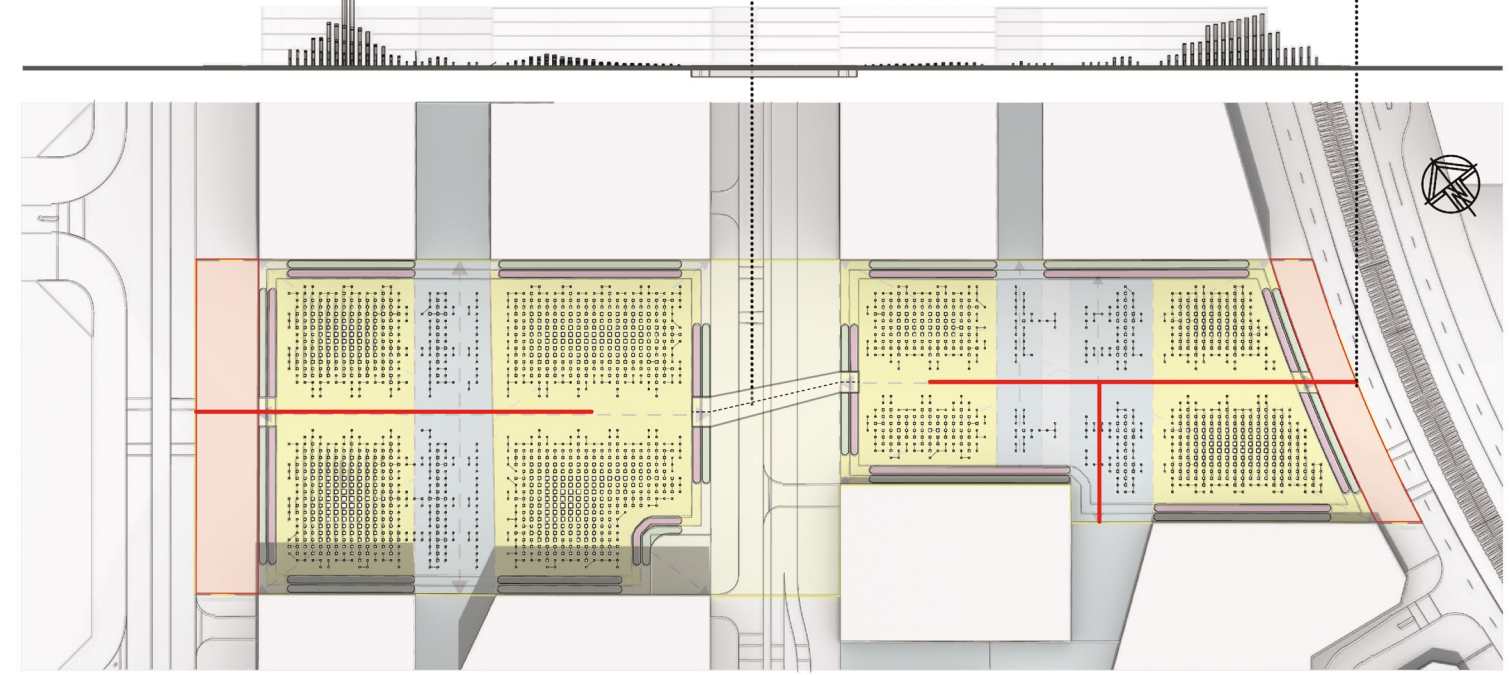

## COMFORT & IMAGE

The sensitivity of the work to the environment, and to local, and regional ecosystems

Whether space is comfortable and presents itself well is key to its success. Comfort includes perceptions about safety, cleanliness, and the availability of places to sit - the importance of offering people the choice to sit where they want is generally underestimated. (Source: Project for Public Space)

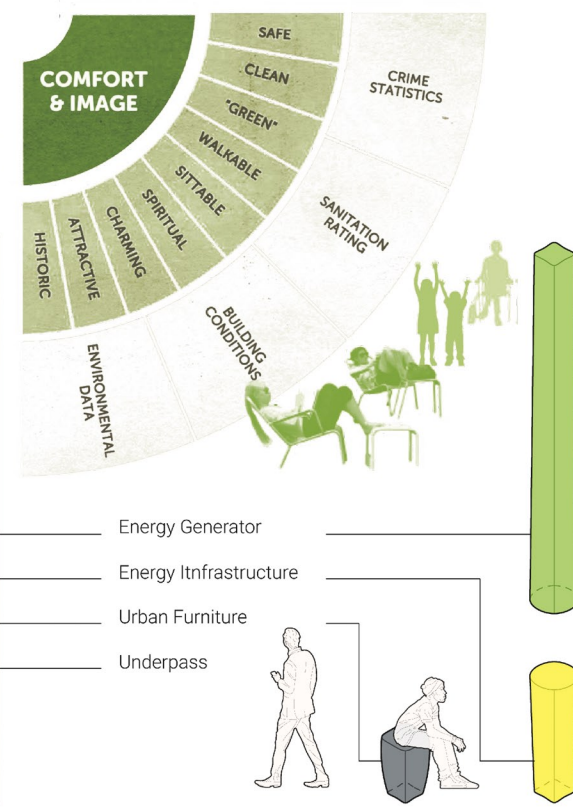
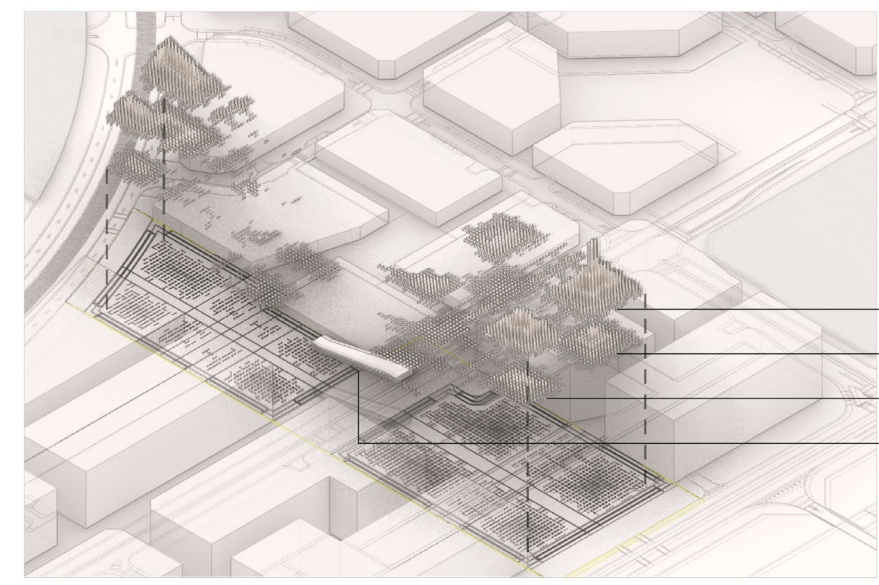

## COMFORT & IMAGE

The sensitivity of the work to the environment, and to local, and regional ecosystems

Thermal comfort is the condition of mind that expresses satisfaction with the thermal environment and is assessed by subjective evaluation (ANSI/ASHRAE Standard 55).

