

The reflective canopy overlays the park and forms an open pergola. Its geometry recalls the dynamic pattern of the traditional sunscreen of arabian architecture and acts as a filter to protect the visitors from the sun. The mirrors, varying their inclination, ensure shade and protection from solar radiation. The rotation of the reflectors create a constantly mutating atmosphere with a vibrant play of lights and shadows.

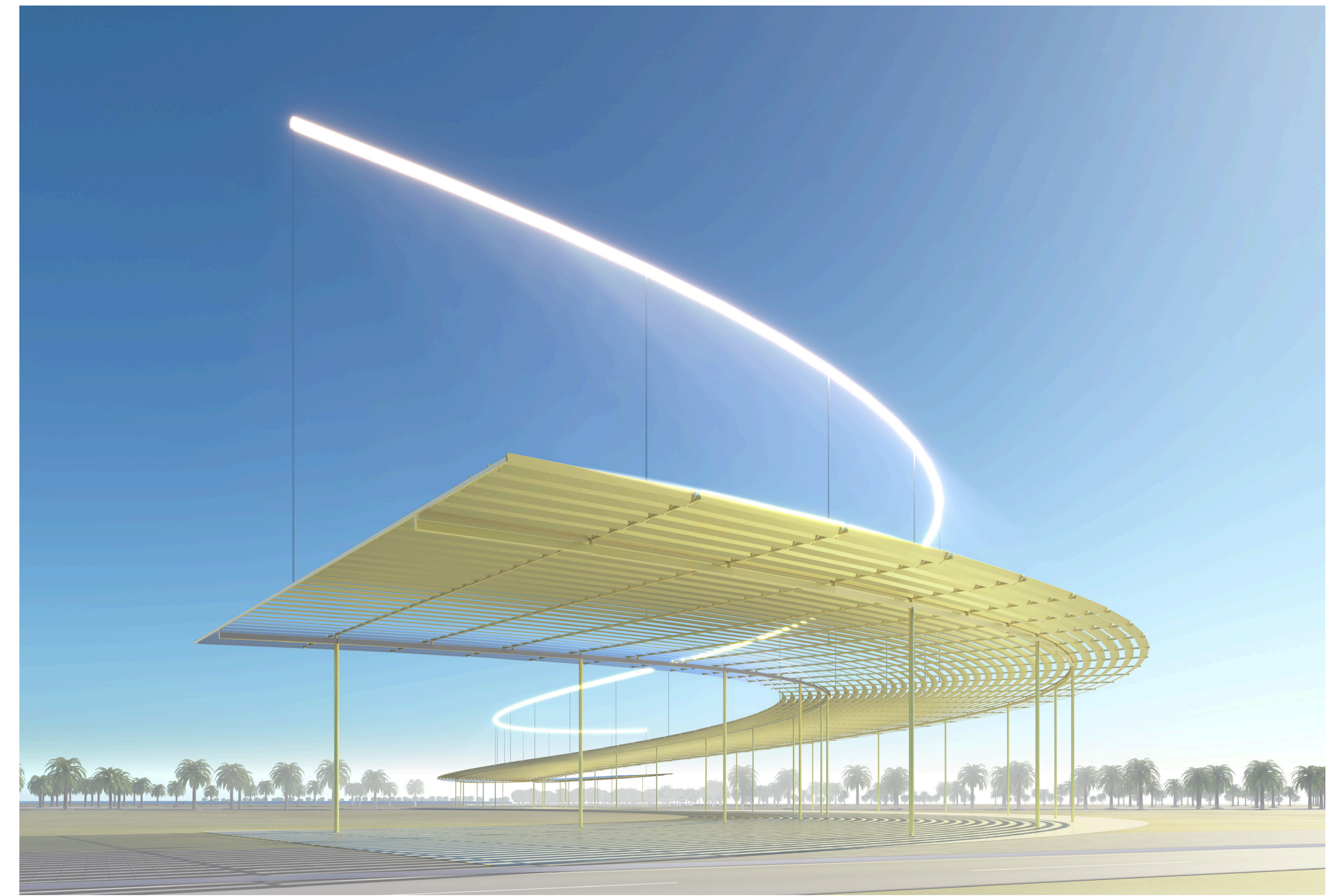

The covered pedestrian walkway offers a new place of socialization and recreation under which it is possible to walk, relax or organize events in a comfortable climate. A new comfortable outdoor space in wich tradition and innovation convey in complete respect of the local anthropological (i.e. cultural) habits, to give life to a singularly suggestive *S-PARK*.

