

Side Elevation 1

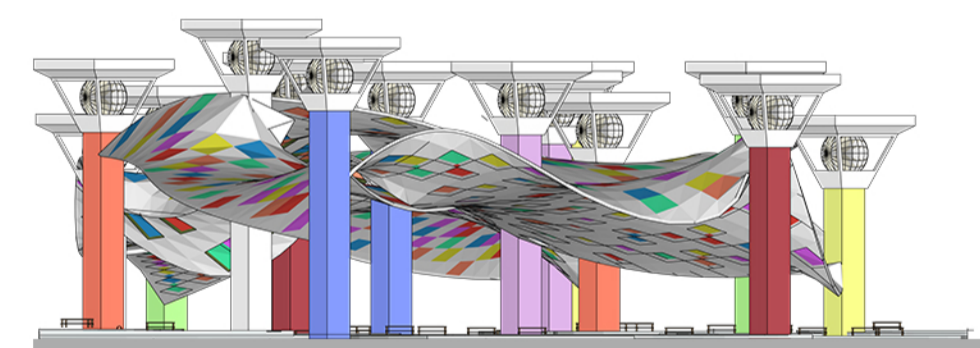

Front Elevation

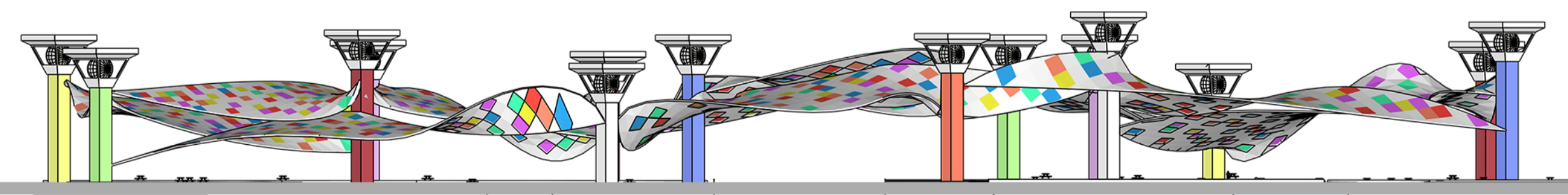

Side Elevation 2

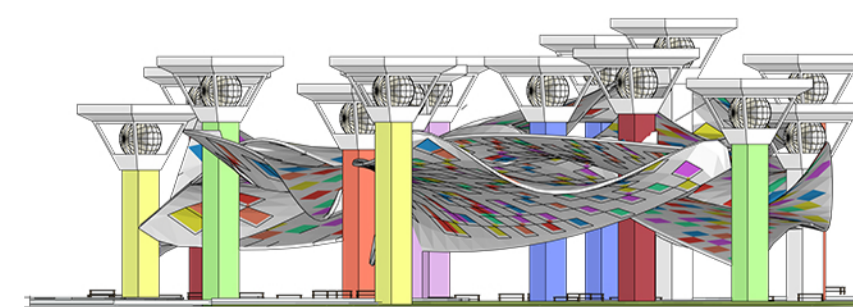

Back Elevation

**As far the environmental strategies suggested in the design (3000)m sq of solar cell panels:**

- semi-transparent solar panels are integrated in the shelters and stored into the energy storing towers, Then used to provide the adjacent buildings with electricity.
- The second passive strategy in passive cooling which is provided through
- The wind towers which transmit cool air into the area and also transmitted through Ground pipes to the adjacent buildings.