

UPLIFTING

Masdar CITY مدينة مسقط

RETURN TO THE SOURCE

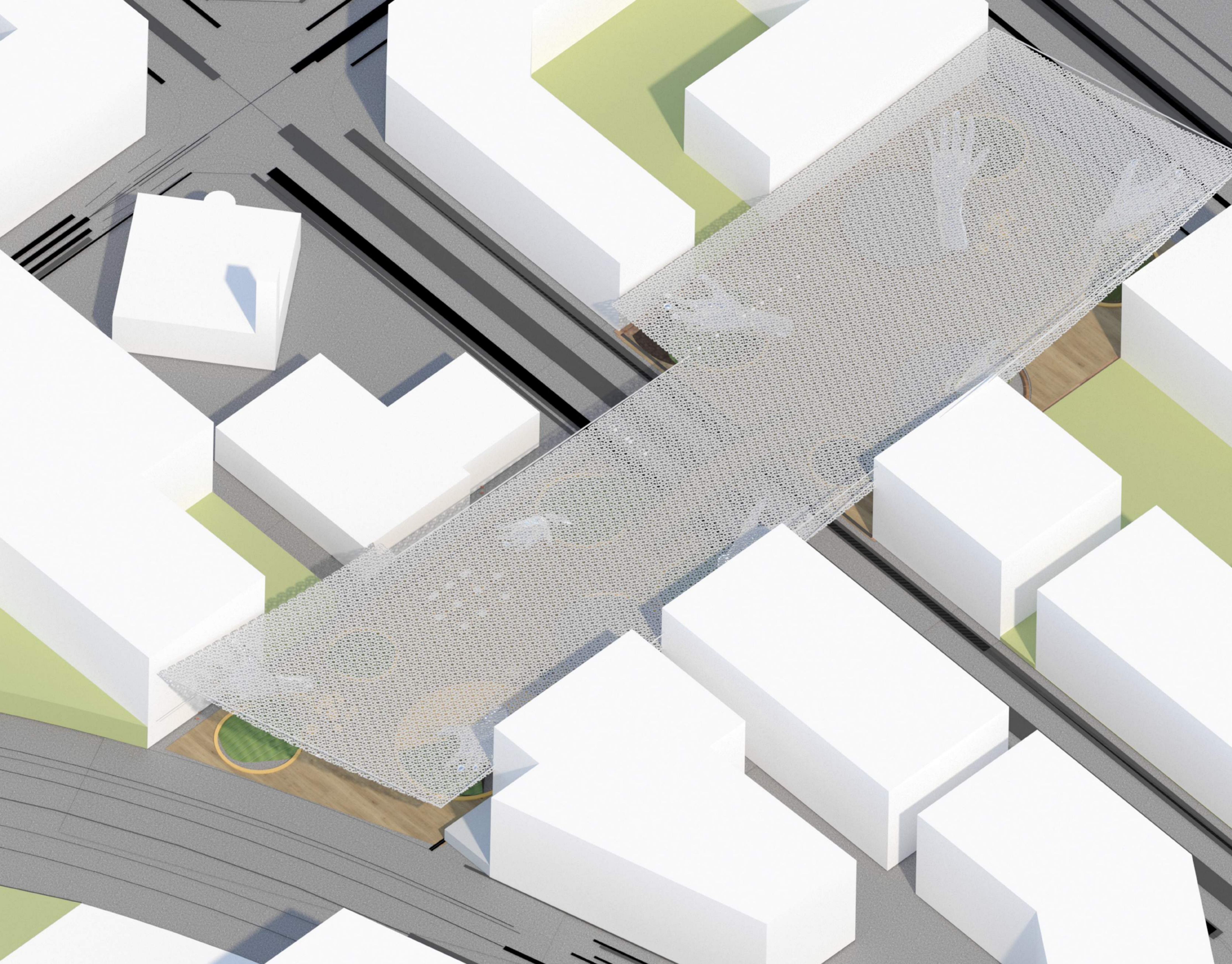

1) SHELL-MASHRABIA IS MADE OF RECYCLED ALLUMINIUM WITH INSTALLED OPV SOLAR CELLS ON IT

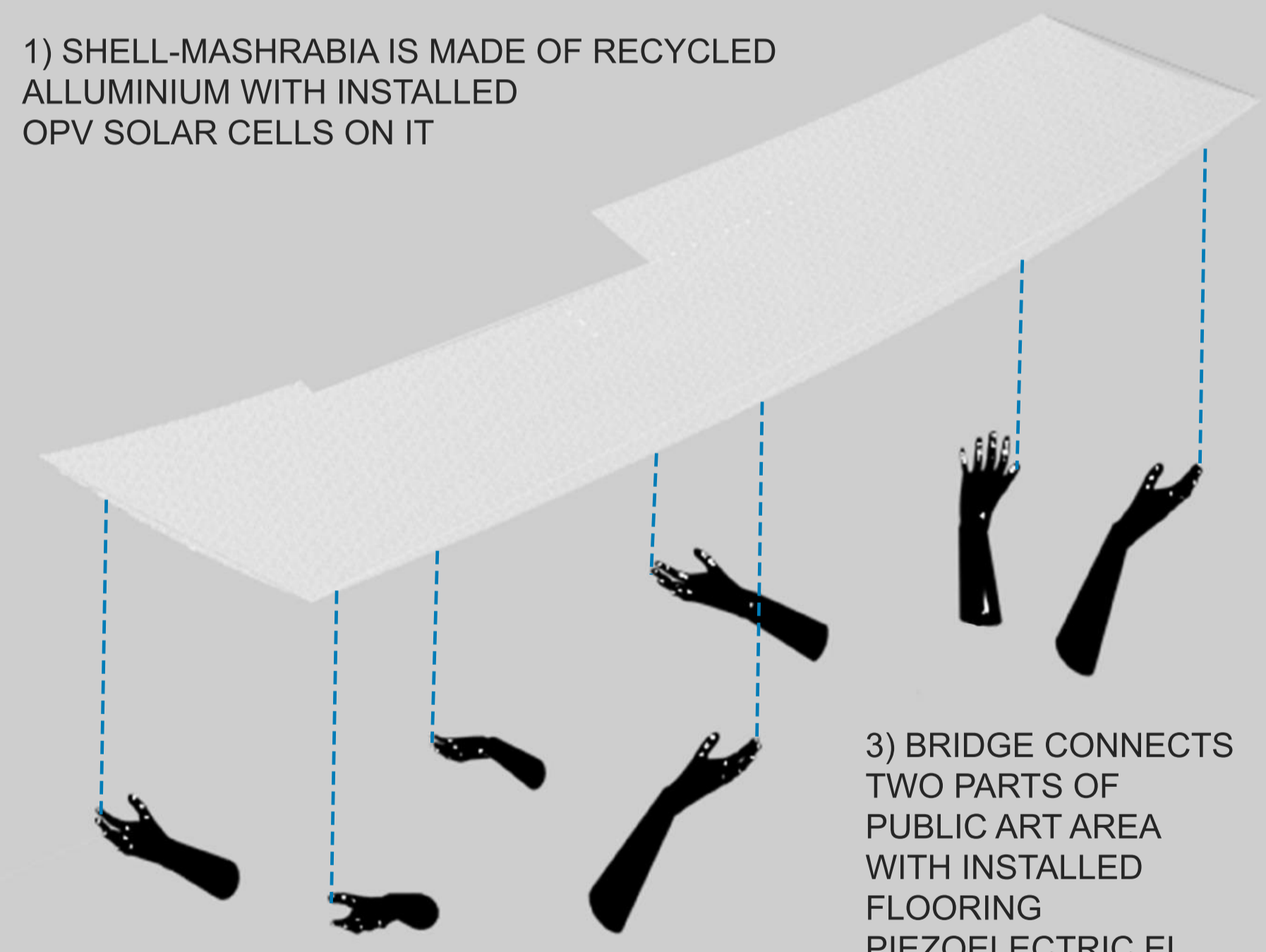

3) BRIDGE CONNECTS TWO PARTS OF PUBLIC ART AREA WITH INSTALLED FLOORING PIEZOELECTRIC ELEMENT ON IT

2) RECYCLED METALL HANDS SERV AS A SUPPORT FOR SHELL-MASHRABIA AS WELL AS AN ENERGY STORAGE

4) DIFFERENT TYPES OF SPACES ARE PROVIDED IN UPLIFTING

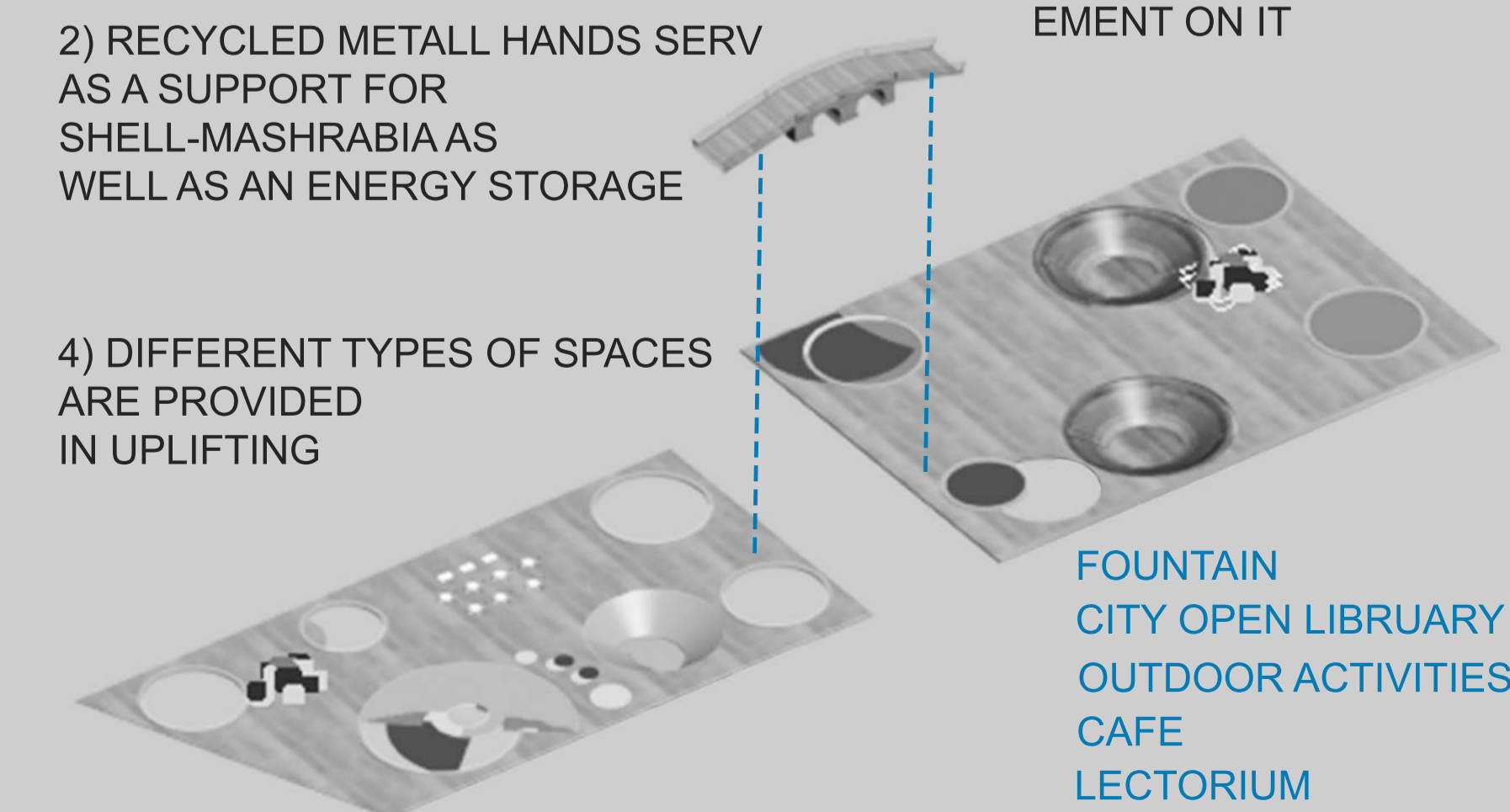

FOUNTAIN CITY OPEN LIBRARY
OUTDOOR ACTIVITIES
CAFE
LECTORIUM

TECHNOLOGY+ FUNCTION

FLOORING PIEZOELECTRIC ELEMENT THAT CONVERTS KINETIC ENERGY INTO ELECTRICITY

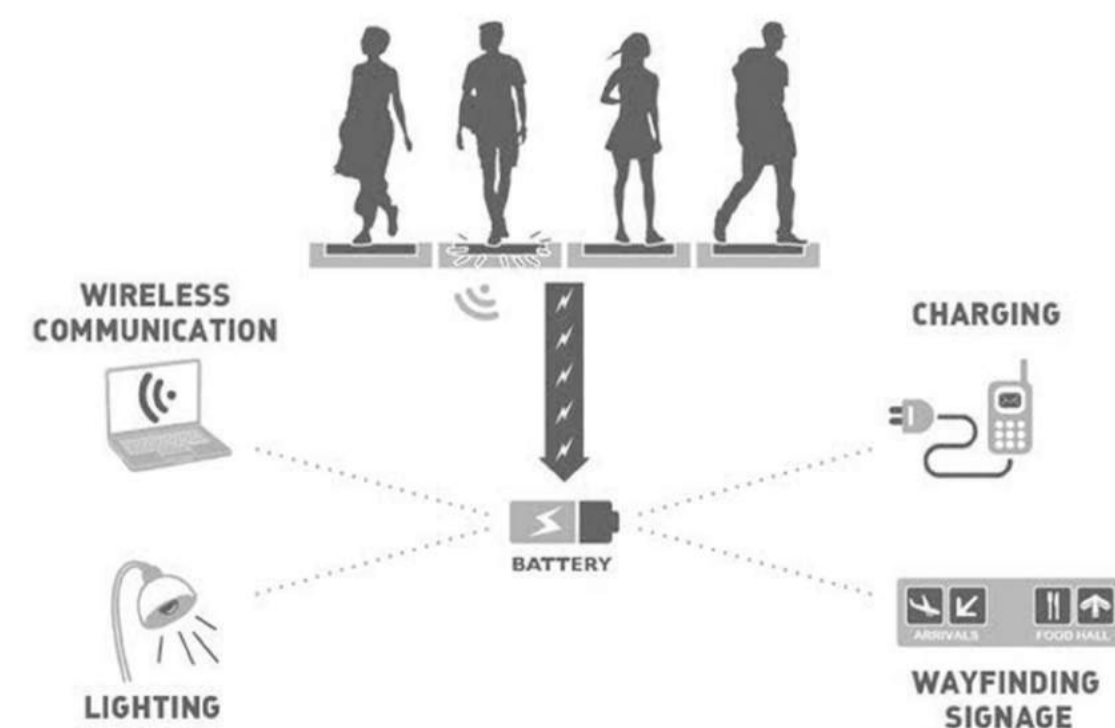

ORGANIC SOLAR CELLS EMBODIED TO THE SHELL-MASHRABIA

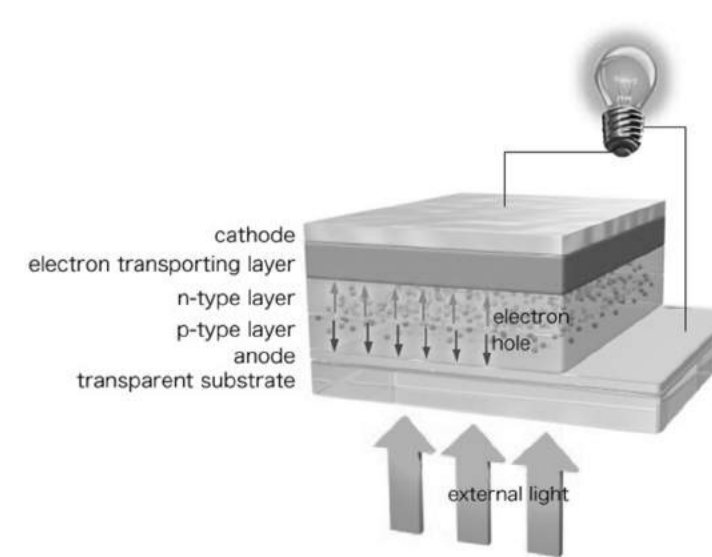

GROUND-WATER HEAT PUMP

Earth as a heat sink or source
Temperatures beyond 6 metres below ground surface remain constant through the year at 10-16 deg Celcius

