

# MASDAR TREES or Rain Forest

APROXIMATE ENERGY GENERATION  
CALCULATION BY THE MASDAR TREES.

Each tree has 150m<sup>2</sup> of solar cells populated on the surface.  
On average solar panel produces about 1000W/m<sup>2</sup>  
Thus the total of 13 Trees (1950m<sup>2</sup>) should generate 1950000W.

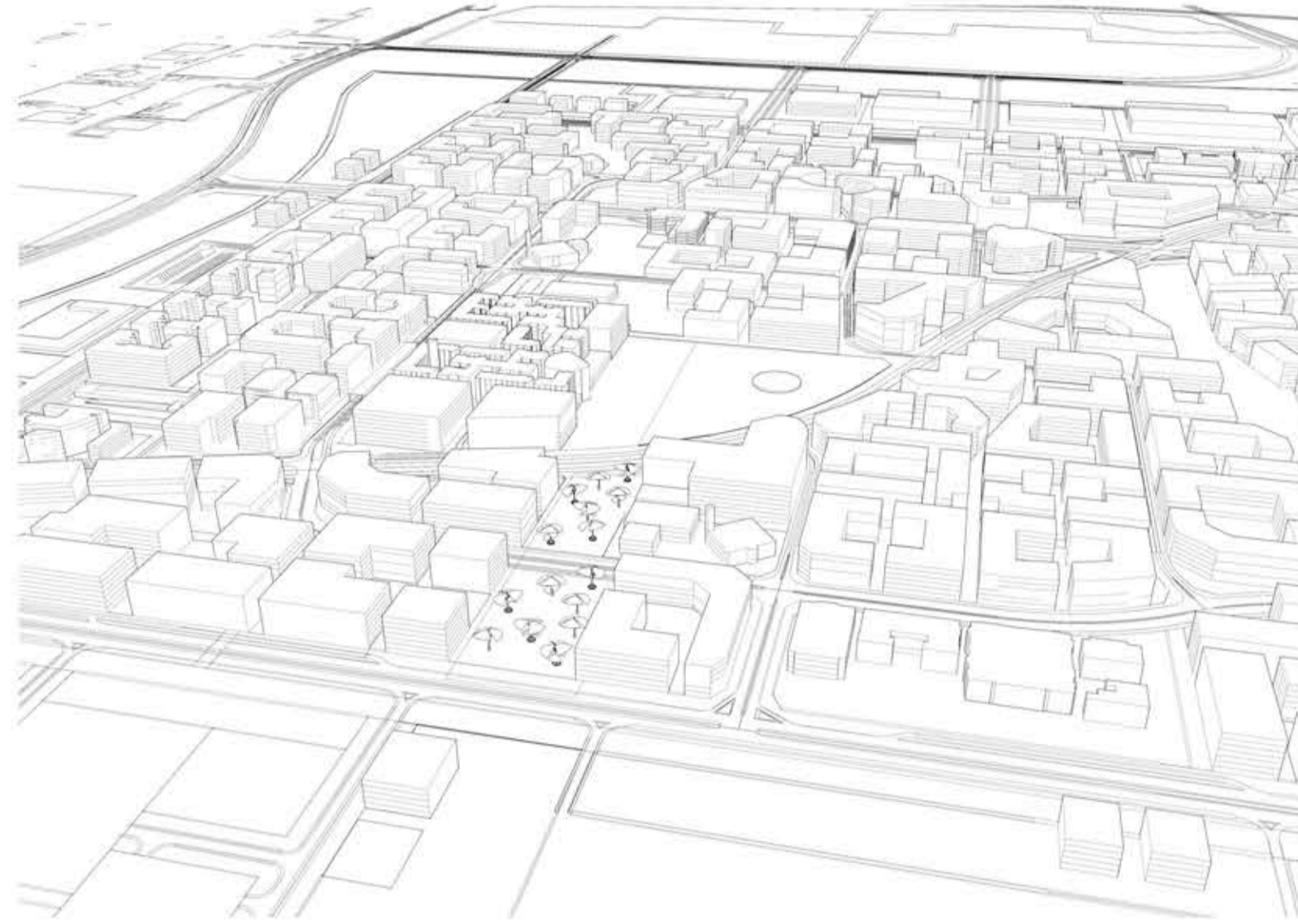

Different site views of the project

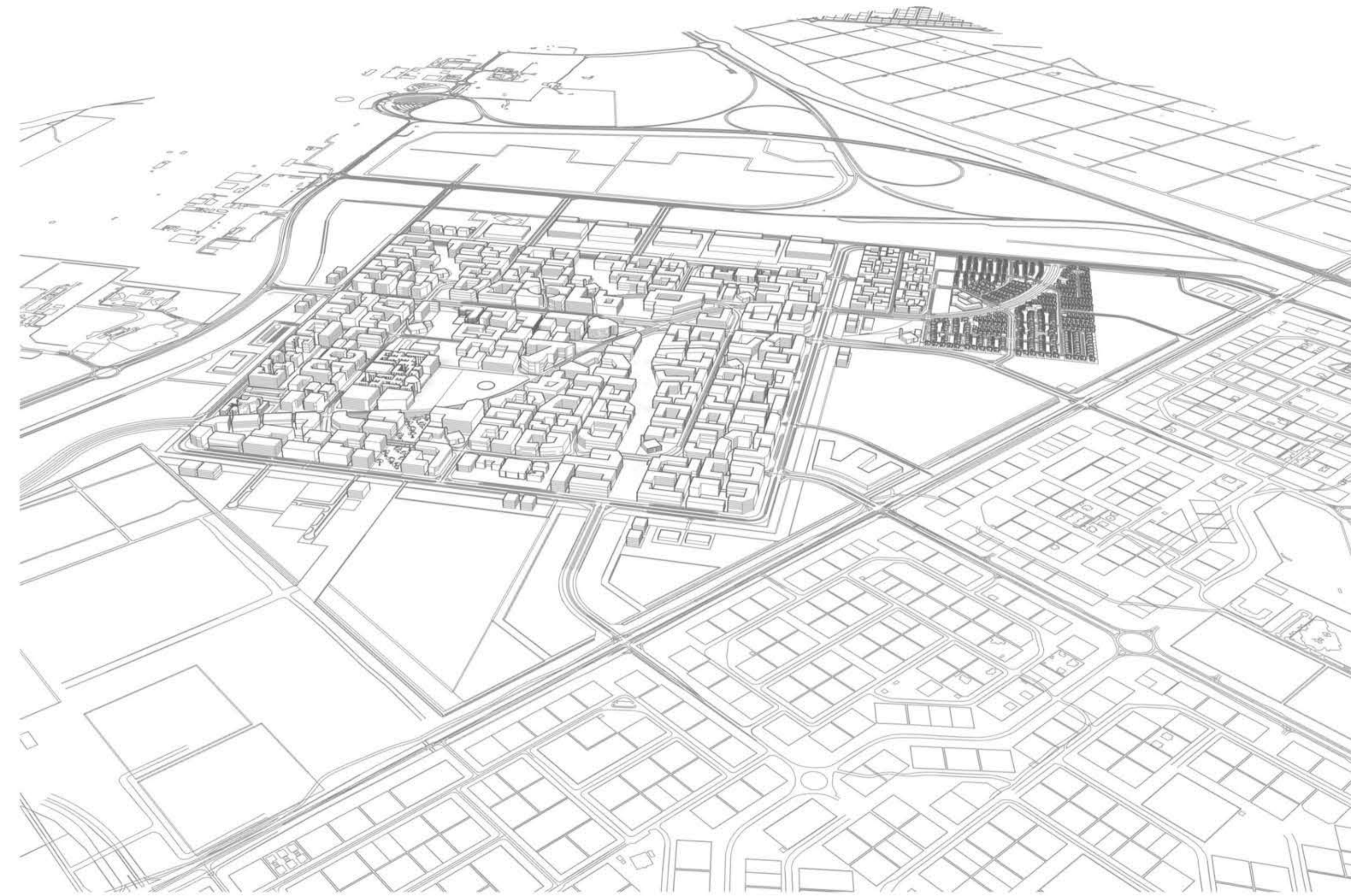
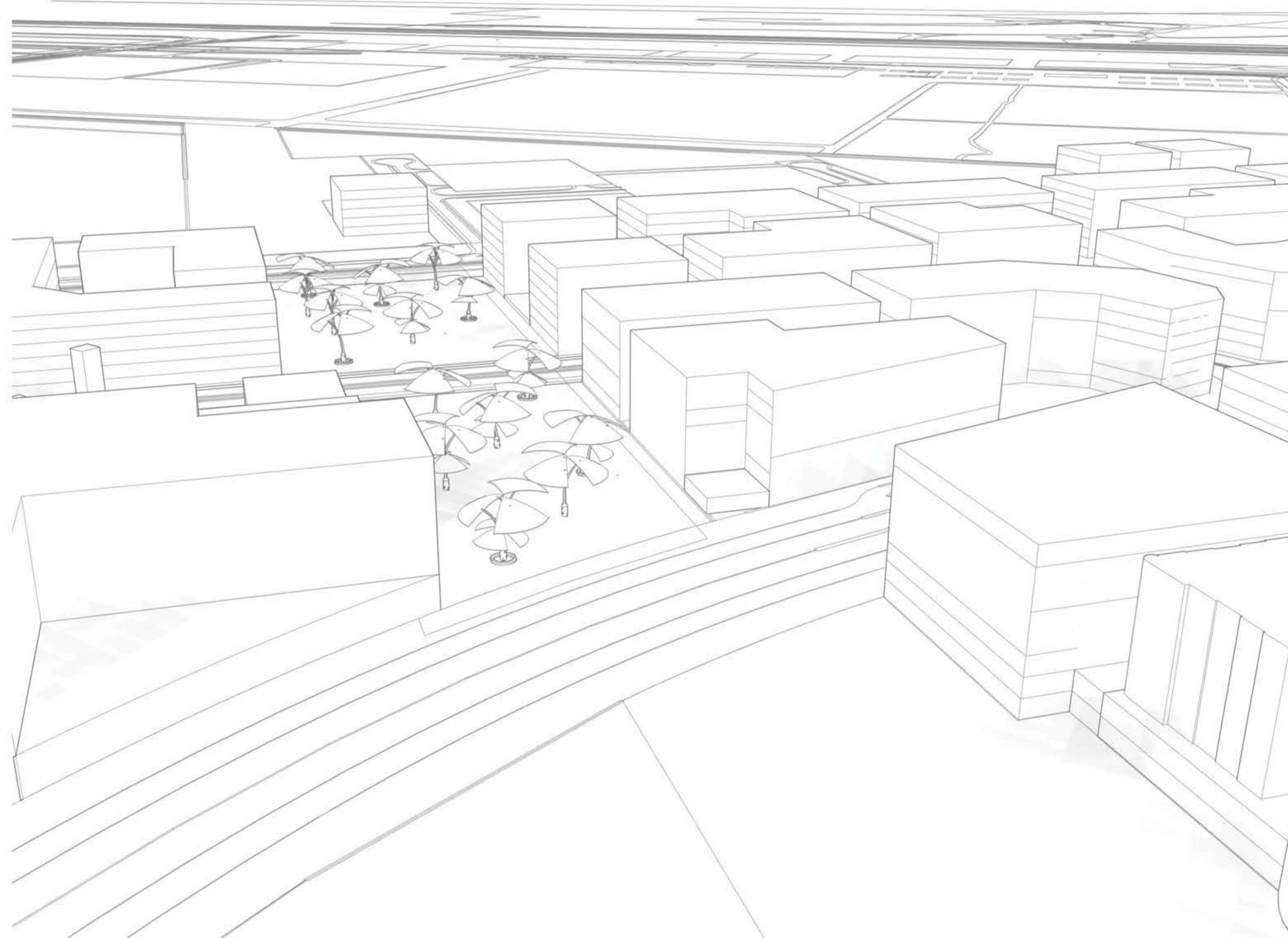

View of Masdar city with the embedded project

CREATING A CONCEPT THAT IS ENVIRONMENTAL , INNOVATIVE AND AT NO COST FOR THE PRODUCER WHEN ENERGY AND THE STARTING PRODUCT IS DRIVEN FROM SOURCES THAT ARE PRESENT IN ABUNDANCE.

WATER IS THE ESSENTIAL ELEMENT TO SURVIVE, HUMAN BEING IS MADE MOSTLY OF WATER, WATER CREATES LIFE. THUS THIS PROJECT CAN CREATE A SELF SUSTAINED OASIS ONCE THE SYSTEM IS INSTALLED IN PLACE.

THIS PROJECT IS NOT ONLY ABOUT CREATING INNOVATIVE ART BUT ALSO ABOUT CHANGING THE ENVIRONMENT AROUND IT INTO A BETTER AND MORE SUSTAINABLE HABITAT FOR TODAY AND FOR THE FUTURE.