

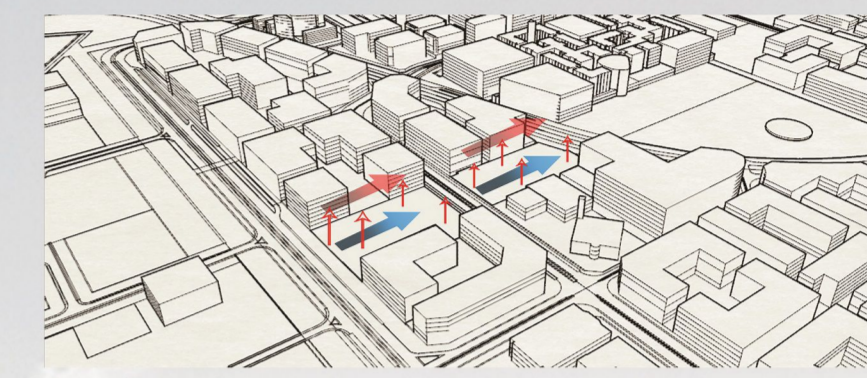

Site location

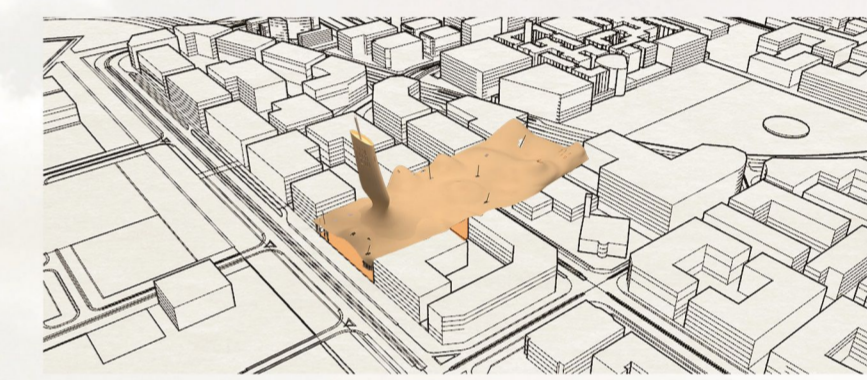

Benefitting from wind direction



Proposed design as a landmark



Defining different events

According to the amount and direction of and sunlight of the city, we aimed to generate pure electricity via thin-film photovoltaic panels installed on the windcatcher. In addition, wind turbines help us generate more clean power, so they were located in the entrance of the place, northwest of the site, where winds mostly directed.