



At the masterplan scale the artwork announces the ANTHROPOCENE to all those flying over, through the setting out of the PV array.



As we drop down closer, we see that watching over the ANTHROPOCENE is the SENTINEL, a 20-metre-high canary.



*"The Garden of Eden is no more.  
We have changed the world so much that we  
are in a new geological age:  
the Anthropocene, the age of humans."*

At ground level, the structures supporting the ANTHROPOCENE PV array appear as topiary above a series of constructed wetlands within a park, the SENTINEL becomes the focal point.

The project comprises of three key parts:

- 575kWp photovoltaic (PV) array;
- 3,475m<sup>2</sup> ecological wastewater treatment system;
- 4.6MWh/year biogas facility.

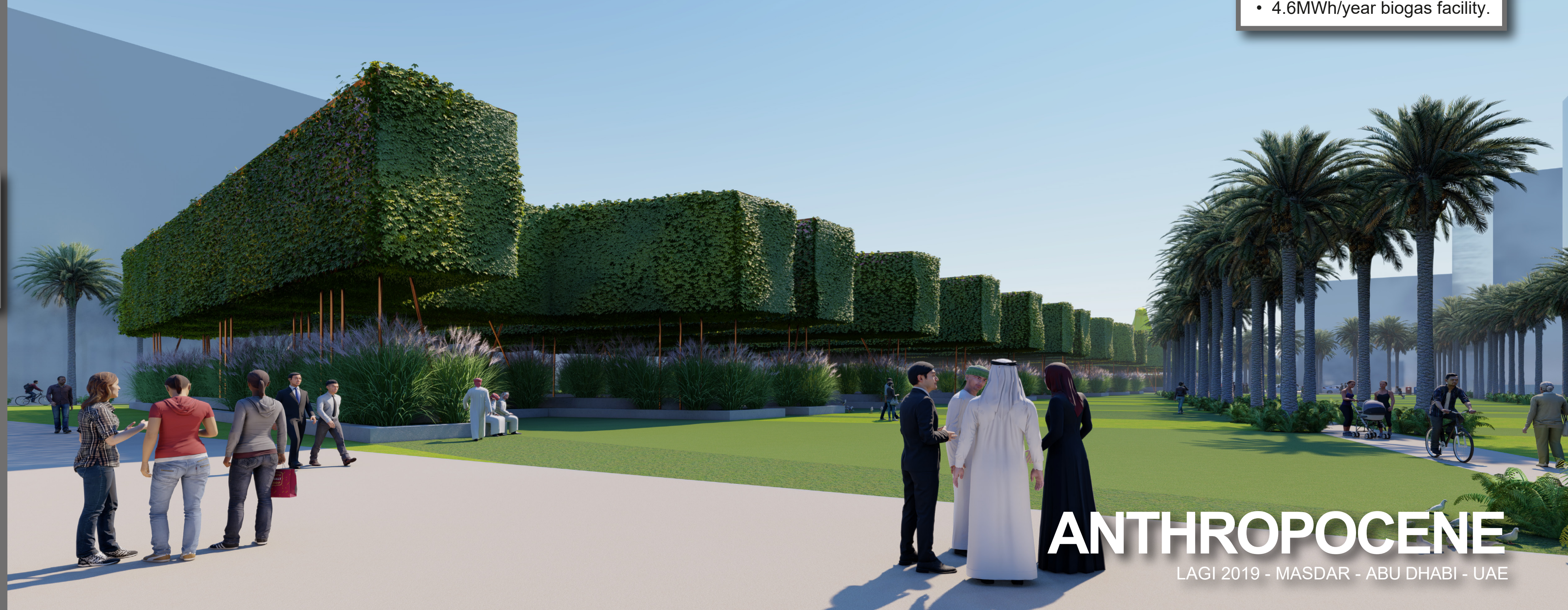

**ANTHROPOCENE**

LAGI 2019 - MASDAR - ABU DHABI - UAE