

عبرنا

الربيع STRUCTURE

الربيع MATERIALS USED

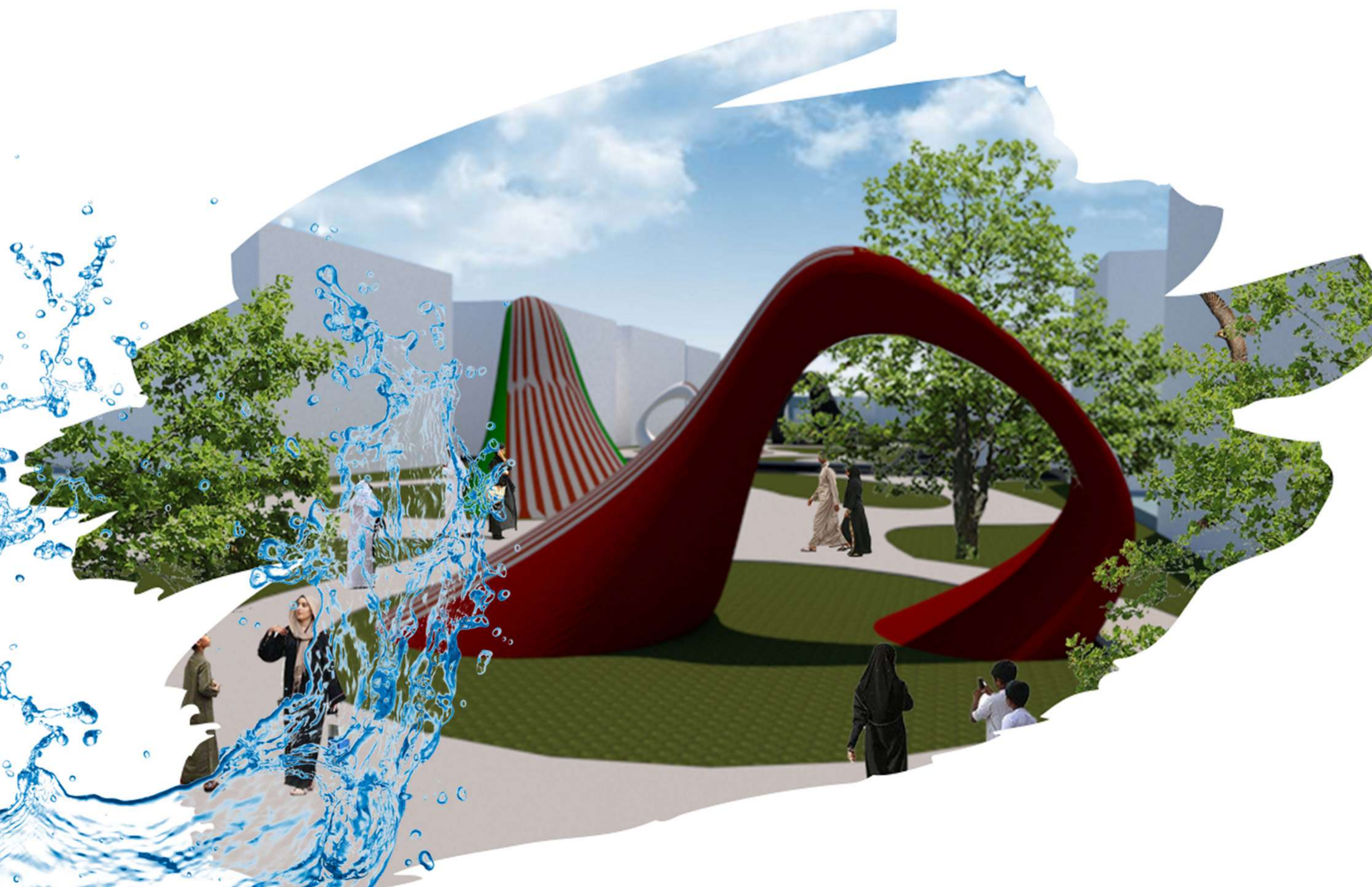
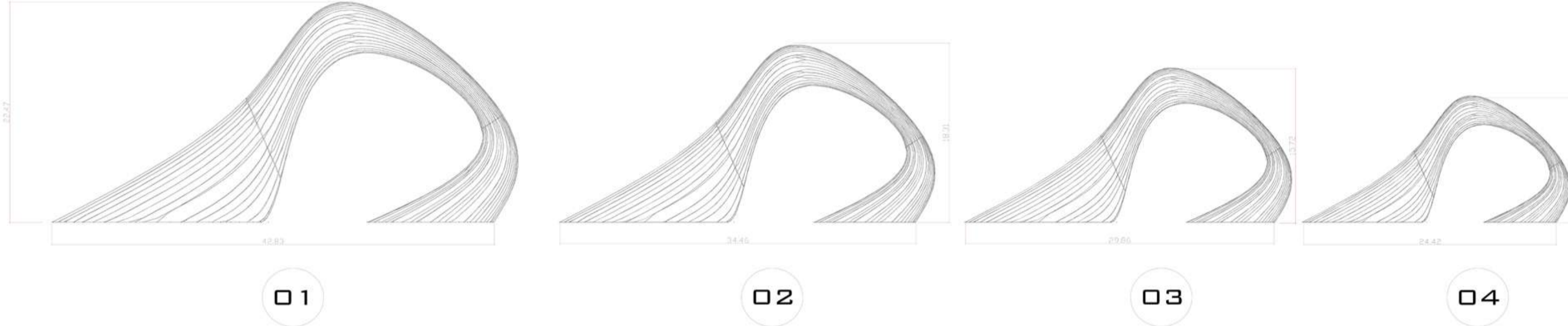

MATERIALS PHOTOVOLTAIC USES ORGANIC (OPV)

An organic solar cell is a type of polymer solar cell that uses organic electronics, a branch of electronics that deals with conductive organic polymers or small organic molecules, for light absorption and charge transport for the production of electricity from light solar photovoltaic effect. The organic polymer solar cell was designed many years ago as a flexible, low cost photovoltaic technology made using printing processes, simple machines and abundant materials.

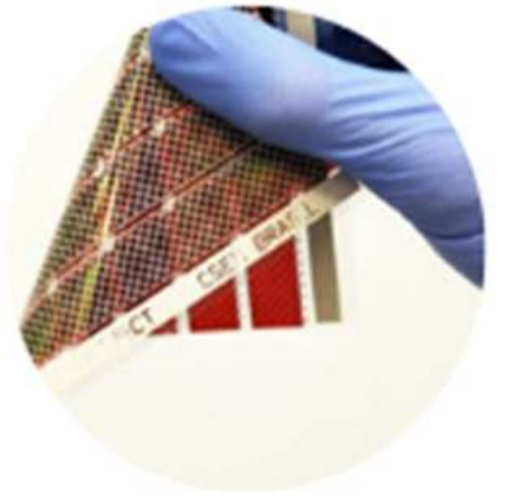

COGREENS

The EcoPiso is a floor that generates electric energy through the movement on its surface. The mechanism of energy generation is similar to that of EcoPista, but its concept and mode of use are different. EcoPiso has low energy consumption because it has low illumination, increasing its efficiency. It can be used under any weather conditions, being able to withstand rain, sun and excessive loads such as buses and other large vehicles.

EcoPiso is based on the concept of regenerative energy, where we can transform the wasted energy of our movement into electricity for our own use. In places of great movement of people a lot of energy is wasted, taking advantage of these small impulses of energy is a great step to decentralize the demand of electric energy.



WHITE CEMENT

The white color is obtained from raw materials with low iron oxide and manganese contents, under special conditions during the manufacture. To be considered a white cement, the whiteness index should be greater than 78%.



SPACE METALLIC STRUCTURE

The space metal structure consists of a set of steel or aluminum elements with high tensile strength, creating a resistant cover of high structural efficiency.

The space metal structure is provided with bars and nodes that support loads and have the capacity to distribute them in their extension, providing total safety to the project. The whole structure of the metal does not deform and maintains the whole solid structural set, highly resistant, that is, it presents / displays high engineering technology that eliminates effects of eccentricities that can present structural deformations.



CORIAN

Corian® is a synthetic material for solid surfaces developed by Dupont™. It consists of 1/3 acrylic resin (PMMA) and 2/3 aluminum hydroxide (aluminum trihydrate).

