



Suspended Gardens

Our proposal is based on the indigenous urban design and traditional architecture of the region. Suspended Gardens is a solution for a society that is built on social and environmental connection with the main principal of using natural resources. New technologies and innovative ideas are added to further complete the original design. In Abu Dhabi and many other cities the principals of using the natural resources have been followed and resulted in a comfortable environment. These solutions are the best and most natural way of obtaining the comfort in social connections for the people in that region. They are offering efficiency while providing comfort. In Suspended Gardens, design strategies in terms of energy efficiency have been considered based on proper building form, material selection and orientation. With the idea of using natural energy and vernaculars and combining them with the new technologies we are showing how traditional architectural solutions can be advantageous in a climate responsive design. Preserving the identity and special characteristics of a place requires in-depth understanding of the natural systems in place and immersion into the time-tested cultural responses to that environment’s assets and liabilities.

Density



The study of the urban development for the region shows the least amount of energy waste using the vernacular principals in the design with use of wind passages and natural shading systems.

Typology

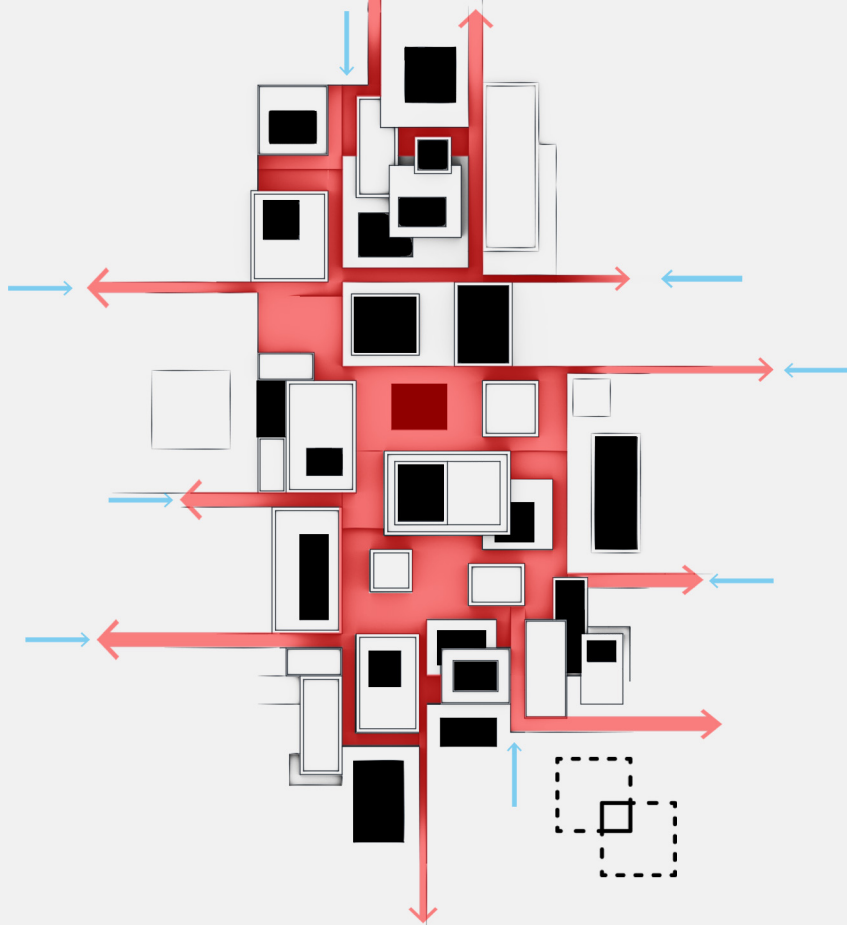

Use of courtyard housing typologies provided the means for wind currents to be directed to the shaded pathways

Abu Dhabi



The Bedouin of the Bani Yas tribe settled on the island of Abu Dhabi in 1761 mainly due to the availability of natural drinking water. At this time a haven for wildlife (Abu Dhabi literally means 'Father of the Gazelle'), the town expanded rapidly during the heyday of the pearl trade in the late 19th century.

Urban Typology Of Masdar

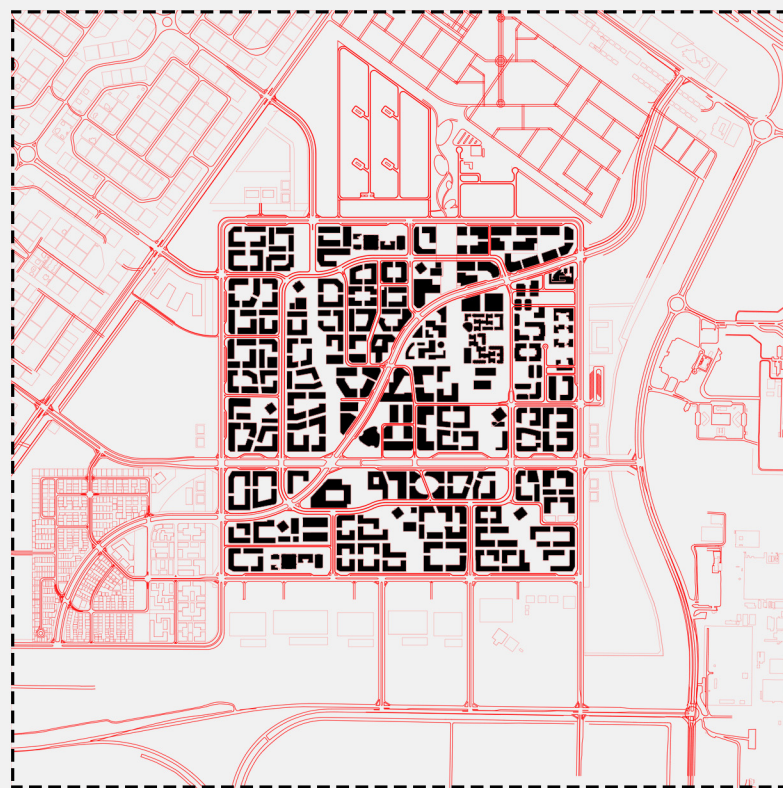

Courtyard housing typology is the characteristic of the city of Masdar. The urban planning follows the vernacular architecture principals.

Building typology in city of Masdar

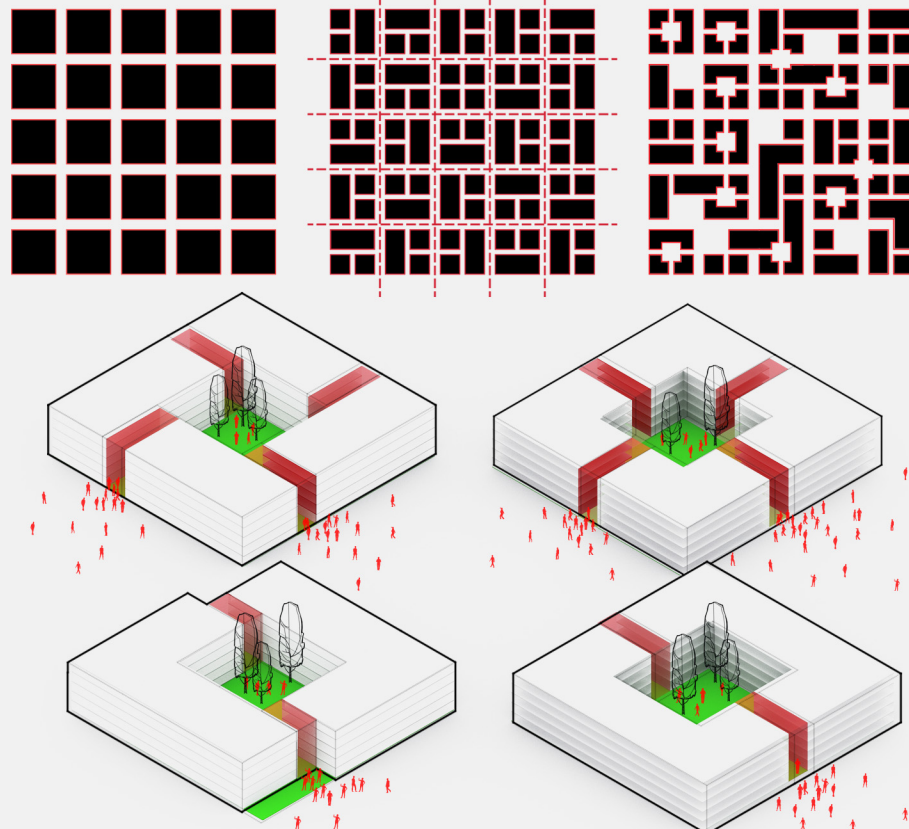

The urban development and design for the city of Masdar uses different arrangements of the courtyard typology