

Power pack
Energy storage

Solar & Wind
Energy Harvesting

Park

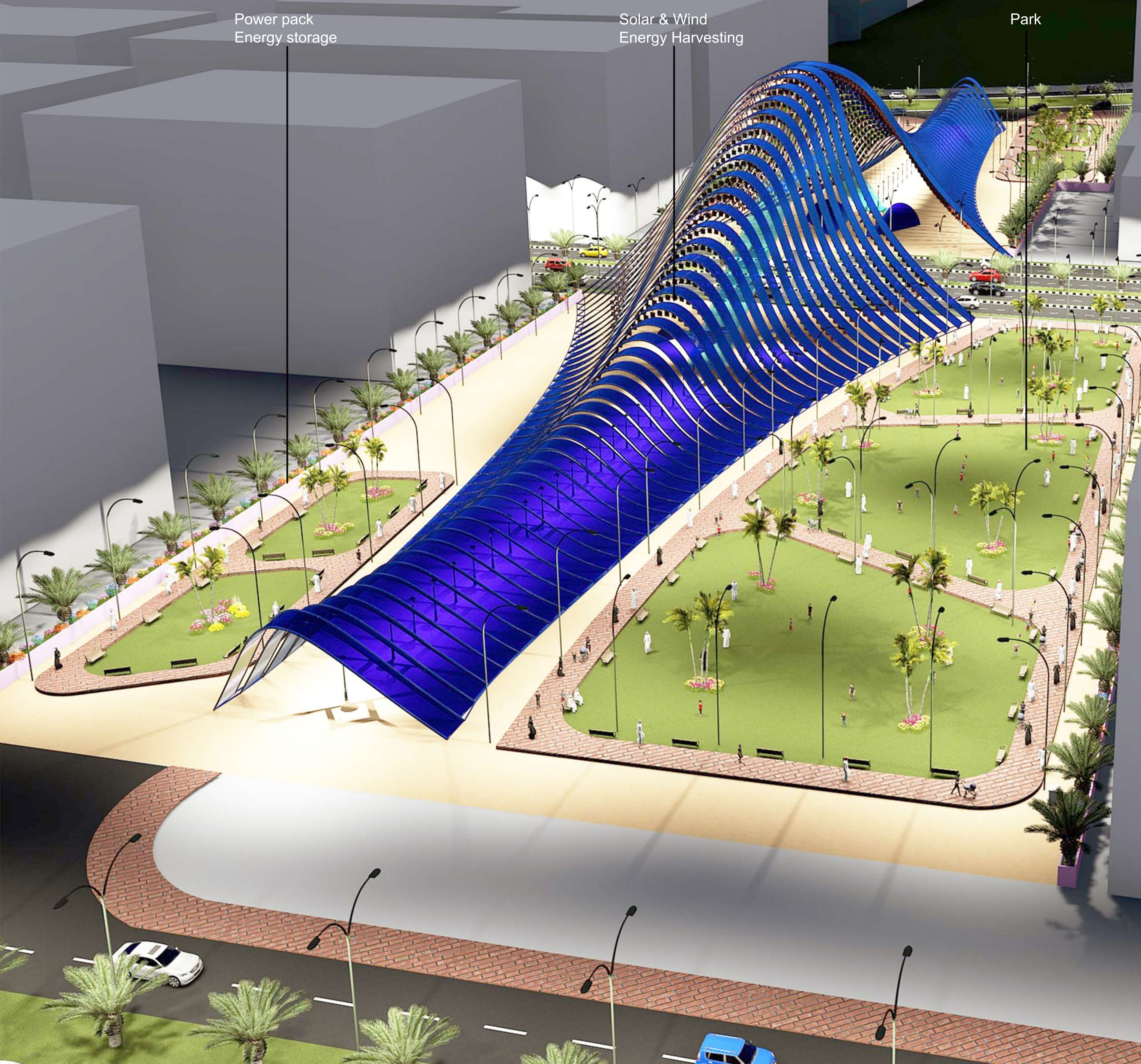

AHANA

AHANA is an Arabic name which means "Ray of Light". In this proposal, the energy generated from the rays of sun light and wind, can provide electricity in 2100+ households in masdar city. The scheme integrates solar (Ultra-light Next Generation PV Modules), Vertical Wind Turbine for energy harvesting and Tesla Power Pack battery storage seamlessly within the landscape of the given site.

CONCEPT

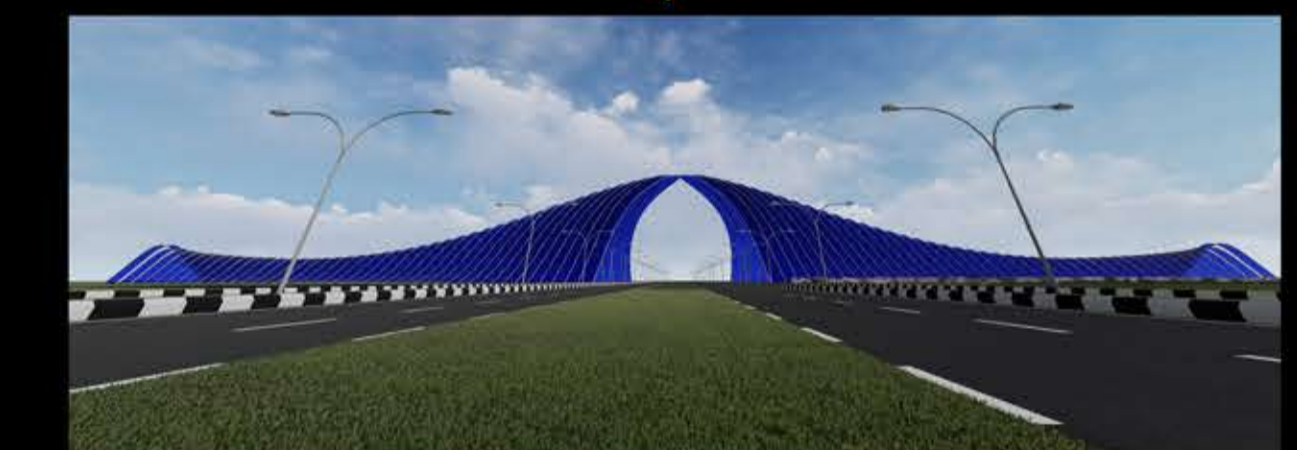
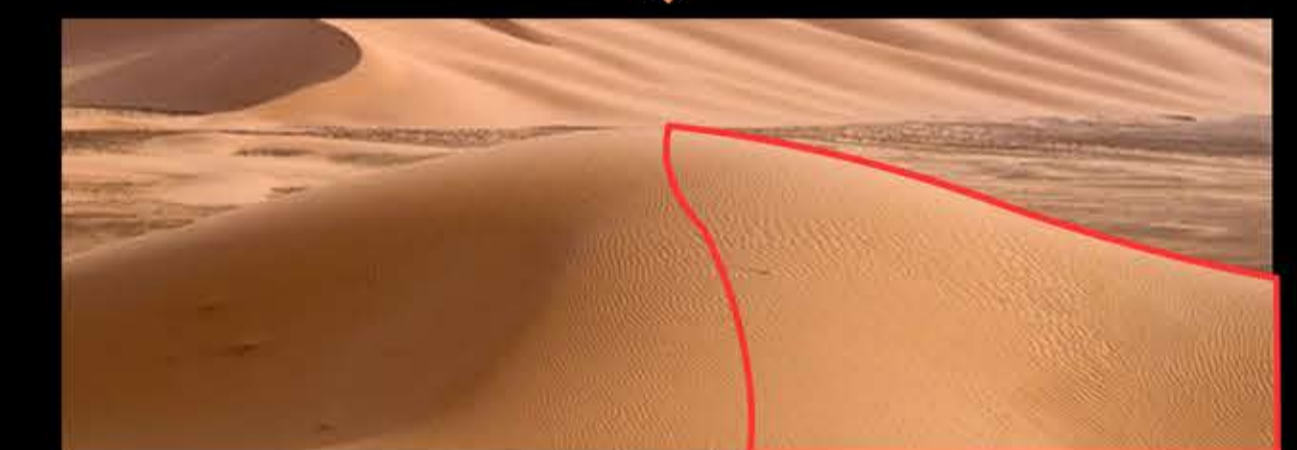

BIOMIMICRY is the practice of designing structure that simulate or imitate the processes that occur in nature. The goal is to create product, process in new ways of living that are well adapted to life on earth. In this structure we tried to mimic the curve of desert which reminds us playing with sand and its art, also the natural process of absorbing and releasing energy at night is mimicked by using solar panels and vertical wind turbine. In this the sun and wind are our natural heroes.

