

# The Solar Wind Veil of St. Kilda

The Lawn

Cultural Center

Forecourt

Courtyard

The Hill

Site Plan

The solar wind veil of St. Kilda is an energy generating open air pavilion that acts as a versatile framework for any activity or event that requires accommodation. It can also act as a sculptural art piece that engages the public on an individual level as well as in a group.

A Small Cultural center is imbeded into the slopes and creates a gradual transition from the most common entry point, The garage, To the Ground level Directly Below the Veils.

The St. Kilda Triangle is one of the last undeveloped sites in the area and a light touch upon the site with user-assigned program is what the city truly needs.

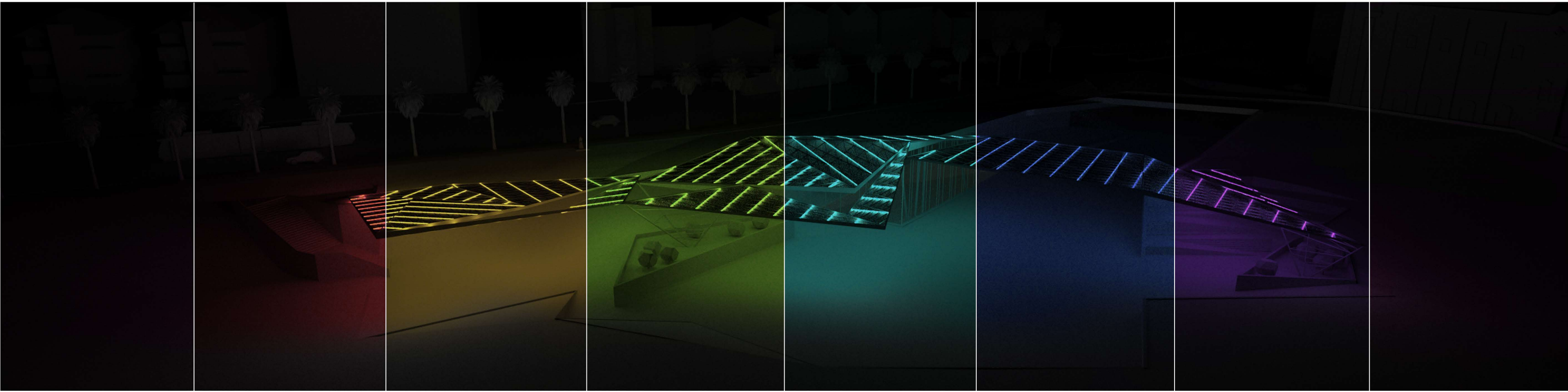

## Progressive LED Illumination

Although the main function of the veil is to harness the energy of the sun and the wind, The utilization of integrated LED lighting makes the process visible to the public by using this energy to show the ammount of energy collected for that day. RGB LED's allow for the colors to be preset for different holidays and events and create a piece of art out of the sculptural Architecture.