

The St. Kilda Cultural Beacon enhances and celebrates all that the community loves and values. It is the joint between the municipality and the community. With vast open public spaces, the community can freely occupy and rest as they come and go; while the architecture and the open floor plan brings opportunity for the mutation of the spaces. At one point the large doors can be left open to invite the community to celebrate an event; or the building can be more closed off to house a private gala or exhibit.

This multi-program cultural space adapts to the task at hand. This site is the host to large amounts of community members. The architecture reflects this idea in how it handles boundaries, edges and thresholds. With multiple large entrances and openings through the design, the experience of the cultural building is purely up to the occupant. The transition of spaces are blurred through seamless thresholds and secondary zones.

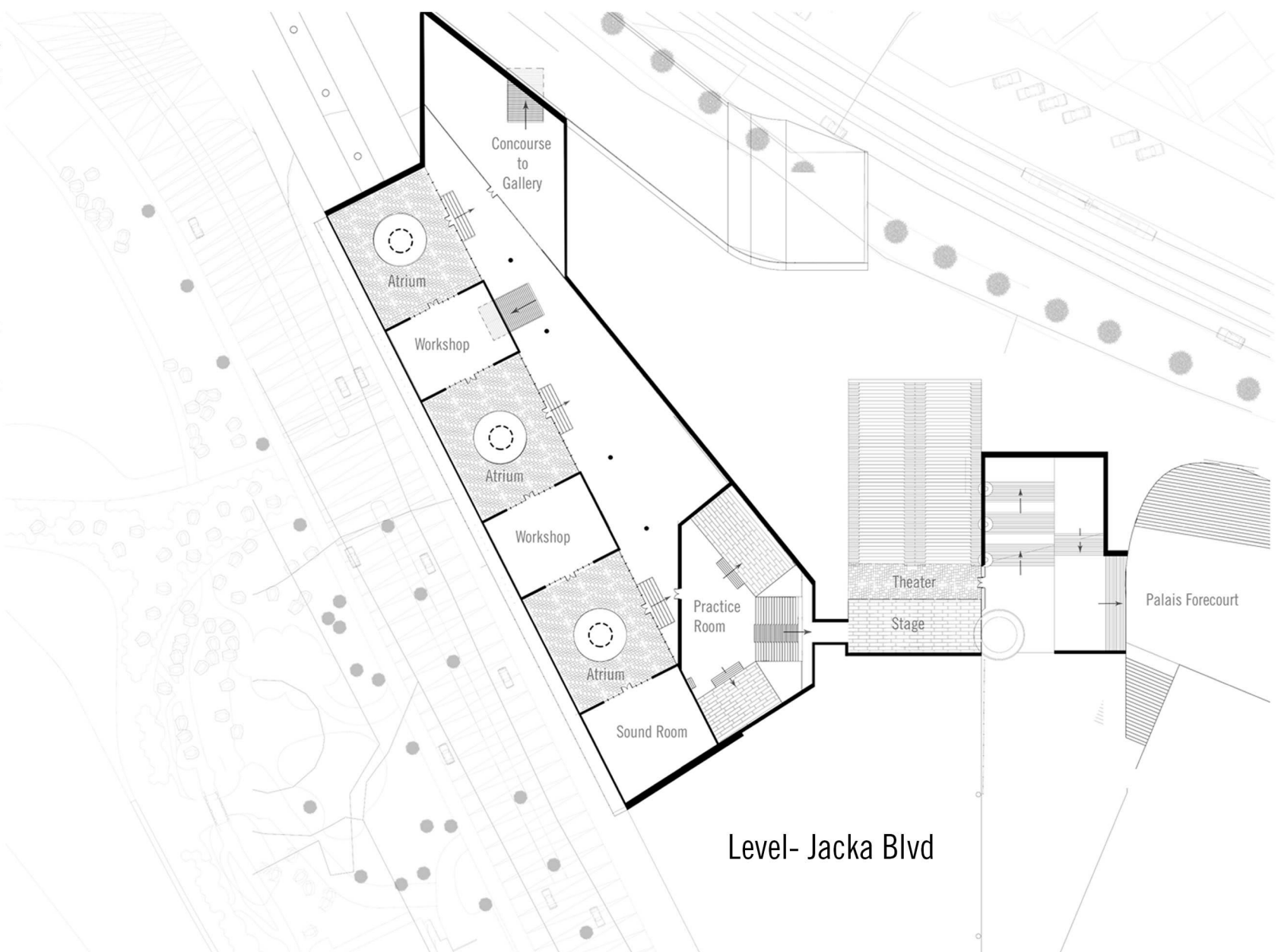

Level- Jacka Blvd

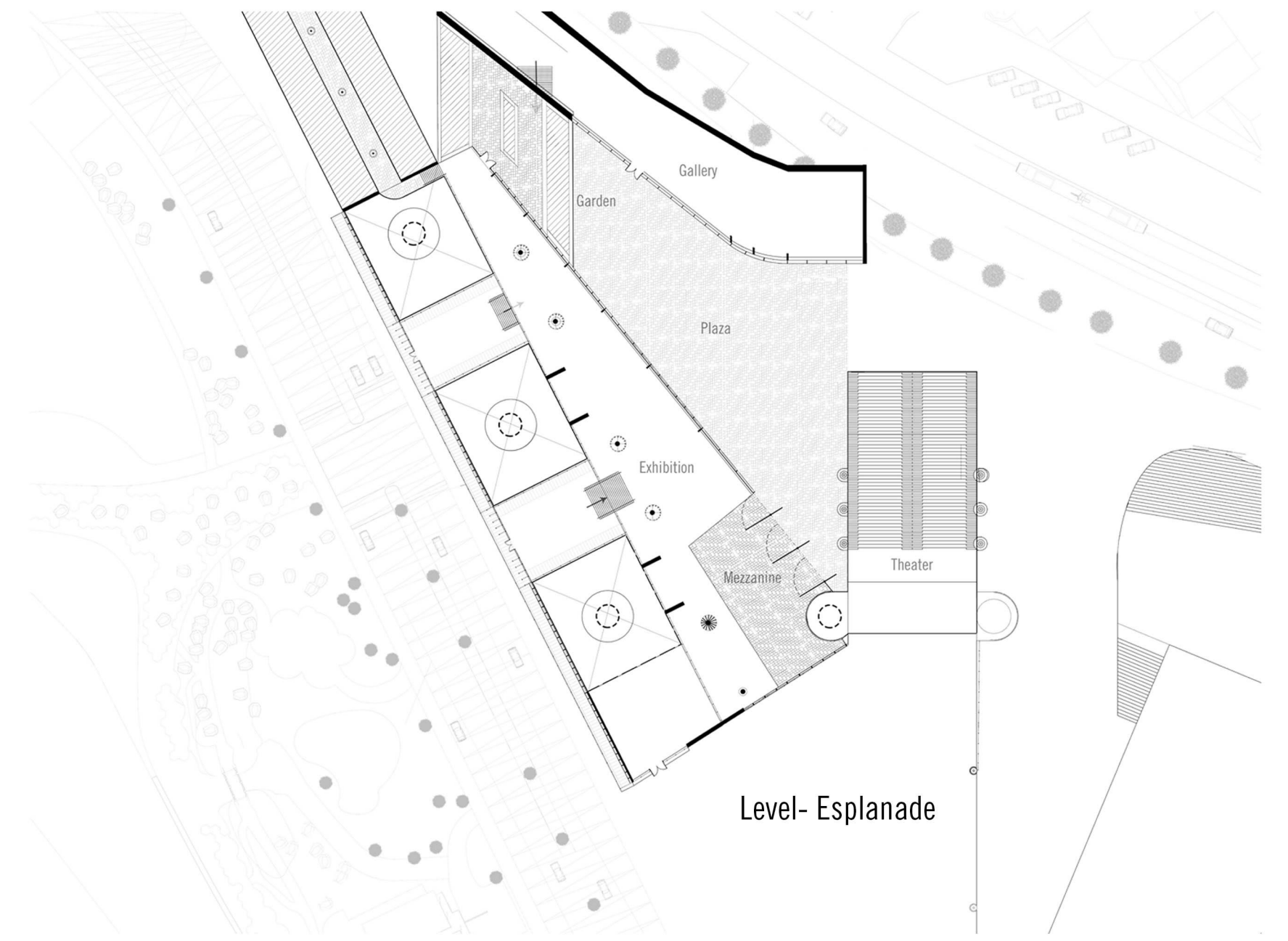

Level- Esplanade

